

Instruction Manual

HITACHI
Inspire the Next

Hitachi Air Purifier with Humidifying Function

Model

EP-A5000

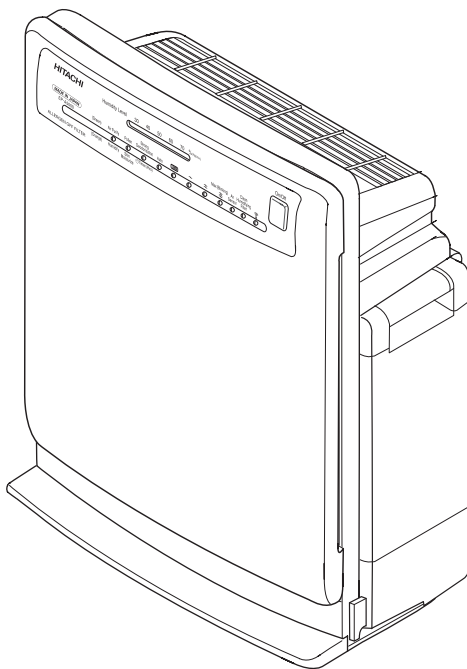

Thank you for purchasing a Hitachi air purifier.

This air purifier is for home use only. Do not use it for any other purpose than air purifying.

Please read this instruction manual carefully before use to ensure proper operation of the unit.

Keep this manual for future reference in an easily accessible place.

Read the "Safety Precautions" → P.E-4-E-6 to ensure proper use.

Contents

Before Use

● Features / Name of Each Component / Operation Buttons and Indicators / Accessories	E-2
● Safety Precautions	E-4
● Cautions on Use	E-7
● Preparations for Operation	E-8
· Setting Filter in Purifier	E-8
· Inserting Batteries into Remote Controller	E-8
· Filling Water Tank	E-9
● Installation	E-9

Operating Air Purifier

● Using Remote Controller	E-10
· Starting Operation	E-10
· Selecting Operation Mode	E-11
· Switching Airflow Rate	E-12
· Max Operation	E-13
· Using Timer	E-13
● Using the Control on Purifier	E-13
● Memory Function / Sensors / Auto Detection	E-14
· Memory Function · Air Sensor	E-14
· Odor Sensor · Humidity Sensor	E-14
· Auto Detection	E-14
· Adjusting Sensor Sensitivity Setting	E-15
● Useful Feature	E-16
· Eco Operation	E-16
· Dimmer Control	E-16

Cleaning and Maintenance

● Cleaning	E-17
· When the "Clean Humidifying Filter" Indicator Comes On	E-17
· Water Tank · Humidifying Filter	E-18
· Replacing Humidifying Filter	E-19
· Water Tray / Tray Cover	E-19
· Pre-filter	E-20
· Purifier Body	E-21
● Filter Replacement	E-21
· Replacement Interval · Precautions on Filter Handling	E-21
· Replacing the Filter	E-22
● Alert Display	E-22
● Troubleshooting Guide	E-23
● Replacement Parts	E-26
● Specifications	E-27

Features / Name of Each Component / Accessories

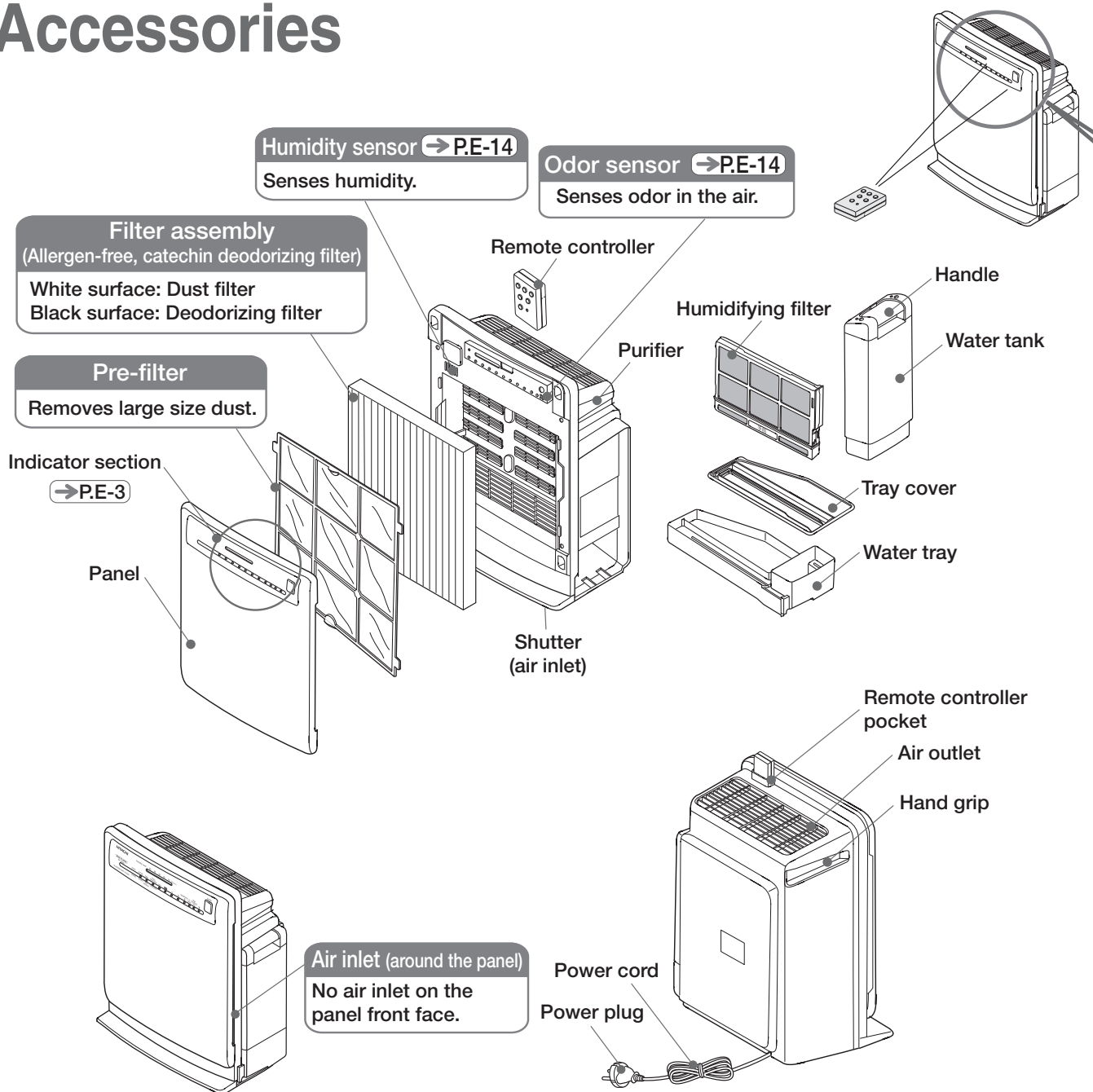

Provided Accessories

Filter

Housed inside the purifier.

* Be sure to remove this filter from plastic bag before operating the purifier.

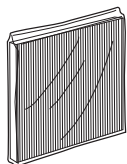

(x1)

Pre-filter

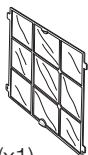

(x1)

Remote controller

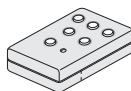

(x1)

"AAA" R03 batteries for remote controller

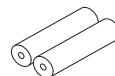

(x2)

Humidifying filter

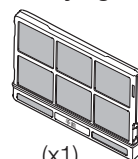

(x1)

Operation Buttons and Indicators /

■ → P.E-00 shows a page with further description.

Operation Buttons and Indicators

Humidity Level → P.E-10, E-14

Indicates approx. humidity level in the room during operation.

Low ← Moderate → High
Orange Orange Green Orange Orange

↓ ↓ ↓ ↓ ↓
30 40 50 60 70

Airflow Level → P.E-12

Indicates airflow rate during operation. (Indicator: Green)

Auto : Airflow rate during auto operation
ECO : Indicates eco operation is active.

When airflow rate is switched using the airflow button on the remote controller, the selected airflow rate is indicated.

• : Silent
•• : Med
••• : Strong or Max (blinking)

On/Off Button → P.E-13

Use this button to start or stop operation and to switch the operation mode.

Humidity Level 30 40 50 60 70 % (Approx.)

(Green) Air Purify Pollen Strong Deodorization Auto ECO ~ ~ Max(Blinking) Air Sensor Clean Humidifying Filter

(Orange) Humidify Skin Moisturize Timer(4hrs)

Operation Mode → P.E-11

Shows the operation mode.

- Air Purify, Pollen, Strong Deodorization
Indicator: Green
When strong deodorization and timer functions are used in combination, the indicator blinks in orange.
- Humidify, Skin Moisturize
Indicator: Orange

Timer → P.E-13

The indicator is lit when 4-hour timer is set. (Indicator: Orange)

Air Sensor → P.E-14

Level of air contamination detected by the odor sensor is shown by how the indicator is lit. (Indicator: Green)

Infrared Remote Receiver

Receives remote control signal.

Clean Humidifying Filter → P.E-17

Shows the time to clean the humidifying filter. (Indicator: Red)

Remote Controller

● Point the remote controller at the infrared receiver on the purifier when you operate.
● The remote controllable distance is approx. 6m maximum when pointing the remote controller squarely to the receiver.

On/Off Button → P.E-10

Press this button to start or stop operation.

eco Button → P.E-16

Press this button to start or stop eco operation.

Max button → P.E-13

Press this button to start max operation.

HITACHI
EPR-35

Mode Button → P.E-11

Press this button to switch operation mode.

Timer Button → P.E-13

Press this button to set Off-timer.

Sensor Setting Button → P.E-15

Press this button to switch sensor sensitivity.

Airflow Button → P.E-12

Press this button to switch airflow rate.

Note

- The remote control may not work in a room where inverter lighting apparatus or electronic quick start lighting apparatus is used, or when the infrared receiver is exposed to direct sunlight.
- If you operate the remote controller not pointing straight to the front face of the purifier, the sensitivity will be reduced. Operate the controller from the place in front of the purifier whenever possible.

Safety Precautions

● Please read the following safety precautions carefully before using the air purifier. To prevent injury to the user or other people and property damage, the following instructions must be followed. Also read the precautions appearing in the text carefully to ensure proper use.

■ Definition of each indication

Incorrect operation due to ignoring instruction will cause harm or damage. The seriousness is classified by the following indications.



WARNING

This symbol indicates the possibility of death or serious injury.



CAUTION

This symbol indicates the possibility of injury or damage to property.

Meanings of Symbols



Indicates "warning or caution".



Indicates "prohibition".



Indicates a "must".



WARNING

To Prevent Fire, Electric Shock and Injury

AC Outlet, Power Plug and Power Cord



● Before cleaning and other maintenance, be sure to unplug the power cord from AC outlet, and never pull it out or insert it with wet hands. Otherwise, it may cause electric shock or injury.

● Be sure to hold the plug, not the power cord, when unplugging it from AC outlet. It may cause electric shock or short-circuit, resulting in a fire.

● Be sure to unplug the power cord from AC outlet when leaving air purifier unused for an extended period of time. Also drain the water tank and water tray. Otherwise, it may cause electric shock, fire or unpleasant odor.

● Securely insert the power plug into AC outlet. Otherwise, it may cause electric shock, fire, smoke emission and ignition.

● Remove dust of the power plug periodically using a dry cloth. Otherwise, it may cause a fire.

● When you notice anything abnormal (water leakage, burnt odor, etc.) stop the operation and unplug the power cord. It may cause electric shock or fire due to ground leak or short-circuit.

● In the event of damaged power cord, it must be replaced by the manufacturer or its representative or equivalent qualified personnel to avoid the risk.



● Do not use with a voltage other than 220-240V AC. Otherwise, it may cause a fire or electric shock.

● Do not damage the power cord.
(Do not break, modify, forcibly bend, pull or twist it. Also do not place any heavy object on it or pinch it.)

Otherwise, it may cause a fire or electric shock.

● Do not use damaged power cord or power plug, or loose socket.

Otherwise, it may cause electric shock, short-circuit or ignition.

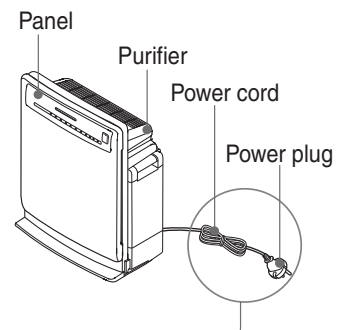
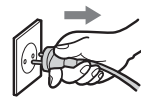

WARNING

Water Tank, Water Tray and Humidifying Filter



- **Do not operate the unit without setting any of the water tank, water tray and humidifying filter in place.**
Otherwise, it may cause injury or unit failure.
- **Do not use any detergent (neither kitchen nor laundry use) when cleaning the water tank or water tray.**
Ingredients of detergent may cause damage and subsequent water leakage, or electric shock, injury or unit failure.
- **Do not carry the water tank by holding its handle.**
Dropping the tank may cause inadvertent injury or other accident.
- **Do not disassemble the tank cap.**
Otherwise, it may cause inadvertent accident such as small children swallowing it by mistake.

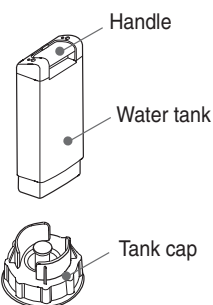

Place of Use



- **Do not use in a humid place such as in bathroom.**
It may cause electric shock or unit failure.
- **Do not place air purifier near a hot object such as a heater.**
It may cause unit failure or deformation.
- **Do not use in a place where soot of oil, such as machine oil, is floating in the air.**
It may cause a crack or fire.
- **Do not use air purifier in a kitchen as a substitute of ventilating fan.**
It may cause a unit failure.
- **Do not use in a place where any organic solvent or chemicals are used.**
It may cause a discoloration, deformation or fire.
- **Do not use the air purifier in a place where a machine tool such as a grinder and welder that produces sparks such as flammable dust is installed.**
Sparks may cause fire.

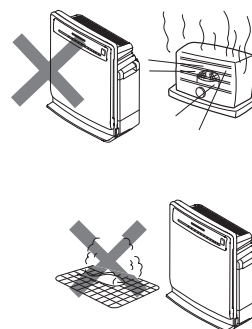

Purifier Body and Panel



- **Do not use benzene or thinner when wiping or spray flammable gas such as insecticides.**

It may cause a crack, electric shock, catching of fire and explosion.

- **Do not let air purifier intake inflammables, lit cigarettes or incense.**

It may cause a fire.

- **Securely hold the grip when carrying air purifier.**

Dropping it may cause injury or damage to it.

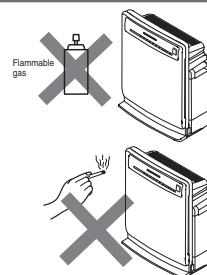

Miscellaneous



- **In case the unit becomes inoperative or anything abnormal such as smoke or unusual odor is noticed, immediately unplug the power cord to prevent possible accident and contact your dealer for check and repair.**

It may cause electric shock or fire due to ground leak or short-circuit.

- **Ventilate a room frequently if any heating appliance is simultaneously used with air purifier.**
Otherwise, it may cause carbon monoxide poisoning.

- **The appliance is not to be used by children or persons with reduced physical, sensory or mental capabilities, or lack of experience and knowledge, unless they have been given supervision or instruction.**

- **Children should be supervised to ensure that they do not play with the appliance.**

- **Never attempt to disassemble, modify or repair by yourself.**

It may cause a fire, electric shock or injury. (Contact your dealer for repair.)

- **Do not put your finger or any other object into air outlet and inlet.**

It may cause injury or unit failure.

- **Do not submerge or splash water on the unit. Also avoid filling water directly into the unit.**

It may cause electric shock or short-circuit.

- **Do not tilt or tip over the unit. Do not put your weight on the unit or step on it.**

It may cause tipping over of the unit and injury or water leakage.

- **Do not install in unstable place or anywhere near infant child.**

It may cause tipping over of the unit and injury.

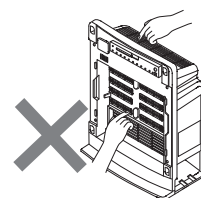
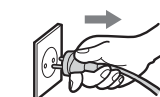

Safety Precautions (Continued)

CAUTION

Miscellaneous



- **Securely hold the grip when carrying air purifier.** Dropping it may cause injury.

- **When you attach or detach the panel and water tank, do it slowly and securely.** Otherwise, it may cause water leakage or injury of fingers pinched.

- **Use dry cell batteries properly after reading the precautions on them.**

- **Renew water in the water tank daily using tap water and clean the tank periodically according to the instructions given in the “Cleaning” section of this manual.**

Continued use without cleaning may allow propagation of molds or bacteria due to dirt and water scale, producing unpleasant odor. In rare cases, they may cause a health risk to those who are hyperactive. In such a case, please seek medical advice.

- **Only use fresh tap water**

Otherwise, it may cause deformation or degeneration of parts, unit failure or unpleasant smell due to propagation of molds or bacteria. Do not use hot water (over 40°C), water through water purifier, alkali ion water, mineral water, well water or the like. Do not put organic solvent or chemicals into the water tank.

- **Do not drink, or let drink, water in the water tank and water tray.**

It may cause a health threat.

- **Do not leave the detached water tank with its cap closed.**

Inner pressure of the tank changes according to ambient temperature change and may cause water leakage or injury due to deformation or damage.

- **Use a genuine filter for the Hitachi Air Purifier.**

Other filters may cause unit failure.



- **Do not operate the unit when using fumigating (smoking) type insecticide.**

Using such insecticide will cause chemicals to accumulate in the unit and to be emitted by subsequent operation, which can be harmful to health.

After using insecticide, ventilate the room well before running the purifier.

- **Do not allow water to freeze.**

Water tank may be damaged, causing a risk of electric shock and unit failure. Whenever freezing of water is anticipated, drain the water tank and water tray.

- **Do not use the purifier having water leakage trouble.**

It may cause electric shock. When water leaks, unplug the power cord from AC outlet and ask for repair.

- **Do not carry the purifier with its water tank filled.**

- It may cause water leakage or injury.
- If you carry the purifier with filled water tank, level of water in the tray will rise and cause the water to overflow when operated.
- Drain the water tank and water tray first, and set them on the unit before carrying.

- **Do not tip over or drop the water tank when it is filled.**

It may cause injury or result in deformed or damaged tank. Hold the tank securely when you fill it with water.

- **Do not look into the indicator.**

It may cause injury to your eyes.



To Prevent Floor Scratches or Wall Stains

During Cleaning / Place of Use



- **During cleaning, lay a soft cloth on the floor and place the purifier and detached components (panel, water tank, water tray, etc.) on it.**

Otherwise, it may cause scratches on the floor.

- **When you pull out the water tray, be careful not to scratch the floor with bottom of the tray.**



- **Do not use the air purifier near the wall that cannot be scrubbed such as cloth-covered white wall.**

The air purifier will take in the surrounding air and may produce local stains.

Cautions on Use

Do not install in an unstable or sloped place, or near any obstacles.

The unit may fall or drop, resulting in damage or unit failure. If the space between the unit and floor remains humid, the floor may get moldy. Using the unit tilted may cause water leakage.

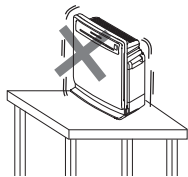

Do not directly fan animals and plants.

Air drafts may adversely affect them.

Do not place anything on the air purifier body, and do not block the air inlet or air outlet.

Acts of the sort may cause unit failure.

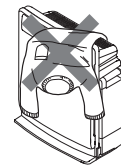

Do not drag the unit on any floor susceptible to scratches or on thick carpet.

It may cause damage on floor or carpet surface.

Do not run with filter detached.

No cleaning effect is obtainable without filter. Running without filter may also cause unit failure.

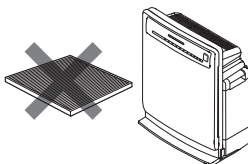

Do not block or touch the infrared receiver, odor sensor or humidity sensor.

- Infrared receiver may be stained or damaged to reduce its sensitivity.
- Sensors may be degraded in their sensitivity.

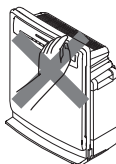

Do not touch or move the unit (angle or lift the unit) during operation.

Moving the operating unit may cause the fan to contact the inner case, resulting in noise and possibly unit failure.

Do not place the purifier in a place exposed to direct sunlight.

Direct sunlight may cause deformation, discoloration or malfunction.

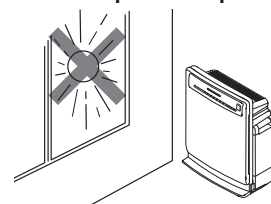

Do not subject remote controller to impact.

Do not drop the remote controller or step on it, and do not place any object on it. Doing so may cause unit failure.

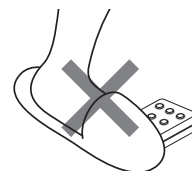

Do not install in a place where the air from the purifier will blow directly on furniture, electric appliance, wall or ceiling.

Humid air may cause stain or deformation of furniture, or may cause unit failure.

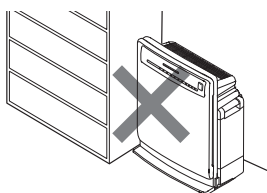

Do not subject water tank to impact.

Water may leak from the tank to wet the floor. Also water may drip from the tank cap to wet the floor.

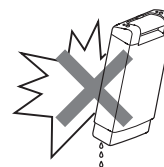

Ventilate closed room occasionally.

The air purifier does not have a ventilation effect.

- *The air purifier cannot remove hazardous substance in cigarettes (carbon monoxide, etc.).

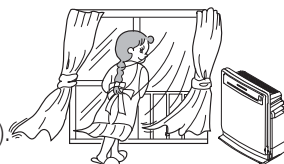

Do not use near television or radio.

Broadcast may be interfered. Install the air purifier 2m or more away from such devices.

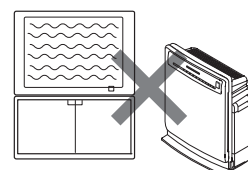

Preparations for Operation



CAUTION

- Lay a soft cloth or the like beneath the purifier to protect the floor against scratch.
- No cleaning effect is obtainable if the filter is installed with plastic bag. It may also be a cause of malfunction.
- Do not tip over or tilt the purifier.

Setting Filter in Purifier (Perform the same procedure when replacing filter.)

1 Remove the panel.

- 1 Place the unit on a level, stable surface.
- 2 Hold the panel at both sides, pull it gently forward and then slightly upward, and remove it.
- 3 Remove the pre-filter.

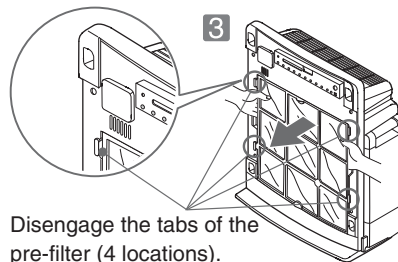
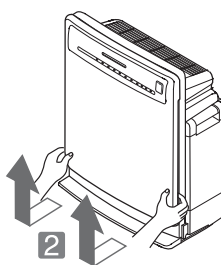

Disengage the tabs of the pre-filter (4 locations).

2 Remove the filter.

- 1 Remove the filter packed in a plastic bag from inside the unit.
- 2 Take the filter out of a plastic bag.
- 3 Remove the packing.

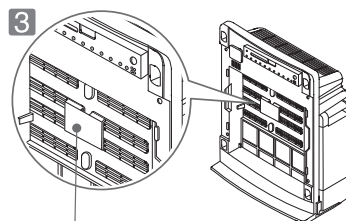

Be sure to remove the packing.

3 Install the filter.

- 1 Install the filter on the unit.
 - Install the filter so that the arrow "↓ FRONT" on the filter side face will face the panel.
- 2 Install the pre-filter.

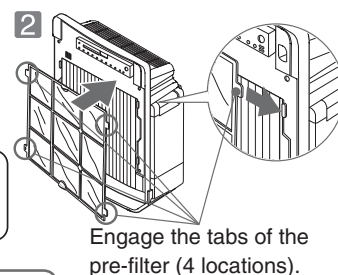
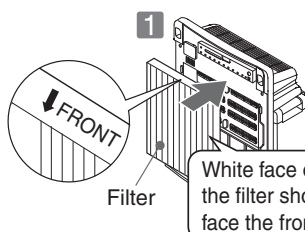

Engage the tabs of the pre-filter (4 locations).

Note

- Be sure to take out the filter from a plastic bag.
- Do not block the filter front face with cloth or paper.

4 Reinstall the panel on the unit.

- 1 Insert the two tabs on top of the panel into the two holes on the unit.
- 2 Gently push bottom of the panel until it clicks to close it securely.

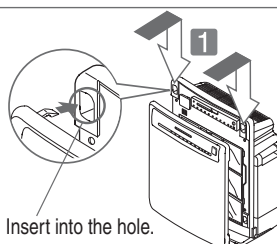

Insert into the hole.

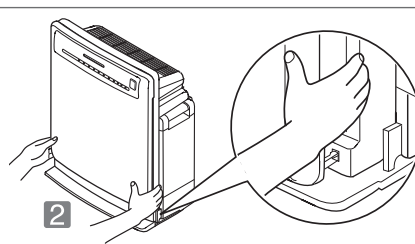

- To avoid having difficulty in installing the panel, do not push the panel with a single hand or do not push it anywhere except its bottom.

Inserting Batteries into Remote Controller

1 Remove the battery compartment cover.

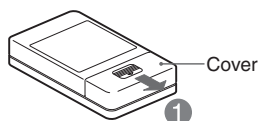

2 Insert batteries and close the cover.

- Insert the provided two "AAA" R03 batteries with the correct polarities as instructed.
- Since the batteries are provided when shipped from the factory, their lives may be shorter than brand-new ones because of self-discharge.
- Batteries are consumable
- When replacing batteries, replace the two batteries simultaneously.
- Only use two manganese batteries or two alkali batteries. Do not mix them.

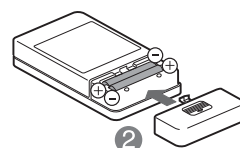

Filling Water Tank (for Humidify Mode and Skin Moisturize Modes)

1 Gently remove the water tank.

- 2 While pressing the upper part of the water tank handle, lift it obliquely upward, and remove the water tank by supporting it in the bottom.

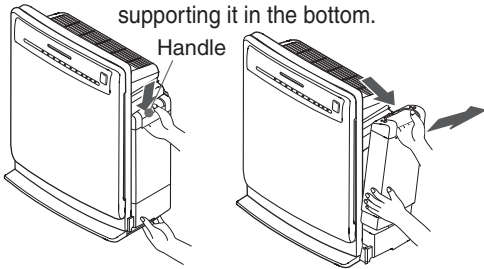

1 Hold the water tray.



- Do not carry the water tank by holding its handle. Instead, hold the tank with both hands and carry it while keeping the tank cap side up. When the water tank is wet, wipe off water drops before carrying.

2 Remove the tank cap and fill fresh tap water of normal temperature.

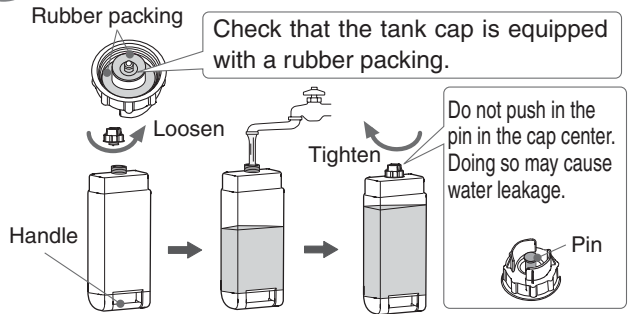

- Press the center pin of the tank cap, and check that it comes back by spring.
- Tighten the tank cap firmly, wipe off spilled water, and check that there is no water leakage.
- Wipe off water on the water tank handle if any.
- The tank cap is a consumable part. → P.E-26 (If it leaks water due to deteriorated rubber packing, please purchase separately available part for replacement.)

3 Pull out the water tray, check that the humidifying filter and tray cover are equipped, and then retract the tray.

- The humidifying filter absorbs water supplied from the water tank for humidifying operation.

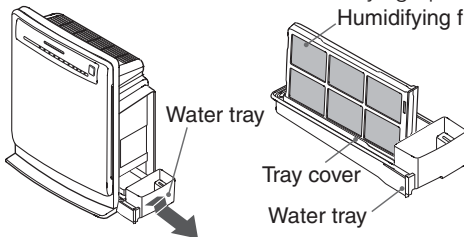

Slowly pull out the water tray while lifting it obliquely upward.

4 Set the water tank into the water tank holder.

- Be sure to handle the water-filled tank with both hands.
- Press in the tank securely until it clicks. Inadequate setting may cause the water tank to fall or result in water leakage.

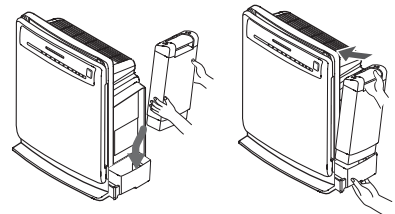

- When you remove the water tank, water may drip from the tank cap. Lay a dry cloth before removing the water tank.



- Do not set the water tank without having the water tray in place. Otherwise, the water tank may tip over.
- When you pull out the water tray, be careful not to scratch the floor with bottom of the tray.
- Do not leave the detached water tank with its cap closed. Inner pressure of the tank changes according to ambient temperature change and may cause water leakage or injury due to deformation or damage.

Note

- Humidifying function works automatically when the water tank and water tray are filled with water. If you do not need humidification, operate the unit without filling water in the water tank and water tray.

Installation

- Install the purifier on a level, stable and sturdy surface.
- Avoid any place close to cooling or heating appliance, and select a well-ventilated place.
- Keep the purifier at least 90 cm away from the walls in both sides. Otherwise, discharged air will mix with surrounding air and the walls may become dirty.



- Do not place the purifier on unstable floor or pedestal. Falling or dropping of the purifier may cause damage, failure or water leakage.
- Using the purifier in an inclined position may cause water leakage.

Using Remote Controller

● Here we describe how to operate the air purifier using the remote controller. For the operation using the control on the purifier, please refer to page E-13.

Starting Operation

● Remote Controller

● Air Purifier

● Indicator Section

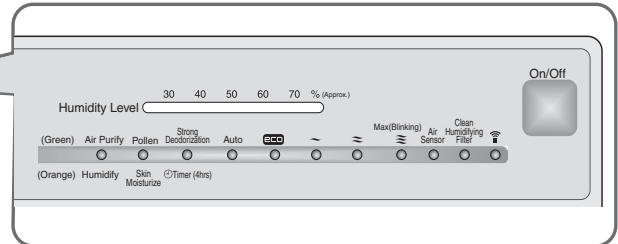
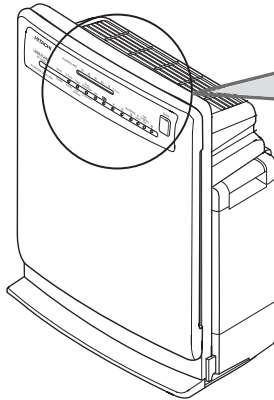
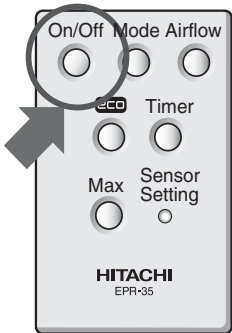

1 Securely insert the power plug into AC outlet.

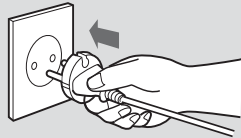

● In the first 3 minutes after the power cord is plugged in, the unit will check room air condition and save it in memory. During the time, the "Air Sensor" indicator and "Humidity Level 50" indicator will blink.

● You may start the operation in less than 3 minutes after plugging. In this case too, the "Air Sensor" and "Humidity Level 50" indicators will continue to blink. After 3 minutes, the indicators will stop to blink and show the level of air contamination and humidity.

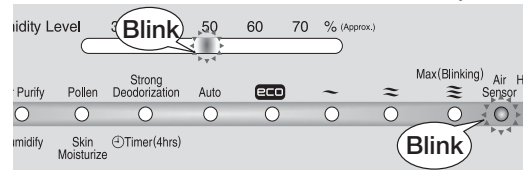

2 Press **On/Off** button.

Operation starts and the indicators are lit.

Pressing **On/Off** button during operation will stop the operation.

● The "Air Purify" mode indicator is lit in green. *

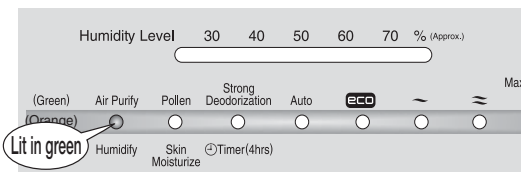

Note

If On/Off button is not pressed after plugging the power cord, all indicators will go off after the "Air Sensor" and "Humidity Level 50" indicators blink for 3 minutes. (Remote controller operation is accepted even in this state.)

* ● The factory setting is "Air Purify".

● From the second time onward, the memory function enables the operation with memorized conditions. → P.E-14

Stand-by Power Consumption

● So long as the power plug is left inserted in AC outlet, approx. 3W power will be consumed even if the unit is not used. (Unplug the power cord when the unit is left unused for an extended period of time.)

Selecting Operation Mode (Basics)

- 5 operation modes are available for your choice.
- In every operation mode, the fan will not stop during operation.
(In the eco operation mode, the fan may stop. (→P.E-16))
- In every operation mode, air purifying function will work.
- Upon every switching of operation mode, airflow rate is set to “Auto”.

Operation Modes and Tips for Selection

Mode	Tips for Selection
Air Purify (Green)	This is a normal operation mode. <ul style="list-style-type: none"> • The odor sensor detects the degree of air contamination, and airflow rate is switched automatically. • During automatic operation, airflow rate ranges from Silent to High.
Pollen (Green)	This mode is recommended when you have concerns about pollen contamination. <ul style="list-style-type: none"> • The operation with Medium airflow is continued for 20 minutes. Then the odor sensor detects the degree of air contamination and automatic operation is continued for another 20 minutes. After that, these operations are repeated. • During automatic operation, airflow rate can be any of Silent, Low or Medium.
Strong Deodorization (Green)※	This mode is recommended when you have concerns about room odor. <ul style="list-style-type: none"> • The odor sensor detects the degree of air contamination and switches to the operation with higher airflow than Air Purify mode. • During automatic operation, airflow rate ranges from Low to Max. • In the first one minute, Max airflow operation is performed regardless of the level of air contamination.
Humidify (Orange)	Room air humidity is controlled to approx. 50%. <ul style="list-style-type: none"> • During automatic operation, airflow rate ranges from Silent to High.
Skin Moisturize (Orange)	Room air humidity is controlled to approx. 60%. <ul style="list-style-type: none"> • During automatic operation, airflow rate ranges from Silent to High.

* The indicator is lit in orange when off-timer setting is made.

Note

- During operation, vibrations from the unit may slightly rock the water in the water tank.

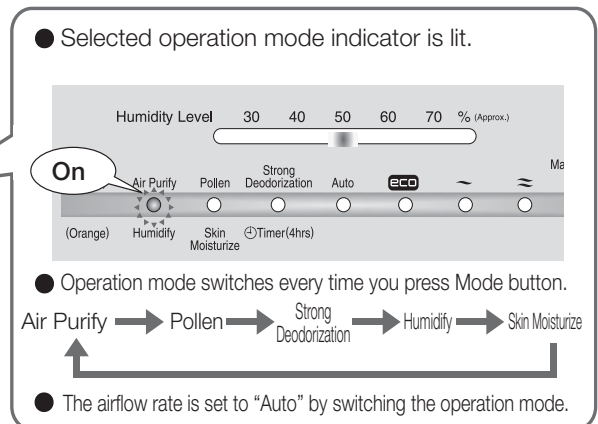
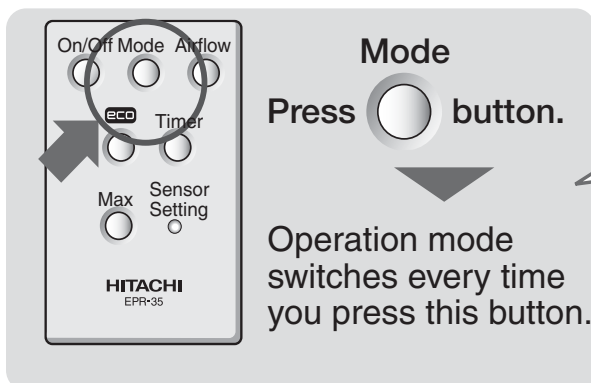

Using Remote Controller (Continued)

Airflow rate

- When “Auto” is lit, the following airflow rate is used according to the selected operation mode. The airflow rate indicators from “Silent” to “Max” are not lit.

Mode	Airflow Range
Air Purify	Silent ↔ Low ↔ Medium ↔ High
Pollen	Silent ↔ Low ↔ Medium
Strong Deodorization	Low ↔ Medium ↔ High ↔ Max
Humidify	When humidity level indicates 60% or higher Silent ↔ Low ↔ Medium ↔ High
Skin Moisturize	When humidity level indicates 70% or higher Silent ↔ Low ↔ Medium ↔ High

- According to the level of air contamination and humidity detected by the odor sensor and humidity sensor, airflow rate is automatically switched to an appropriate level.

Note

- So far as the water tank and water tray are filled with water, humidifying function works in any of “Air Purify”, “Pollen” and “Strong Deodorization” modes. If you do not want humidifying function, drain the water tank, water tray and humidifying filter.

Switching Airflow Rate

- You can select a desired airflow rate from the four different levels.



- Airflow rate switches every time you press Airflow button.



- Airflow rate changes in the following sequence.

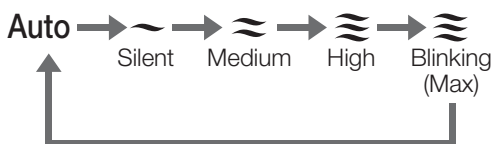

Max Operation

- This operation is useful when many people smoke or when you want quick cleaning of room air.

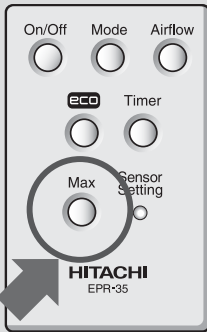

Press **Max** button.

The operation with Max airflow will continue for about 5 minutes.

After Max operation, the status before Max operation is resumed.

- The airflow indicator  blinks for 5 minutes.

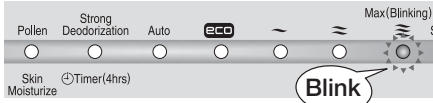

How to cancel

Press **On/Off** button or **Max** button during operation.

- It takes about 10 seconds until the air flow rate reaches Max.

Using Timer



Press **Timer** button.

Off-timer (4 hours) is set.

Operation will stop approx. 4 hours after timer setting.

- The timer indicator is lit on.



How to set/cancel

Every time you press **Timer** button, "Set" and "Cancel" will alternate.

- When you set Off-timer in Strong Deodorization mode, the indicator (orange) is lit on.

Using the Control on Purifier

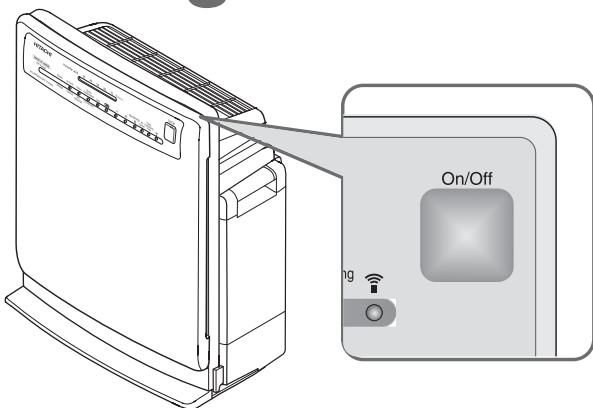

Press **On/Off** button.

Operation starts.

- Every time you press **On/Off** button, the operation mode switches in the following sequence so that you can choose a desired mode or stop.

Air Purify → Pollen → Strong Deodorization → Humidify → Skin Moisturize → Off → Air Purify

- The airflow rate is set to "Auto" by switching the operation mode.

Memory Function / Sensors / Auto Detection

Memory Function

- When you stop the operation and then restart, the purifier will resume the operation status before shutdown.
- If you operate the purifier for approx. 5 seconds or longer, the operation status will be stored in memory. (If you stop the operation within less than 5 seconds, the operation status will not be stored in memory.)
- Even if you unplug the power cord, the operation status will be stored in memory. However, the airflow rate is automatically set to "Auto".

Air Sensor

- Level of air contamination detected by the odor sensor is shown by the way the indicator is activated.

Indicator action : Lit in green ←··········→ Blink in green
Contamination level: Clean ←··········→ Contaminated

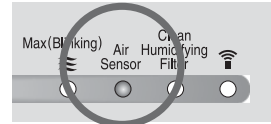

Note

- You can adjust the air sensor sensitivity setting as desired. → P.E-15
- In case the purifier is installed in a place where air contamination is hard to detect or in case the sensor itself is not clean, the indicator action may not change. → P.E-23

Odor Sensor

- The sensor detects odor in air such as cigarette smoke or odor of pet animals. Even when you feel the air is clean, the purifier may continue the operation if the odor sensor finds any gas component not removed by the filter. Any of the following may also be detected by the odor sensor.
- Combustion gas from heating appliance, alcohol, odor of perfumes or cosmetics used in beauty parlor or aesthetic salon, sprays, vapor, abrupt temperature change, etc.

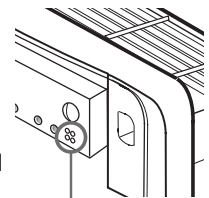

Odor sensor

Humidity Sensor

- The humidity sensor finds the humidity of room air during operation.
- Humidity level should be taken as a guide only.
 - The indication may differ from hygrometer reading.
 - Humidity will change as temperature changes.
 - Humidity level may differ between well-ventilated and ill-ventilated places.

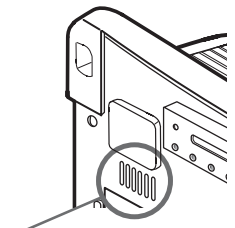

Humidity Sensor

Auto Detection

- The air purifier performs automatic operation by detecting room air contamination with "Odor Sensor" and room air humidity with "Humidity Sensor".
In the first 3 minutes after the power cord is plugged in, the unit will check room air condition and save it in memory. During the time, the "Air Sensor" indicator and "Humidity Level 50" indicator will blink. After 3 minutes, both the "Air Sensor" and "Humidity Level 50" indicators will go off and the purifier is now ready to operate.
- You may start the operation in less than 3 minutes after plugging the power cord.
In this case too, the "Air Sensor" and "Humidity Level 50" indicators will continue to blink, meaning the unit is checking room air condition. After 3 minutes, the indicators will show your room air conditions.
- If you plug in the power cord under contaminated air condition, the sensor sensitivity may be reduced. In such a case, perform High or Max operation. Or you may try to make the room air cleaner by opening a window before plugging the power cord. If the sensor sensitivity remains low after this, change the sensor sensitivity setting.

Adjusting Sensor Sensitivity Setting

- Sensor sensitivity can be adjusted in 3-step fashion.

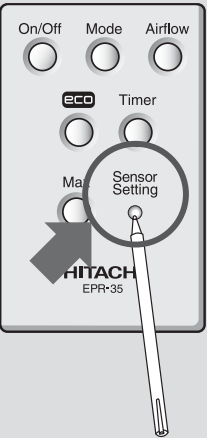

In each operation mode,
Sensor Setting
 press  button.
 (Use the tip of a ball-point pen or the like.)

The airflow indicator will blink for 5 seconds.

While the airflow indicator is blinking,
Sensor Setting
 press  button.

- The factory setting is “Medium”.

- Present setting is shown by the airflow indicator that blinks for 5 seconds.

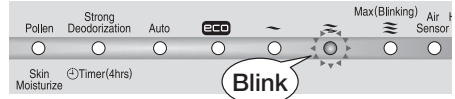

- Every time you press the button, the setting switches.

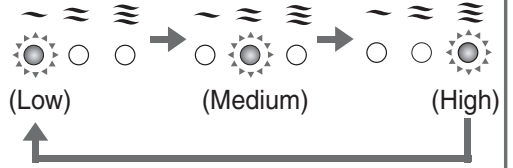

Useful Feature

Eco Operation

● In the eco operation mode, the unit automatically pauses when the air in the room is clean to save money on electricity. Furthermore, if this state continues more than 8 hours, the unit automatically stops operation. (In humidifying operations, the unit will not pause at a certain humidity level.)

• **Normal automatic operation**

When the air is clean, the unit continuously operates at “Silent” airflow. (In the strong deodorization mode, the airflow rate is set to “Low”.)

• **Eco operation**

When the air is clean and “Silent” operation continues for 10 minutes or longer, the fan stops for about 50 minutes and the unit intermittently operates at “Silent” airflow for about 10 minutes.

If this state continues more than 8 hours, the unit automatically stops operation.

※The odor sensor detects the degree of air contamination during eco operation. If the sensor detects odors, the airflow switches according to the degree of air contamination. When the air becomes clearer and the unit runs for 10 consecutive minutes or longer at “Silent” airflow, then the unit starts intermittent operation.

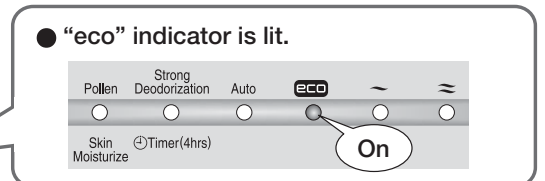
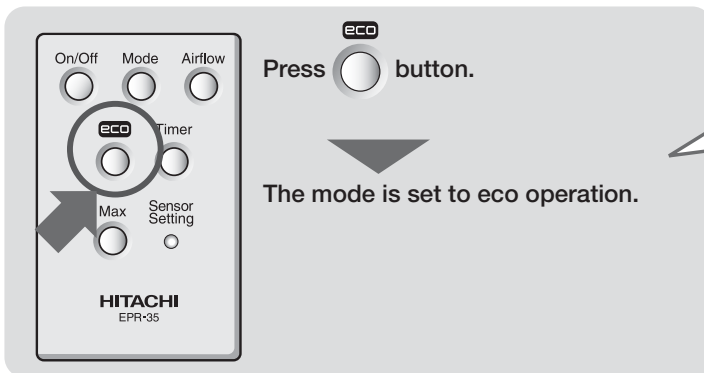
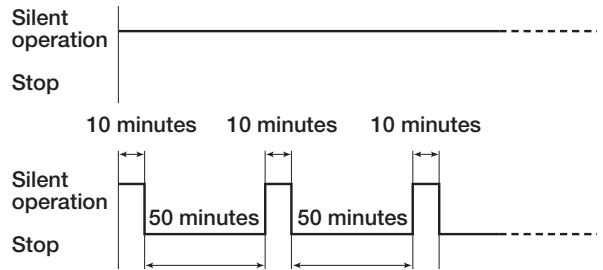

How to set/cancel

● The “eco” indicator is lit.

Every time you press button, “Set” and “Cancel” will alternate.

● The settings are stored.

Dimmer Control

● If you feel uncomfortable about indicator lightings when you go to sleep, press button on the purifier unit for 3 seconds or longer to dim the indicators.

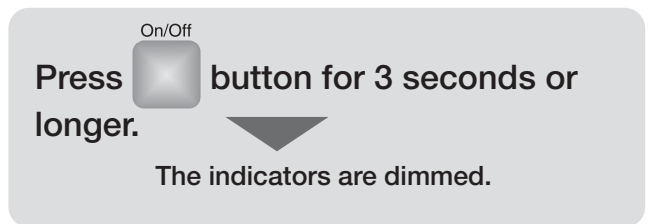
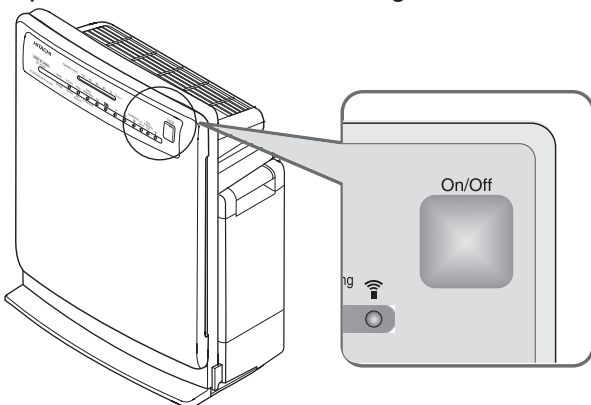

How to set/cancel

Every time you press button, “Set” and “Cancel” will alternate.

●The setting will be saved in memory.

Cleaning

■ Before cleaning, be sure to stop operation and unplug the power cord from AC outlet.



- Do not splash water on the purifier body. Water splash can be a cause of failure.
- Do not use a volatile solvent, such as gasoline, thinner, benzene, wax, kerosene, alcohol, etc. or polishing powder, or detergent (neither kitchen nor laundry use). Such chemicals could cause deformation, discoloration, damage or removal of prints.
- Do not tilt or tip over the unit.



- When using a chemically treated cloth, follow its instructions.
- Never use dryer or heater to dry the purifier case. Heating could cause deformation, discoloration, damage or removal of prints.
- Lay a soft cloth or the like beneath the purifier to protect the floor against scratch.

- When the “Clean Humidifying Filter” indicator is lit, clean the humidifying filter, water tray and tray cover. The “Clean Humidifying Filter” indicator will come on approx. one month (approx. 720 hours) after the start of use or after the reset button was pressed upon finishing previous cleaning. Depending on the tap water used, water scale may adhere earlier. If the filter contamination is heavy, clean the filter more than once a month before the “Clean Humidifying Filter” indicator is lit.
- When you are done with cleaning, press the reset button. The “Clean Humidifying Filter” indicator will go off.

When the “Clean Humidifying Filter” Indicator Comes On

1 Remove the water tank, and then pull out the water tray. → P.E-9

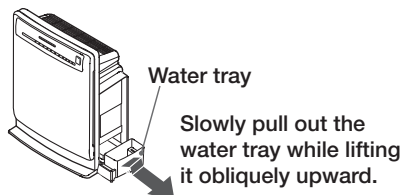

2 Remove the humidifying filter from the water tray.

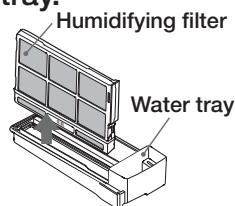

- When you pull out the water tray, water may spill out or the floor may be scratched with bottom of the tray. Lay a soft cloth or the like beneath the purifier to protect the floor.

3 Clean the humidifying filter, water tray and tray cover. → P.E-18, E-19

- When the purifier body is shaken or rocked, water may gather in other part of the water tray not to be fitted with the humidifying filter. After you pulled out the water tray, be sure to remove the tray cover and wipe off water or clean it.

4 Set the humidifying filter.

- Slowly insert the humidifying filter into the tray cover. Insert the filter fully until it comes into positive contact with bottom of the tray. Inadequate fitting may cause water leakage during operation.

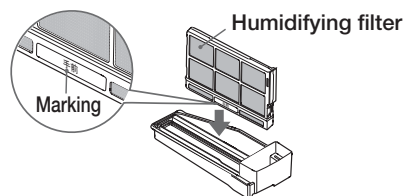

5 Install the water tray, and then mount the water tank.

6 Remove the panel. → P.E-8

7 Plug the power cord in AC outlet and press the reset button located behind the panel.

- Press the reset button located behind the panel. (Use the tip of a ball-point pen or the like.)
- Check that the “Clean Humidifying Filter” indicator is now OFF.

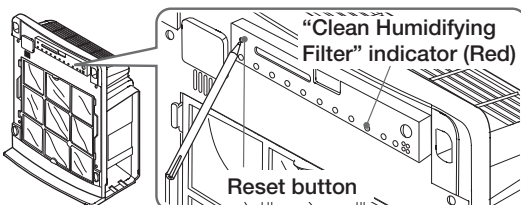

8 Mount the panel on the unit. → P.E-8

Cleaning (Continued)

Water Tank (Guide for cleaning: Daily)

- Change water daily with fresh tap water.
- Discard remaining water in the tank if any.
- Pour small quantity of tap water, tighten the cap firmly and shake to wash.
(Change water and repeat the steps 2-3 times.)

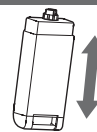

WARNING ● Do not use detergents (neither kitchen nor laundry use) for cleaning.

CAUTION

- Do not push in the pin at the cap center. Doing so may cause water leakage.
- Be sure to stop operation before removing the water tank.
- Do not set the water tank without having the water tray in place. Otherwise, the water tank may tip over.
- When you remove the water tank, water may drip from the tank cap.

Humidifying Filter (Guide for cleaning: Once a month)

- The humidifying system employed in this product is of evaporating type that produces moisturized air by passing air stream through the humidifying filter.
- Depending on application environment, dirt or odor may adhere to the humidifying filter even when the “Humidify” or “Skin Moisturize” mode is not performed.
- When “Humidify” or “Skin Moisturize” mode is used, be sure to pour tap water into the water tank.
- Although the humidifying filter has been given anti-bacterial and anti-mold processing, it may get slimy or moldy, or may be discolored to pink, red, green, brown or gray within a short period of use depending on the quality of tap water used and application environment. (Discoloration has no effect on humidifying performance.)
- It is recommended to clean the filter as often as practicable regardless of whether the “Clean Humidifying Filter” indicator is lit on or not.
Early replacement of the filter is recommended if it exhibits any of the following conditions despite periodical cleaning.
 - Heavy dirt, adhering water scale too hard to remove, harsh odors, damage or deformation
- If you do not use the “Humidify” or “Skin Moisturize” mode, drain the water tank and water tray.
Remaining water can be a cause of dirt or discoloration.

Do not disassemble the humidifying filter and its casing.

1 Submerge the humidifying filter in any of water, lukewarm water or water with neutral kitchen detergent for 30 minutes or longer.



- Do not disassemble the humidifying filter and its case.
- When you use neutral kitchen detergent, follow the instructions given by the manufacturer. (Only use neutral kitchen detergent.)

2 Change the water and rinse the humidifying filter by shaking it. (Repeat the steps 2-3 times.)



- When you use neutral kitchen detergent, rinse the filter well so that no detergent remains.

3 Shake lightly to drain off water. (Continue until no more dripping occurs.)

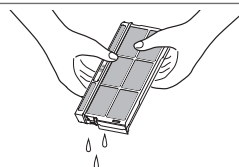

- As you operate the air purifier, whitish or brownish water scale will adhere inside of the water tray or to the humidifying filter surface. Water scale is the remnant of minerals in tap water that has not evaporated. If you continue to use the filter without cleaning the water scale, it will get hard and difficult to remove, resulting in lower humidifying performance.
- Depending on the quality of tap water used, water scale may adhere quickly.
In such a case, the cleaning should be done sooner.
- When you rinse the humidifying filter, rinse it as assembled with its case. Do not remove the case. (Removing the case may cause deformation or damage.)
- Do not scrub the humidifying filter with brush or press forcibly to deform. (It may cause damage and deterioration of performance.)
- New humidifying filter may smell at the beginning. This is normal.
- Replace the filter early if it is damaged.

CAUTION

- Washing the humidifying filter with citric acid will deteriorate the anti-bacterial and anti-mold performance.
- Do not install the humidifying filter if containing too much water. It may cause water leakage.

Replacing Humidifying Filter

- The humidifying filter is a consumable part. Replace it using 24 months of use as a guide (cleaning is needed once in every month).
Early replacement of the filter is recommended if it exhibits any of the following conditions despite periodical cleaning.
 - Heavy dirt, adhering water scale too hard to remove, harsh odors, damage or deformation
 Depending on the quality of tap water used, the humidifying filter may be consumed extremely early.
- Detach the case and replace the humidifying filter.

Do not dispose of the humidifying filter case.

1 To detach the case, push the 3 tabs.

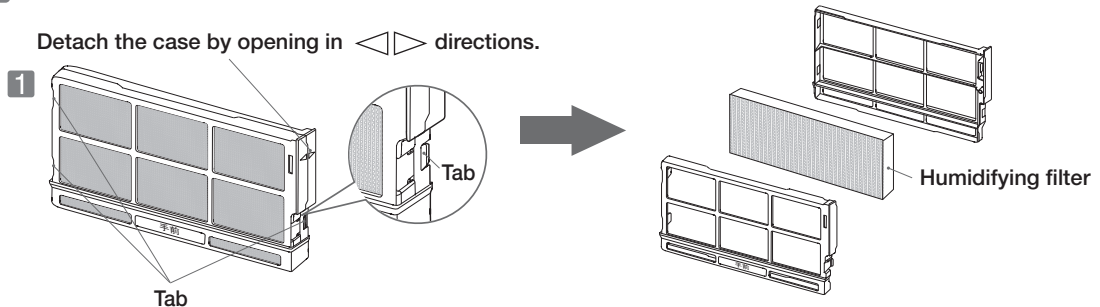

Replacement humidifying filter
No. EP-DX40E-908

- The humidifying filter is flammable. Dispose of the filter according to local regulations.

Water Tray / Tray Cover (Guide for cleaning: Once a month)

Do not use any detergent.

1 Remove the tray cover.

- Remove the tray cover from the water tray.

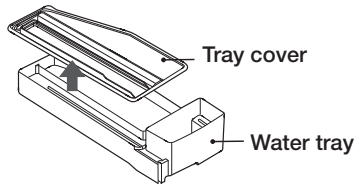

2 Wash with water to remove dirt.

- Drain water remaining on the tray.
- Use cotton swab or tooth brush to remove dirt in the narrow parts.

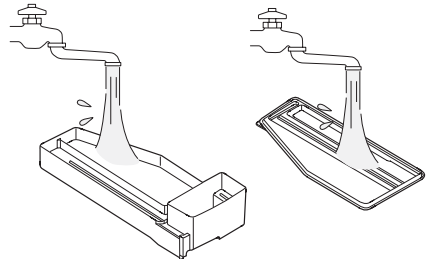

3 Wipe off water and assemble.

- Attach the tray cover to the water tray.

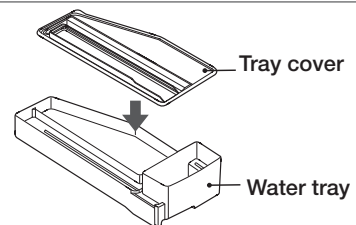

WARNING

- Do not use any detergent (neither kitchen nor laundry use).



CAUTION

- When you mount the water tray on the unit, the tray should be empty. Otherwise water may spill out.

Cleaning (Continued)

Pre-filter (Guide for cleaning: Once a month)

● To clean the pre-filter, follow the steps below.

- 1 Remove the water tank, and then pull out the water tray.** → P.E-9
(This is to prevent water leakage.)



● When you remove the water tank, water may drip from the tank cap. Lay a dry cloth before removing the water tank.

- 2 Remove the panel.** → P.E-8

- 3 Remove the pre-filter.**
 - Disengage the four tabs of the pre-filter.

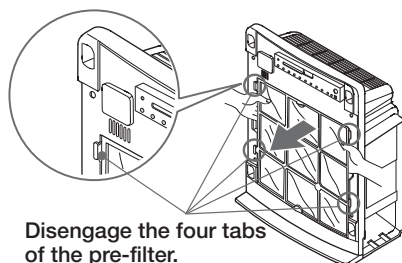

Disengage the four tabs of the pre-filter.

- 4 Clean the pre-filter.**
 - Use a vacuum cleaner or the like to remove dust. If the dust cannot be removed, wash off with water. After washing, fully drain the pre-filter and then dry it in a well-ventilated place not exposed to sunlight.
 - When you wash the pre-filter, use a soft toothbrush or the like.
 - If you want to remove dust on the filter, use a vacuum cleaner. (The filter is not washable.)

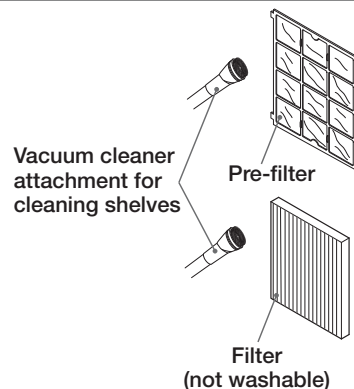

- 5 Reattach the pre-filter.**
 - Insert the four tabs securely into the holes on the purifier and fix the pre-filter.

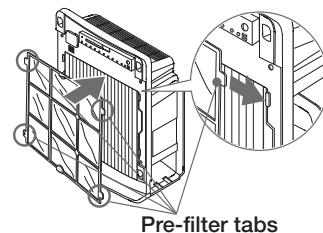

Pre-filter tabs

- 6 Reattach the panel.** → P.E-8

- 7 Install the water tray, and then mount the water tank.** → P.E-9

● The pre-filter is a consumable part.

When damaged pre-filter needs to be replaced, purchase the replacement part (Part No. EP-BX40-002).

Purifier Body (Guide for cleaning: Once a month)

- Wipe off dirt on the purifier case using a soft cloth that is moistened with water and fully wrung. For heavy dirt, use a soft cloth moistened with neutral detergent thinned with water. After removing dirt, use a dry soft cloth to wipe off moisture so that no detergent will remain.
- To clean the remote infrared receiver, use a thin cotton swab slightly moistened with water to wipe off dirt. After that, use a dry cotton swab to remove the moisture.
- Remove dust on the surfaces of the panel, air inlet, odor sensor and humidity sensor using a vacuum cleaner attachment for cleaning shelves. Then wipe off with a soft cloth.

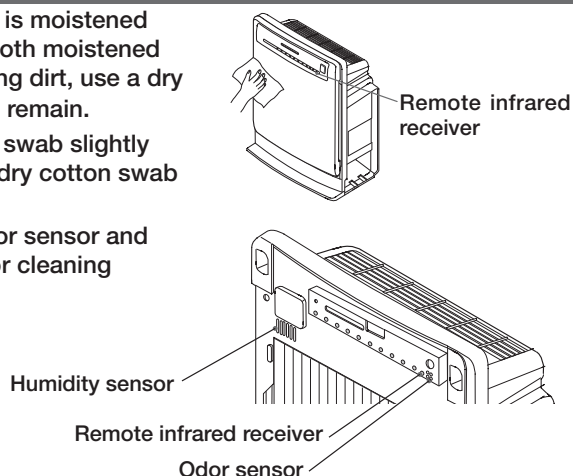
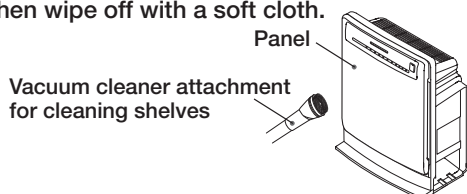

Filter Replacement

Replacement Interval

- The filter is a consumable part.
- For the filter replacement interval, use approx. 2 years as a guide when the air purifier processes the smoke generated by 5 cigarettes smoking a day.
- The dust filter should be replaced early if its color shows the resemblance to the color on the dirtiness label attached to the purifier body.
 - The colors on the dirtiness label are shown as a guide only. Depending on the place of installation, actual color of contaminated filter may differ from the color shown on this label.

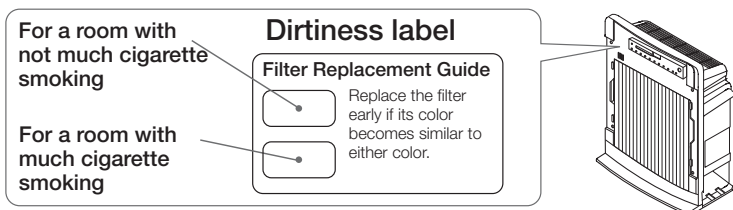

- The filter may need to be replaced earlier depending on the place of installation and conditions of use. When dirt or odor becomes harder to remove, replace the filter earlier than suggested. Otherwise, the filter may generate odor.
- The filter should be replaced earlier in the following cases.
 - When purifier intakes oily smoke, carbon substance (soot), etc. or when the smell of new building materials remains after a new house is built or the house is remodeled.
 - When used in stores, such as in coffee shops, game parlors, barber shops, beauty parlors, or in offices or hotels.
 - When purifier intakes large amounts of cigarette smoke.
 - When purifier intakes combustion gas generated by heating appliances.
 - When purifier intakes solvent content of paint, adhesive, etc.
 - When used in dusty place near a road where the traffic is heavy.

Precautions on Filter Handling

- Be sure to take the filter out of a plastic bag before use.
 - Do not set the filter when it is still in a plastic bag. Otherwise, malfunction may result.
- Avoid rough handling.
 - Do not crush, knead or roll the filter. Once the filter is broken, the cleaning effect will be lost.
- Do not wash the filter.
 - The filter is not washable for reuse. Purchase a new filter for replacement.
- The filter contains plastics inside. When you dispose of the filter, follow relevant local regulations on disposal.

Filter Replacement (Continued)

Replacing the Filter

■ Use the filter No. EP-DX40E-902 separately available.



● Use a genuine filter for the Hitachi Air Purifier.
Other filters may cause unit failure.

■ Before replacing the filter, be sure to stop the purifier and unplug the power cord from AC outlet.

- 1** Remove the water tank, and then pull out the water tray. → P.E-9
(This procedure should be done to prevent water leakage.)



● When you remove the water tank, water may drip from the tank cap.
Lay a dry cloth before removing the water tank.

- 2** Remove the panel and the pre-filter. → P.E-8

- 3** Remove the used filter.

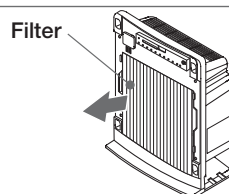

- 4** Install a new filter

- 1** Take a new filter out of plastic bag and install it on the unit.
● Install the filter so that the arrow "↓FRONT" on the filter side face will face the panel.

- 2** Install the pre-filter.

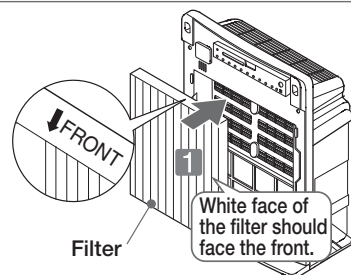

- 5** Reinstall the panel on the unit. → P.E-8

- 6** Install the water tray, and then mount the water tank. → P.E-9

Note

● No cleaning effect is obtainable if the filter is installed with plastic bag.
It may also be a cause of malfunction.

Alert Display

Symptom

All airflow indicators ~ ≃ ≍ are blinking.

Cause

Faulty fan rotation.

Stop the operation, unplug the power cord from AC outlet and contact your dealer for service. → P.E-26

Troubleshooting Guide

Before asking for repair

check the following once again

Symptom	Check to see	Solution
No air blows out or power does not turn on	● Is power plug securely inserted into AC outlet?	Securely insert the power plug into AC outlet.
	● Is breaker switched off?	Switch on breaker.
Smoke or smell is not efficiently removed, or there is an odor	● Is the pre-filter dirty?	Clean the pre-filter, referring to the “Pre-filter” in “Cleaning”. → P.E-20
	● Is the filter dirty?	Replace the filter, referring to the “Filter Replacement”. The filter may need to be replaced sooner depending on the place of installation and conditions of use. → P.E-21
No remote operation	● Are polarities of batteries correct?	Insert the batteries with correct polarities. → P.E-8
	● Are batteries dead?	Replace the batteries. → P.E-8
	● Is the remote infrared receiver dirty?	Clean the remote infrared receiver. → P.E-21
Airflow rate does not decrease even though the air is clean	● Is airflow rate switched?	Press the airflow button and select auto or other airflow rate. → P.E-11-E-13
	● Is the operation in the “Humidify” mode?	Airflow rate will not decrease when humidity is low.
	● Is sensor sensitivity high?	Change the sensor sensitivity setting. → P.E-15
Airflow rate does not increase even though the air is contaminated	● Is airflow rate switched?	Press the airflow button and select auto or other airflow rate. → P.E-11-E-13
	● Is odor sensor hole blocked by dust or other obstacle?	Clean the odor sensor. → P.E-21
	● Is sensor sensitivity low?	Change the sensor sensitivity setting. → P.E-15
	● Was the ambient air clean when the purifier power cord was plugged into AC outlet?	Change the airflow rate. Or open a window and plug the power cord into AC outlet when ambient air is clean. → P.E-14
“Air Sensor” indicator is kept constantly lit in green	● Is the purifier installed in a place out of reach of odor?	Relocate the air purifier.
	● Is odor sensor hole blocked by dust or other obstacle?	Clean the odor sensor. → P.E-21
“Air Sensor” indicator is kept blinking in green.	● Is there anything nearby that the odor sensor might sense? ● Any appliance generating combustion gas ● Alcohol, cosmetics, sprays, etc.	Purifier may sense invisible gas component that cannot be cleaned by filter and continue operation. Ventilate the room by opening window, etc. → P.E-14
	● Is odor sensor hole blocked by dust or other obstacle?	Clean the odor sensor. → P.E-21
No humidifying effect	● Is there water in the water tank?	Fill the water tank with water. → P.E-9
	● Is the operation in any of the “Air Purify”, “Pollen” or “Strong Deodorization” mode?	Change the operation mode to the “Humidify” or “Skin Moisturize” mode. → P.E-11
	● Is the humidifying filter dirty?	Clean or replace the humidifying filter, referring to the “Humidifying Filter” in “Cleaning”. → P.E-18

Troubleshooting Guide (Continued)

Symptom	Check to see	Solution
Humidifying performance is inadequate when operated in the "Humidify" mode	● Is the airflow rate set to "Auto"?	Depending on the place of installation and conditions of use, water may not be consumed. Set the operation mode to "Skin Moisturize" and the airflow rate to "High" or "Max". → P.E-11, E-12
	● Is the pre-filter or the filter dirty?	Clean the pre-filter, referring to "Pre-filter" in "Cleaning". → P.E-20
	● Is the humidifying filter set properly, or is it dirty?	Set the humidifying filter properly. If it is dirty, clean or replace it. → P.E-17, E-18
When operated in "Air Purify", "Pollen" or "Strong Deodorization" mode, air is humidified	● Is there water in the water tank and water tray?	Discharge water and then operate.
	● Is the humidifying filter wet with water?	Drain the humidifying filter.
Water leaks	● Is the water tank set properly?	Set the water tank properly. → P.E-9
	● Is the tank cap closed firmly, or the tank cap packing set securely?	Close the tank cap firmly. → P.E-9
	● Is the water tray cover closed properly?	Close the water tray cover properly.
	● Is the humidifying filter set securely?	Set the humidifying filter securely. → P.E-17
	● Is the purifier tilted, or was it carried with water in the tank?	Place the purifier on a level, stable surface. Avoid carrying the purifier with water in the tank.
	● Is there an opening in the water tank or water tray?	Stop using the purifier immediately and contact your dealer for repair.
	● Is there any leakage from the water tank?	Stop using the purifier immediately and contact your dealer for repair.
Indicator is dim	● Is dimmer control activated?	Cancel the dimmer control setting. → P.E-16
The "Clean Humidifying Filter" indicator does not go off	● Was the reset button pressed after cleaning?	Press the reset button. → P.E-17

Following Conditions Are Normal

Symptom	Cause
Snapping noise when plugging power cord into AC outlet	Electric components are energized when power is supplied. This is normal.
Purifier body vibration during the "Max" operation	Vibration is caused by fan rotation. This is normal.
The air from the air outlet smells.	When you use this purifier for the first time, the parts inside the purifier body smell, but this is normal. Or, the filter deodorizing performance may have deteriorated. → P.E-21 Or, odors may have adhered to the humidifying filter. Clean the humidifying filter. → P.E-17-E-18
No vapor or mist visible	As the unit employs evaporation system that produces moisturized air by passing air stream through the humidifying filter, no vapor or mist is visible. This is normal.
Bubbling noise	The noise is produced by air bubble when water in the water tank is supplied to the water tray. This is normal.
Humidity level indication differs from hygrometer reading	Humidity level is indicated as a guide only. Also an environmental difference in the room may cause different indications.
Shutter is stopped midway	There is no problem in performance even if the shutter is not fully opened. This is normal.
Clicking noise during operation	It is a switching sound of the shutter. This is normal.
Rocking water surface in the water tank	It is caused by vibration during operation. This is normal.
Indicators repeatedly turn on and off one after another, and the fan is stationary	The unit is in the demo mode. Unplug the power cord once, wait for a few seconds, and then insert the power plug into AC outlet.
Pressing the eco button operates the ionization setting / release of the other Hitachi air purifier with ionizing function. Or, pressing the ionizing button on the remote controller for the other Hitachi air purifier with ionizing function operates the setting / release of eco operation.	The signals from the remote controllers are the same. Both functions respond. This is normal.
The fan is stopped.	When eco operation is selected, the fan may stop. → P.E-16

Replacement Parts (Separately Available)

● Filter

Designate the replacement part
No. EP-DX40E-902 when ordering.



● Pre-filter

Designate the replacement part
No. EP-BX40-002 when ordering.

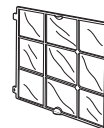

● Humidifying Filter

Designate the replacement part
No. EP-DX40E-908 when ordering.

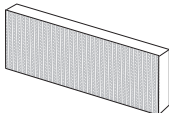

The case is not included.

● Tank Cap

Designate the replacement part
No. EP-BV60-017 when ordering.



Specifications

Model	EP-A5000			
Power supply	AC220-240V 50-60Hz			
Airflow switching	Max	High	Medium	Silent
Power consumption (W)	50	32	14	4
Airflow rate (m ³ /min)	5.0	4.3	2.9	0.9
Applicable floor space	33m ²			
Humidifying performance (mL/h)	Approx. 520 (Max operation)			
External dimensions	537(H) x 430(W) x 242(D) mm			
Weight	8.5kg			
Length of power cord	Approx. 1.8m			

