



# HITACHI

Inspire the Next

## Instruction Manual

### Hitachi Air Purifier

Model

# EP-NZG70J

Thank you for purchasing a Hitachi air purifier.  
This air purifier is for household use only.  
Do not use it for any other purpose besides purifying air.  
**Please read this instruction manual carefully before using this product to ensure the unit is operated correctly.**  
For future reference, keep this manual in an easily accessible place.

Read "Safety Precautions" → **(P.E-8 - E-12)**  
to ensure correct use.

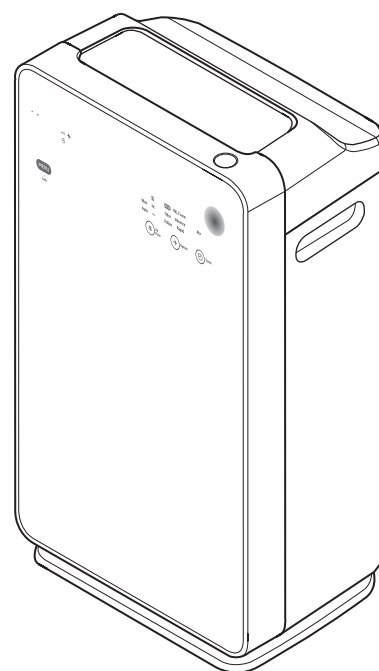

# Features

1. Wide suction and speedy dust collection in just 9 minutes for a 13m<sup>2</sup> room.  
Standard applicable floor space - 53m<sup>2</sup>
2. With the Allergen-free HEPA Filter, fine dust particles are thoroughly collected.

# Contents

## Before Use

<b>Features</b> .....	<b>E-2</b>
<b>Name of Each Component / Accessories</b> ....	<b>E-4</b>
<b>Operating the Touch Operation Panel</b> ....	<b>E-6</b>
<b>Safety Precautions</b> .....	<b>E-8</b>
<b>Cautions on Use</b> .....	<b>E-13</b>
<b>Air Cleaner Deodorizing Performance</b> ...	<b>E-13</b>
<b>Preparations for Operation</b> .....	<b>E-14</b>
Setting Filter in Unit .....	E-14
<b>Installation</b> .....	<b>E-16</b>

## Operating Air Purifier

<b>Operation</b> .....	<b>E-17</b>
Starting Operation .....	E-17
Switching Airflow Rate .....	E-17
<b>Useful Features</b> .....	<b>E-18</b>
Operating in Option.....	E-18
Eco Saving Operation.....	E-19
PM2.5 Sensor .....	E-19
Stopping Operation Using Off-timer.....	E-19
Setting the Lock .....	E-20
<b>Memory Function / Sensors /</b>	
<b>Auto Detection</b> .....	<b>E-21</b>
Memory Function .....	E-21
Air Sensor .....	E-21
Odor Sensor .....	E-21
Dust Sensor .....	E-21
Auto Detection .....	E-22
Adjusting Sensory Sensitivity Setting .....	E-22

## Cleaning and Maintenance

<b>Cleaning</b> .....	<b>E-23</b>
Pre-filter, Filter .....	E-23
Purifier .....	E-24
Dust Sensor .....	E-24
<b>Replacing the Filter</b> .....	<b>E-25</b>
Replacement Interval.....	E-25
Handling the Filter.....	E-25
How to Replace the Filter .....	E-26
<b>Troubleshooting Guide</b> .....	<b>E-27</b>
<b>Replacement Parts</b> .....	<b>E-29</b>
<b>Specifications</b> .....	<b>E-29</b>

Before Use

Operating Air Purifier

Cleaning and Maintenance

# Name of Each Component / Accessories

## Names of Each Component

**CAUTION**

- **Do not hold the flaps when moving the unit.**  
Doing so may cause unexpected injury when the unit is damaged and overturned or dropped.

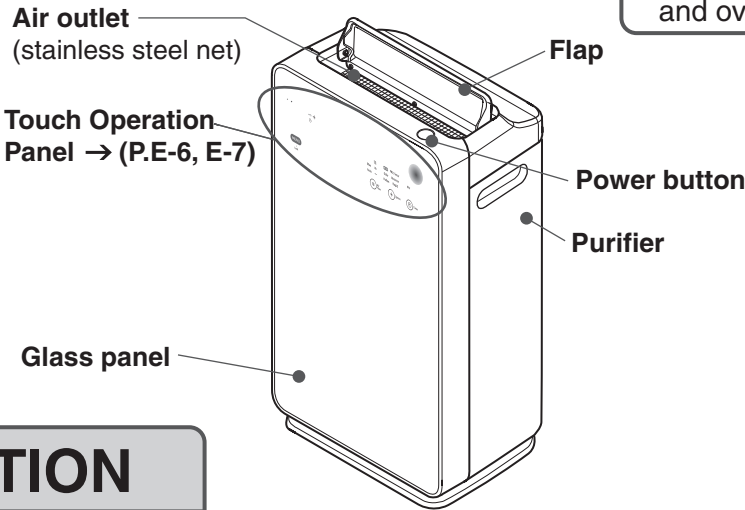

**CAUTION**

- **Do not subject the glass panel (made of tempered glass) to impact**  
Although tempered glass is stronger and safer than normal glass, it can break when subject to strong impact or force.  
In case of scratches or breakage, stop using and immediately request repairs.  
Refrain from touching the broken glass.

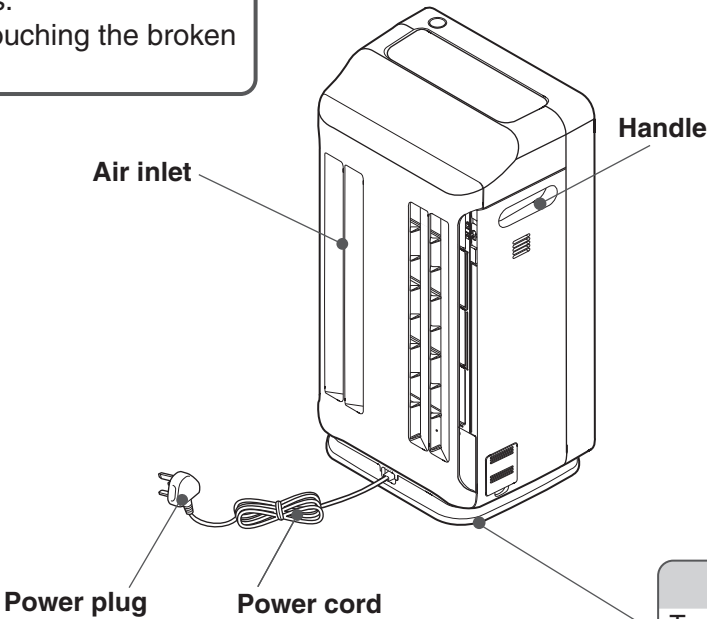

**Caster**

To prevent falls, the movement is only in sideways direction. (Located at the base of the unit)

■ → (P.E-○○) Numbers are pages containing the main description each parts.

Name of Each Component / Accessories

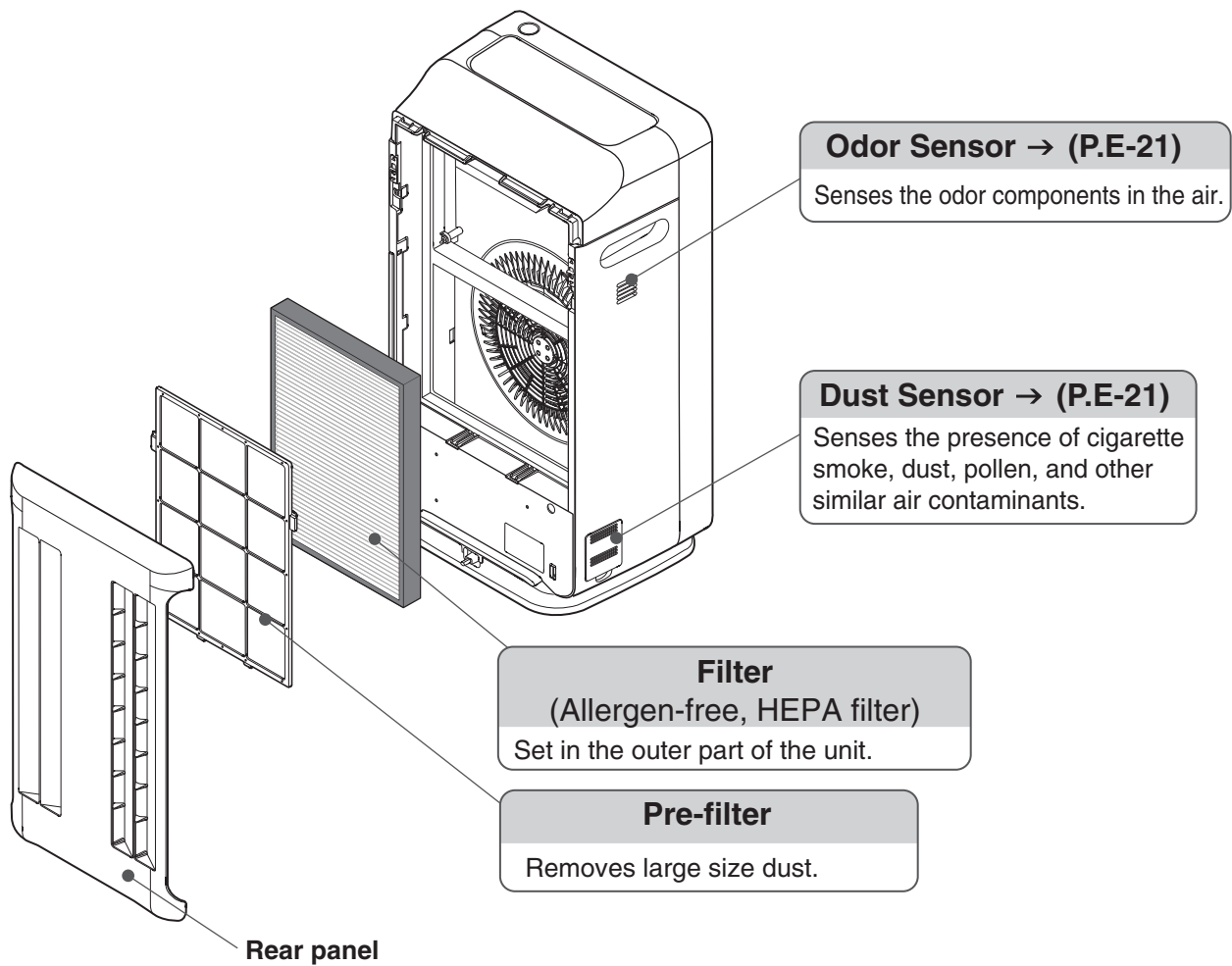

# Accessories

## Filter

Housed inside the purifier.  
\* The filter must be removed from the plastic packaging before operating the unit.

### CAUTION

- The vibration during transporting the unit might cause deodorizing agent granules to fall out from the filter.
- When removing the plastic cover of the filter and attaching the filter to the unit, make sure that your hands, clothes, and the surroundings will not get dirty.
  - Wipe of any granules that may have fallen or clung to the filter.
  - This will not affect the deodorizing performance.

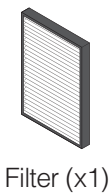

Filter (x1)



## Pre-filter



(x1)

# Operating the Touch Operation Panel

- The touch operation panel is made of glass.
- If the touch operation panel display disappears, touch **MENU** to display it again.  
The touch operation panel display will disappear when **MENU** is touched again.
- The upper part of the touch operation panel is the display section and the lower part is the control section.
- Use the touch operation panel to switch settings.

Notification Display	
	The indicator lights up when the child lock is set. → (P.E-20)
	The indicator lights up when the unit is operating on timer. → (P.E-19)
	The indicator lights up when the unit is operating with PM2.5 sensing. → (P.E-19)

**MENU**

- Touch this button first when the display or operation panel is off. When tapped again, it turns off the display or operation panel.
- Lock  
(Long-press MENU for about 3 seconds)  
Use this to prevent incorrect operation. → (P.E-20)

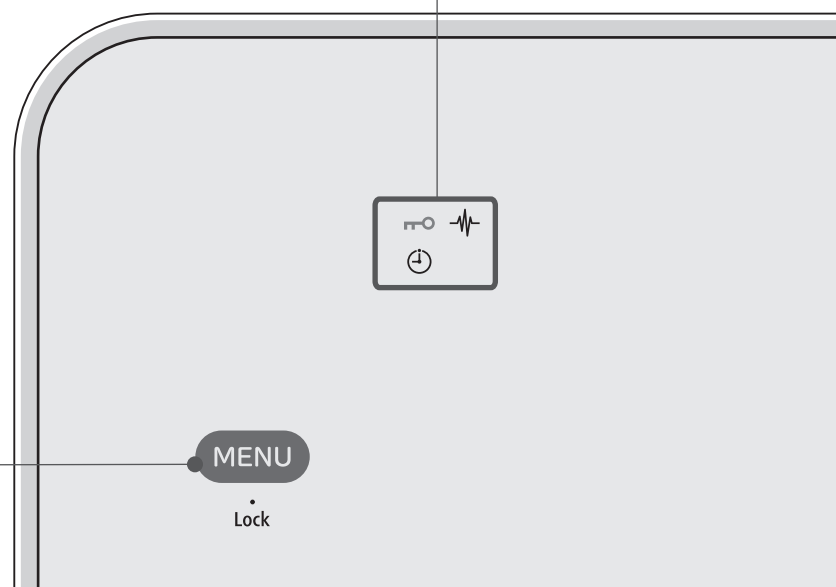

## Note

- The glass touch may have a different reaction depending on the surrounding temperature and humidity, physical condition of the user, and the condition of the electronic appliances near by the unit.
- If it does not respond after touching, release and try again.  
If the interval between touches is short, the unit may respond incorrectly.  
The sensitivity will not change by the force applied when touching.
- There may be no response if the operation panel is wet or dirty.  
Wipe off with a dry cloth to use.
- The display may be difficult to view if the unit is placed in brightly lit places such as near a window with direct sun light.

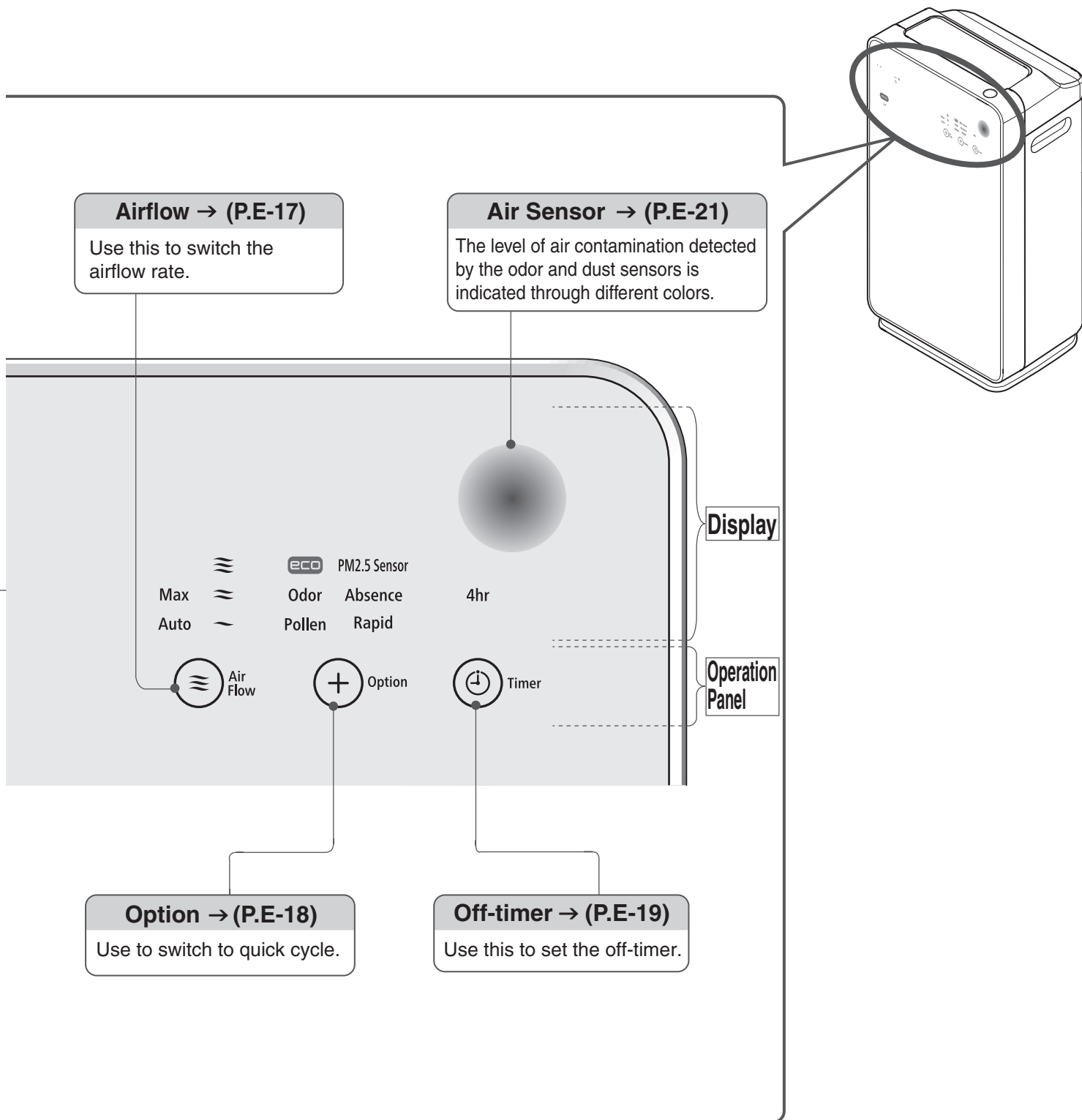





# Safety Precautions

- **Please read the following safety precautions carefully before using the unit.**

To prevent injury to the user or other people and property damage, the following instructions must be followed. Also read the precautions appearing in the text carefully to ensure correct use.

- **Definition of each indication**

Incorrect operations that are carried out as a result of ignoring instructions will cause harm or damage. The seriousness is classified by the following indications.

 <b>WARNING</b> This symbol indicates the possibility of death or serious injury.	<b>Meaning of Symbols</b>	
 <b>CAUTION</b> This symbol indicates the possibility of injury or damage to property.	 Indicates "prohibition".	 Indicates "necessity".

## **WARNING**

### To Prevent Fire, Electric Shock and Injury

#### AC Outlet, Power Plug and Power Cord



- **Remove dust from the blade and the blade mounting surface of the power plug.**

Otherwise, it may cause a fire.

- **Be sure to unplug the power cord from the AC outlet when cleaning or not using the unit for an extended period of time.**

Otherwise, it may cause an electric shock or injury.

- **Be sure to hold the plug when unplugging it.**

Otherwise, it may cause an electric shock or short-circuit, which may result in a fire.

- **Securely insert the power plug into the AC outlet.**

Otherwise, it may cause an electric shock, overheating or fire.



- **Do not stop operation by unplugging the power plug.**

Otherwise, it may cause fire, electric shock or malfunction.

- **Never plug or unplug the power plug with wet hands.**

Otherwise, it may cause an electric shock.

- **Do not use a damaged power cord or power plug, or a loose AC outlet.**

Otherwise, it may cause an electric shock, short-circuit or ignition.

- **Do not damage the power cord.**

(Do not break, modify, forcibly bend, pull or twist it. Also do not place any heavy objects on it, pinch it, or step on it when moving it with the caster.)

Otherwise, it may cause damage to the power cord, fire or ignition.

- **Make sure to avoid inserting too many plugs into the AC outlet.**

Otherwise, it may cause fire or ignition.

- **Do not immerse the power plug in water, or pour water on it.**

Do not use a power plug when wet.

Doing so may cause ground leakage, electrical shock and unit failure.

- **If the supply cord is damaged, it must be replaced by the manufacturer, its service agent or similarly qualified persons in order to avoid a hazard.**

- **Do not use with a voltage other than 220-240V AC.**

Otherwise, it may cause a fire or electric shock.





## WARNING

### Before Use



- **Ventilate the room frequently when in use with heating appliances.**

Otherwise, it may cause carbon monoxide poisoning.

This product cannot remove carbon monoxide.



- **Do not block the air outlet or air inlets with laundry, cloth, curtains, etc.**

Poor ventilation may cause overheating or fire.

- **Do not use flammable materials (hair sprays, insecticides, air fresheners, etc.) near the unit.**

Do not use benzene, thinner or alcohol to clean the purifier.

Otherwise, it may lead to cracking, electric shock, ignition, smoke or fire.

- **Do not use in a kitchen as a substitute for a ventilation fan and range hood fan.**

Otherwise, it may cause unit deformation by heat or it may ignite a fire in the filter.

Also, it may cause failure or a decrease in the lifespan of the pre-filter, filter assembly and deodorizing filter.

- **Keep away from lit candles, mosquito coils, lit cigarettes, etc. Also, do not let smoke from these materials enter the unit.**

Otherwise, it may cause fire.

- **Do not operate the unit when using fumigating (smoking) type insecticide. Do not let chemicals enter the unit.**

Use of such insecticides will cause chemicals to accumulate in the unit and depending on a person's sensitivity to these chemicals, it may be harmful to one's health.

- **Do not place in a location where the air from the outlets will blow directly onto heating appliances.**

Otherwise, it may cause incomplete combustion and carbon monoxide poisoning.

- **Do not use in narrow spaces such as gaps between the furniture or closet.**

Poor ventilation may cause overheating or fire.

- **Do not operate the unit while filter, etc. is detached.**

Otherwise it may cause injury or failure.

- **Do not tilt or tip the unit over. Do not put your weight on the unit or step on it.**

**Also, do not use it in an unstable place or anywhere near infants.**

Otherwise, it may cause the unit to tip over due to vibration, which may cause an injury or unit failure.

### Cleaning



- **When cleaning, do not splash water on the unit.**

It may cause short-circuiting and electric shock.

- **Do not add water by submerging or splashing water on the unit.**

It may cause short-circuiting and electric shock.

# Safety Precautions (Continued)



## WARNING

### Cleaning



- **Do not use detergents when cleaning.**

Usage of chlorine-based and acid type detergents will generate toxic gas and can cause a health threat. Also, do not use neutral detergents as it may affect the plastic.

### Place of Use



- **Do not use in a location where there is huge amount of oily smoke such as in cafeterias and eateries.**

The oil residue or dust deposited in the unit may cause fire, unit failure and unpleasant odor.

- **Do not use in a location where there is flammable gas, corrosive gas or metallic dust, or risk of leakage of oil, flammable gas.**

It may cause fire, explosion or unit failure.

- **Do not use in a location where solvents such as paint and adhesives are being used or stored.**

It may cause deterioration of parts or fire.

- **Do not use in a location where soot from oil, such as machine oil, is floating in the air.**

It may cause a crack, electric shock or fire.

- **Do not use in a location where any chemical is used. (Hospitals, factories, laboratories, beauty salons, photographic laboratories, etc.)**

Chemicals and solvents evaporating into the air deteriorate the unit. This causes electric shock.

- **Do not use in a humid place or in a place where it may easily be wet, such as in a bathroom.**

It may cause electric shock or fire due to ground leakage.

- **Do not place it near a hot object such as a heater.**

It may cause deformation, discoloration, injury and unit failure.

- **Do not put in places exposed to direct sunlight, wind and rain.**

It may cause overheating, electric shock and fire due to ground leakage.

- **Do not use in a location where a machine tool that produces flammable dust or sparks (such as a grinder or welder) is installed.**

It may cause fire.

### Miscellaneous



- **Even after switching on, sometimes the air purifier is inoperative or air does not come out. There may be “cracks” and “scratches” in the power cord, or the unit has been moved which causes the operation to stop. There may also be unusual noise and vibration during operation. The unit may be deformed and unusually hot. There may be a burnt odor. If there are abnormalities aside from those mentioned, unplug the power cord immediately to prevent accidents and contact your dealer to request for checks or repairs.**

These may cause fire due to electric shock, ground leakage or short-circuiting.

- **Pay specific attention when the user of the air purifier is the following: (Infants, children, the elderly, those who cannot control their body temperature)**

When the body is exposed directly to the wind for a long time, health may be compromised.



## WARNING

### Miscellaneous



- **Do not put your finger or any other object (metal, paper, etc.) into the air inlet or outlet.**  
It may cause injury, electric shock and fire.
- **Never attempt to disassemble, modify or carry out repairs by yourself.**  
It may cause fire, electric shock or injury. (Contact your dealer for repairs)
- **Do not operate detection switches (for the dust filter and rear panel) using your fingers, rod, or tape.**  
Doing so may result in an injury, failure, or unexpected accident.
- **Children should be supervised to ensure that they do not play with the appliance.**



## CAUTION

### Moving the Air Purifier



- **Move only in sideways direction with the caster (to prevent from falling).**  
There are cases when the floor may be damaged based on the type of flooring.  
Unplug the power cord from the AC outlet.
- **Lift the air purifier when moving it along a mat, a floor susceptible to scratches, an uneven floor or a thick carpet.**  
It may damage the mat, floor and carpet and may cause unit failure and injury when tipped over.
- **When carrying the air purifier, hold the handle firmly.**  
If you hold parts other than the handle, the unit may tip over and be damaged, and may cause an accident.
- **Unplug the power cord from the AC outlet.**  
When moving the unit without unplugging, the power plug and power cord may be damaged.



- **Do not touch, hold, or lift the moving flap.**  
It may cause an injury and unit failure.  
When carrying the air purifier, hold the handle.
- **Do not pull the power cord when moving the unit.**  
It may damage the power cord.

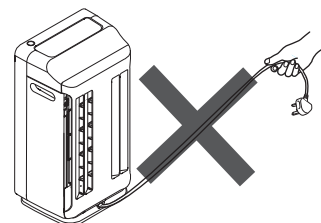

### Place of Use



- **Do not use the air purifier near a wall that cannot be scrubbed, such as a white cloth-covered wall.**  
The air purifier will take in the surrounding air and may stain a wall near its air outlet.
- **Do not use in storerooms for artworks and academic materials, or for other business purposes.**  
It may deteriorate the quality of the stored products.
- **Do not put water containers such as flower vases and fish bowls on top or near the unit.**  
Water deposited in the unit may cause electric shock, fire and unit failure.
- **Do not use in locations near cooking appliances.**  
It may cause deterioration of parts, electric shock and fire due to heat and oily smoke.
- **Do not use on floors susceptible to scratches such as Cypress floors.**  
It may damage the floor.

# Safety Precautions (Continued)



## CAUTION

### Cleaning



- **Perform panel removal and installation carefully.**  
It may cause injuries such as pinching your fingers.
- **When cleaning, lay a soft cloth on the floor and place the unit and detached parts (panel, etc.) on it**  
Otherwise, it may scratch the floor.
- **Attach the parts securely after cleaning**  
Do not use with the rear panel, pre-filter, filter, and any other parts detached. Otherwise, it may cause unit failure.

### Miscellaneous



- **Do not move or stop the flap by hand or by any object**  
Otherwise, it may cause unit failure.
- **If using the purifier around pets, do not subject any parts to urine and keep pets away from the power cord**  
Otherwise it can cause electric shock and fire. If there are damages, unplug and request repairs.
- **Do not subject the glass panel (made of tempered glass) to impact**  
Although tempered glass is stronger and safer than normal glass, it can break when subjected to strong impact or force.  
In case of scratches or breakage, stop using and immediately request repairs.  
Refrain from directly touching the broken glass.



- **Use only a genuine filter for the Hitachi Air Purifier**  
Other filters may cause unit failure.
- **This appliance is not intended for use by persons (including children) with reduced physical, sensory or mental capabilities, or lack of experience and knowledge, unless they have been given supervision or instruction concerning use of appliance by a person responsible for their safety.**

# Cautions on Use

## Do not operate with the filter detached

Otherwise, no cleaning effect can be expected. It may also cause unit failure.

## Do not block or touch the odor and dust sensors

It may reduce the sensitivity of the sensors.

## Do not use in locations near cooking appliances

It may cause deformation and discoloration due to heat or oily smoke, unit damage or fire.

Place the purifier and the cooking appliance at least 1m apart from each other.

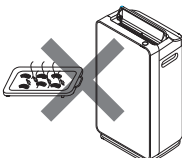

## Ventilate closed rooms occasionally

The purifier does not have a ventilation effect (removal of carbon monoxide and other contaminants).

\* The purifier cannot remove harmful substances in cigarettes (carbon monoxide, etc.).

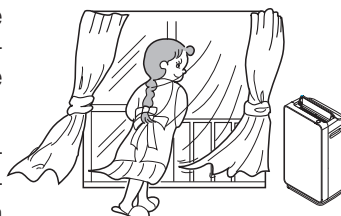

## Do not directly fan plants and animals

It may adversely affect them.

## Refrain from placing any object on the unit and blocking the air inlet and outlet

Doing so may cause unit failure and injury.



## Refrain from moving (changing the orientation or lifting the unit, etc.) during operation

Moving the unit while in operation may cause the fan to hit the inner case, generate noise, pull and disconnect the power cord, and cause unit failure.

## Do not use near television or radio

Doing so may interfere with broadcasts.

Please place them at least 2m apart from each other.

The same applies for cordless phones and wireless microphones.

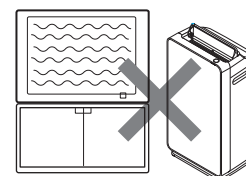

# Air Cleaner Deodorizing Performance

- The filter of the air purifier does not remove all odors at once, but rather circulates the air in the room, removing odors gradually.
- The filter is disposable. The deodorizing performance of the filter decreases with use.
- When the odor emitted from the vent becomes bothersome, clean the filter. → (P.E-23)
- When the filter has absorbed strong odors or has been continually used in an odorous room, the odor components remain in the filter and unit, causing the odor to be emitted from the vent.  
If this happens, you can decrease the amount of odor that remains in the unit by continuing to operate the purifier while ventilating the room.
- The dust and other contaminants attached to the filter and unit also contain odor components.  
Periodically clean the filter and unit so that odor is less likely to be emitted from the vent. → (P.E-23, E-24)
- If the odor emitted from the vent remains bothersome after cleaning, replace the filter. → (P.E-25)

# Preparations for Operation

## CAUTION

- Movement with casters should be done slowly. The movement is only in sideways direction. (To prevent from falling)
- No cleaning effect will be experienced if the filter is set without detaching the plastic cover. It will also cause unit failure.
- Do not tip over or tilt the unit.

## Setting Filter in Unit

- Setting procedure is the same with filter replacement. (Use only genuine Hitachi Air Purifier filters.)

1

### Remove rear panel and pre-filter

- 1 Place the unit on a flat and stable location.
- 2 Hold the bottom part of the rear panel (2 locations), pull it out gently, and shift slightly upward to remove it.
- 3 Slide the switch upwards (2 locations) to release the lock.
- 4 Remove the pre-filter.

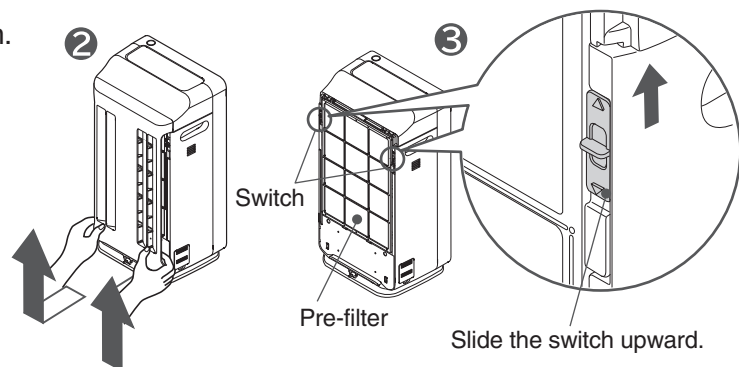

2

### Remove the filter

- 1 Remove the filter from the unit.
- 2 Remove the filter from the plastic packaging.

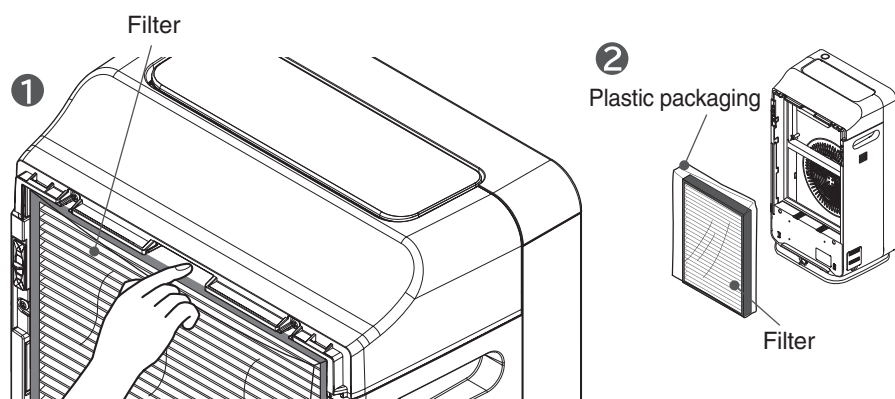

3

### Install the filter to the unit

## CAUTION

- Do not put excessive force and deform the filter.

Set the filter so that you can see the label  
"この面を手前にセットしてください。"

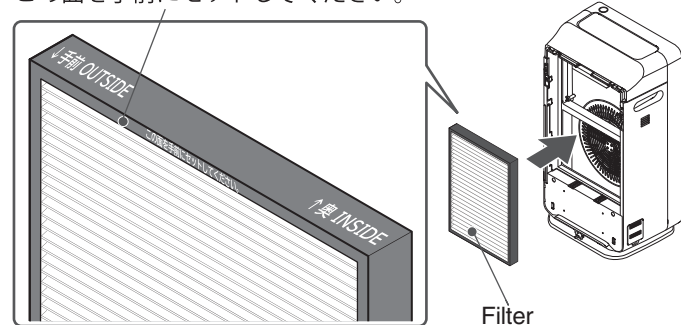

# 4

## Install the pre-filter to the unit

- ① Securely plug the tabs of the pre-filter to the matching holes in the unit.
- ② Slide the switch downwards (2 locations) to lock.
- ③ Gently pull the pre-filter to make sure it is not out of place.

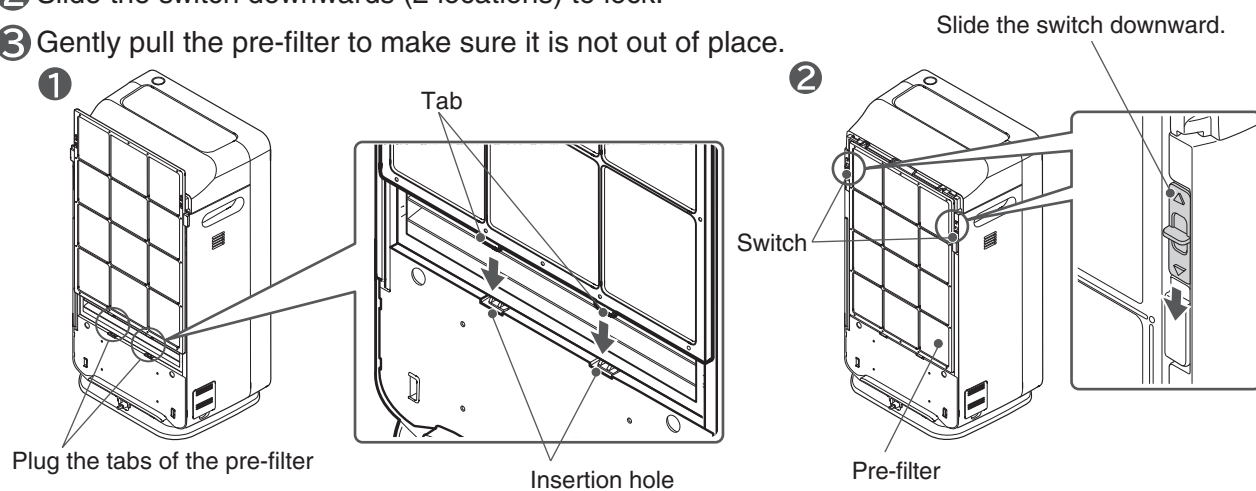

Preparations for Operation

# 5

## Attach the rear panel to the unit

- ① Plug the tabs (2 locations) of the upper part of the rear panel to the matching holes in the unit.
- ② Gently push the bottom sides of the panel one after another, and close it securely until it clicks.

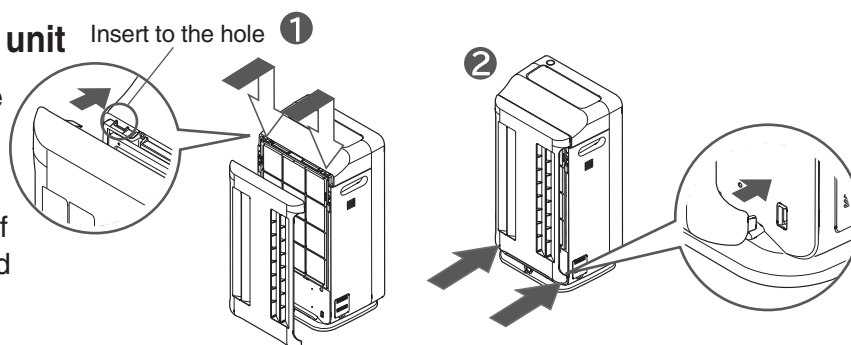



# Installation

- A caster is attached at the base of the unit, thus it should be set on an even, stable and sturdy floor.  
(No stopper attached to the caster)
- Avoid places near heating or cooling equipment and other similar equipment, and choose a location with a good air circulation.
- Keep the rear at least 3cm away from the wall. Depending on the operating environment, walls or floors near the outlet may be stained as the unit draws in air. If this is a concern, move it from its current location and clean the surrounding walls and floors regularly.
- Be sure to provide space around the sides of the unit so that the inlets and vents are not blocked by curtains or furniture.

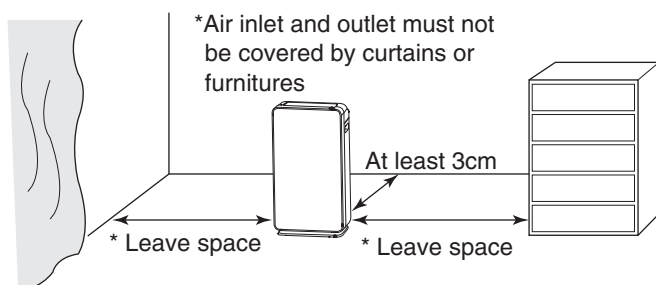

- Be careful not to pull or pinch the power cord.
- Leaving the unit at the same place for an extended period of time may leave stains on the walls and floors.  
When cleaning the unit, move it to another place and also include cleaning the floor.



## WARNING

- **Do not place on shelves, desks, tables or other similar places**  
Unit may fall due to vibration or tilting, and may cause injury and electric shock.
- **Moving the unit with the caster can be done on a sturdy and even floor. To move the unit on a mat, carpet, or places with uneven surface, carry the unit by its handle.**



# Operation

## Starting Operation

### 1 Securely insert the power plug to the outlet

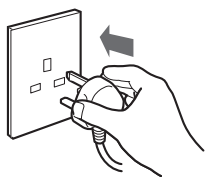

### 2 Press the power button

Operation will start, and indicator will light up.

Pressing the  power button while the unit is operating will dim the indicator and stop the operation of the unit.

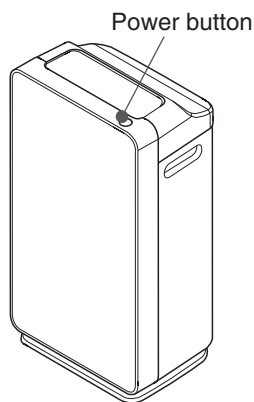

- After all indicators have light up at once, “Auto” will light up.
- For the first 3 minutes, the unit will check and store the condition of the room air. During that time, the “Air Sensor” will flash a green light.



- “Air Purify” mode is set as a factory default.
- From the second use onward, the memory function enables operation based on the saved status. → (P.E-21)
- For power saving, the display and operation panel other than the notification display and the air sensor will turn off approximately one minute after the unit stops operating.

## Standby Power Consumption

- As long as the power plug is inserted in the outlet, the unit consumes approximately 2W of power, even if the unit is not in use.  
(Unplug from the outlet if the unit will not be used for an extended period of time.)

## Switching Airflow Rate

- Each time  button is pressed while the unit is operating, the mode switches in the following order.

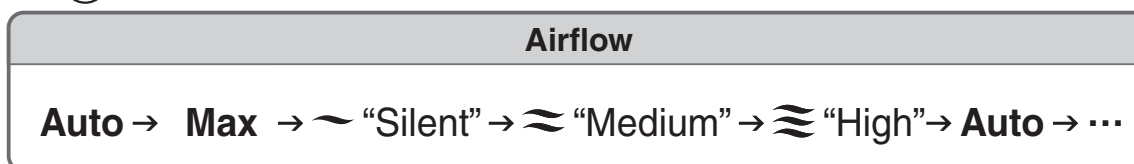

# Useful Features

## Operating in Option

### Pollen

Once every hour, room air will be forcefully circulated in “High” airflow rate. Sensitivity of odor and dust sensors will increase, and depending on the level of air contamination, the unit will operate in either “High” or “Medium” airflow rate. The flap direction will be diagonal.

Use this when worried about pollens getting into the air.

### Odor

Once every hour, room air will be forcefully circulated in “High” airflow rate. Sensitivity of odor sensor will increase, and depending on the level of air contamination, the unit will operate in either “High” or “Medium” airflow rate.

Use this regularly for environments with strong odors such as garbage, drainage, pet and other similar odors.

### **eco** (Eco Saving Operation)

The unit automatically stops operation when the air becomes clean, saving electricity cost. → (P.E-19)

### Rapid

For the first hour, the unit operates in “High” airflow rate, and depending on the level of air contamination, the unit will operate in either “High” or “Medium” airflow rate. For approximately 8 hours, room air will be forcefully circulated in “High” airflow rate for approximately 10 minutes once every hour. Sensitivity of odor sensors will increase, and depending on the level of air contamination, the unit will operate in either “High” or “Medium” airflow rate. Afterwards, high-speed will be deactivated and the airflow rate will return to its previous “Auto” operation mode.

Use this when grilling, cooking hot pot, or in similar instances where the room is exposed to a great deal of strong odor.

### Absence

The unit will operate on “Max” airflow rate for the first five minutes (flap direction: upward), then it will operate for about 55 minutes in “High” airflow rate (flap direction: swing (30 minutes) upward), and the unit will stop operating afterwards.

Use this to clean the room air while away.

### PM2.5 sensor

Switch to sensing that is suitable for small particles, like PM2.5 (general term for micro particles below 2.5μm).

→ (P.E-19)

Touch the  Option button

① You can select Option while operating.

② The Quick Cycle will be switched at each touch.

No Display (Clear) → Pollen → Odor → **eco** → Rapid → Absence → PM2.5 sensor

↑  
(If it returns to No Display (Clear), it is in [Auto] airflow)

# Eco Saving Operation

- The unit automatically stops operation when air becomes clean, saving electricity cost.  
Also, if this status continues for longer than 8 hours, the unit will automatically stop operating.

## Normal Auto Operation

When the air is clean, the unit will continuously operate in “Silent” airflow rate and not stop.

## Eco Saving Operation

When the air is clean and “Silent” airflow rate operation continues for 10 minutes or longer, the fan stops for about 50 minutes and the unit intermittently operates using “Silent” for about 10 minutes.

If this status continues for longer than 8 hours, the unit will automatically stop operating.

\* During eco saving operation, the level of air contamination is detected by the odor and dust sensors. When the sensors detect odors and dust, the airflow rate will switch depending on the level of air contamination.

When the air is clean and the “Silent” airflow rate operation continues for 10 minutes or longer, the unit will start intermittent operation again.

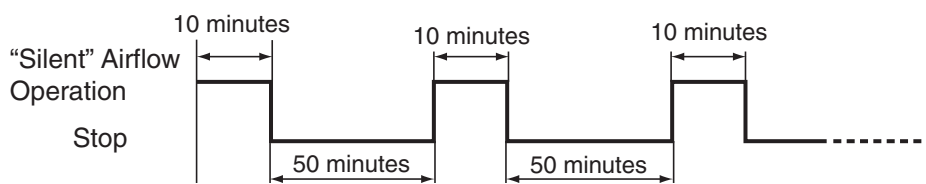

# PM2.5 Sensor

- Change into a sensor that is suitable for small particles, like PM2.5 (general term for micro particles below 2.5µm). The level of contamination in the air will be detected by the dust sensor, and the unit will operate automatically between “Medium” to “Max” airflow rate.  
(Odor sensor control will not be performed)

### Note

- Operation modes other than “Air Purify” cannot be set.
- While operating in PM2.5 sensing, the air sensor will light up, then enlarge and shrink slowly.
- For the first 90 seconds of operation, the unit will operate in “Max” airflow rate (air sensor: red).
- The flap direction will be diagonal.
- It will not respond to the switching of sensor sensitivity. → (P.E-22)

# Stopping Operation Using Off-timer

- Set the off-timer to automatically stop the unit after the set operation time.

Touch  Timer to set the timer.

At each touch the following display will be appear on the display for setting.

No Display → 4hr  
↑

Display	Setting Description
No Display	Not Set
4hr	Automatic stop after about 4 hours of operation

# Useful Features (Continued)

## Setting the Lock

- Prevents accidental operation by children through restricting the operation.
- This can be set while the unit is operating.  
The same process goes for unlocking the unit.

### 1 Long-press **MENU** for about 3 seconds

Lock

- After long-pressing **MENU** for about 3 seconds, a buzzer will ring once (beep) and the child lock indicator will lit.

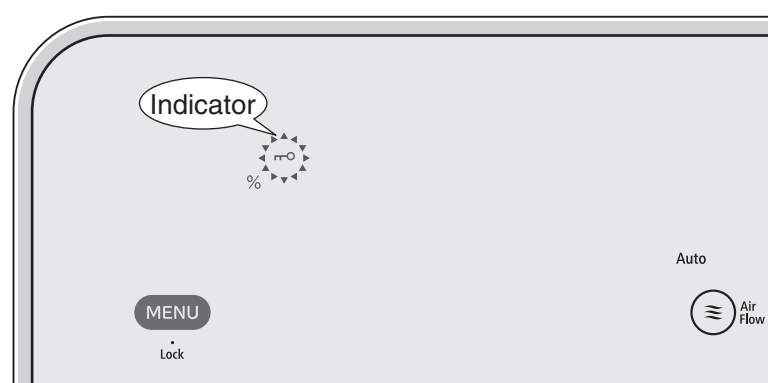

- To cancel the child lock, long-press **MENU** for about 3 seconds. Then the buzzer will ring twice (beep, beep), and the child lock will be canceled.
- Each time **MENU** is long-pressed for about 3 seconds, the child lock be set or cleared.  
The light will go off when the child lock is canceled.

#### Note

- After setting "Lock", no other buttons can be used except the power button and **MENU**.
- In the event of a power interruption, restoring the power does not deactivate the child lock setting, even after pressing the power button and after removing the power plug from the outlet. Hold **MENU** for 3 seconds and cancel the settings.

## Memory Function

- ## Air Sensor

- Dirtiness Level: Clean ←.....→ Dirty



- When the unit is placed in a location where contamination is difficult to detect, or when the sensor needs cleaning, the display may not change. → **(P.E-24)**
- While operating in PM2.5 sensing, the air sensor display lights up and then blinks slowly.

## Odor Sensor

- The sensor detects odors in the air such as cigarette smoke or pet odors. Even if you think the air is clean, the unit may continue the operation if the odor sensor detects any gas component that has not been removed by the filter. Also, any of the following may be detected by the odor sensor.
  - Combustion gases from heating appliances during use, alcohol, odor of perfumes or cosmetics used in beauty parlors or aesthetic salons, sprays, vapors, abrupt temperature changes, etc.

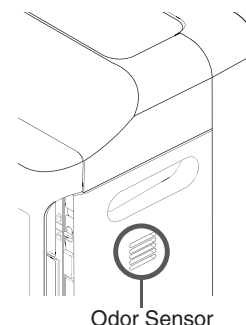

## Dust Sensor

- The dust sensor may fail to sense dust stirred up when you lay out or put away bedding, which contains significantly fewer contaminants than cigarette smoke, etc. In such a case, the air sensor display may appear to be different from the apparent dust in the air.

- The dust sensor may not function properly if the sensor is dirty.  
Carry out periodical cleaning of the dust sensor and the parts around it. → **(P.E-24)**

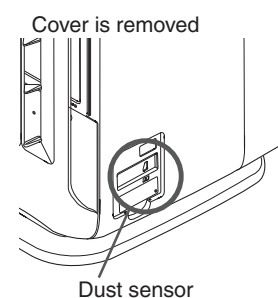

# Memory Function / Sensors / Auto Detection (Continued)

## Auto Detection

- The air purifier performs automatic operation by detecting room air contamination using the “Odor Sensor” and “Dust Sensor”.

During the first 3 minutes after the power is turned on, the unit will check the air condition of the room.

- The purifier operates even while it checks the air condition of the room.

During this time, the “Air Sensor” flashes green.

- After checking the air condition, the “Air Sensor” will display the room air contamination using the “Odor Sensor” and the “Dust Sensor”.

- If you plug in the power cord in an environment containing contaminated air, the sensitivity of the sensor may be reduced.

To clean the air of the room, operate in “High” or “Max”. Or open a window and unplug the power cord from the AC outlet when ambient air is clean and plug it back in after 10 seconds.

## Adjusting Sensory Sensitivity Setting

- Sensitivity of the “Odor Sensor” and “Dust Sensor” which performs automatic switching of airflow rate can be adjusted in 3-step fashion.

You can adjust the sensor sensitivity setting as desired.

- The “Odor Sensor” and “Dust Sensor” are similarly adjusted.

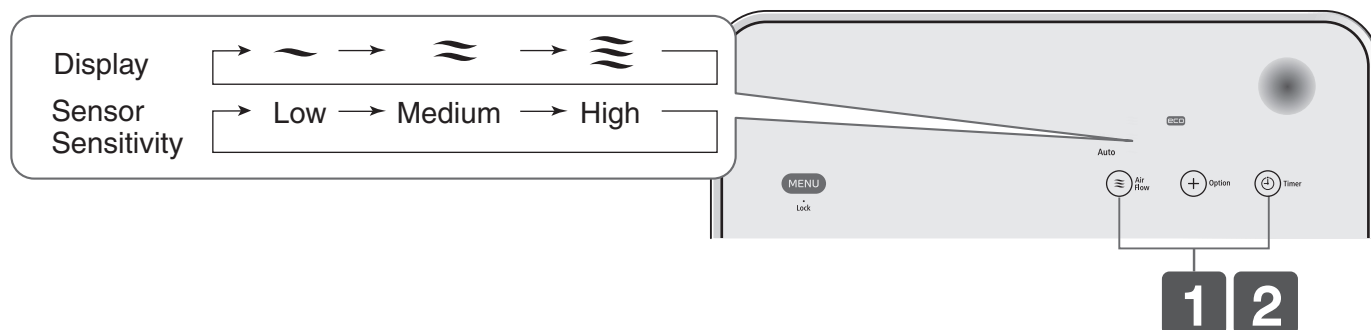

### 1 While pressing , long-press for about 3 seconds

- The current sensitivity is indicated and displayed. (Factory setting is )

### 2 While the sensitivity is being displayed (about 10 seconds), continue long-pressing for about 3 seconds, while pressing once more.

- The sensitivity display will change from  → .

### 3 Furthermore, when switching sensitivity, repeat procedure 2.

When repeating, the sensitivity display will switch like this  →  →  →  → ...

- About 10 seconds after the sensitivity display has been switched, it will disappear and the selected sensor sensitivity will be set.

#### Note

- Switching the sensor sensitivity is not supported in the “PM2.5 Sensor” cycle. → (P.E-19)

# Cleaning



## WARNING

- Do not stop operation by unplugging the power plug. Otherwise, it may cause fire, electric shock or unit failure.



## CAUTION

- Do not splash water on the unit. Doing so may cause a unit failure.
- Do not use volatile solvents, such as gasoline, thinner, benzene, wax, kerosene, alcohol, etc. or polishing powder, or detergent (used for kitchen or laundry). Such chemicals could cause deformation, discoloration, damage or removal of print labels.
- When using a chemically treated cloth, follow safety instructions.
- Do not use a dryer or heater to dry the unit. Heating could cause deformation, discoloration, damage or removal of print labels.
- Lay a soft cloth or similar material beneath and around the purifier body to protect the floor against scratches and from getting wet.
- Do not tilt or tip over the unit.

## Pre-filter, Filter

Clean the pre-filter and filter frequently because dust and dirt get on them.

1

### Check if the operation has stopped before removing the power plug from the socket

- While operating, press the  power button and stop operation.

2

### Remove the rear panel, pre-filter and filter → (P.E-14)

3

### Cleaning

#### Pre-filter

- Remove dust using a vacuum cleaner.
  - Lightly clean using the nozzle brush of the vacuum cleaner and vacuum the dust.
- Remove dirt by washing with water.
  - If it is extremely dirty, wash it with water and a soft sponge without using excessive force. Drain well and let it dry in a well-ventilated area away from direct sunlight.

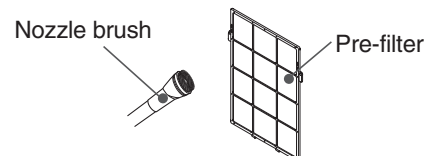

Note: Clean the back face as well.

#### CAUTION

- The stainless coating of the surface will peel off if it is rubbed with the floor nozzle of a vacuum cleaner or a scrub.
- Do not use detergent (kitchen or laundry use) for cleaning.

#### Filter

- The dust on the filter may emit an odor.
  - Be sure to remove the dust using a vacuum cleaner or the like.
  - Lightly clean using the nozzle brush of the vacuum cleaner and vacuum the dust.

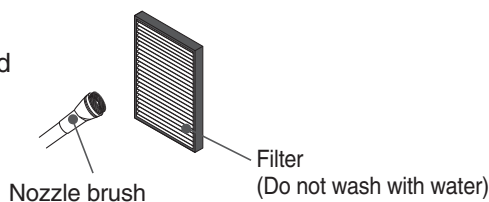

#### CAUTION

- Do not put excessive force and deform the filter.

4

### Attach the filter → (P.E-14)

5

### Attach the pre-filter and rear panel to the unit → (P.E-15)

- The pre-filter is a consumable part.
  - When damaged pre-filter needs to be replaced, purchase the replacement part (Part No. EP-HG50-004). → (P.E-29)

# Cleaning (Continued)

## Purifier (Guide for Cleaning: About Once a Month)

- Wipe off dirt on the unit and glass panel, rear panel, and the surface using a soft, damp cloth.
- Clean adhering chemicals such as oil components and insecticides regularly.
- Remove dust from the surfaces of the rear panel air inlet, dust sensor, odor sensor, using a vacuum cleaner and wipe off using a soft cloth.

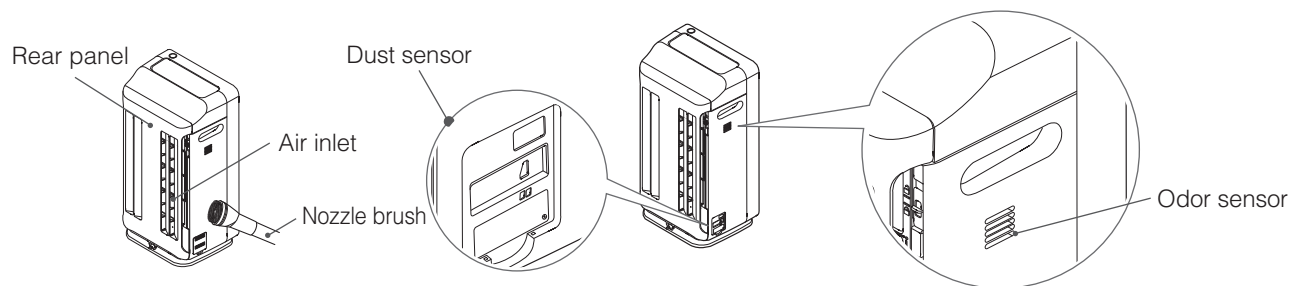
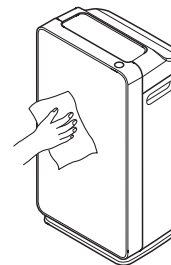

## Dust Sensor (Guide for Cleaning: At Least Once Every 3-6 Months)

- Clean regularly at least once every 3-6 months.  
The dust sensor is less likely to detect dirt in the air if it is not cleaned regularly.  
If the sensor is dirty, it might not work properly and will detect dust even if the air is clean.

### 1 Check if the operation has stopped before removing the power plug from the socket

- While operating, press the  power button and stop operation.

### 2 Remove dust sensor cover and collect the dust

- Place your finger on the lower part and press.
- Remove the dust cover, vacuum well using the nozzle brush of the vacuum cleaner, and wipe using a soft cloth.

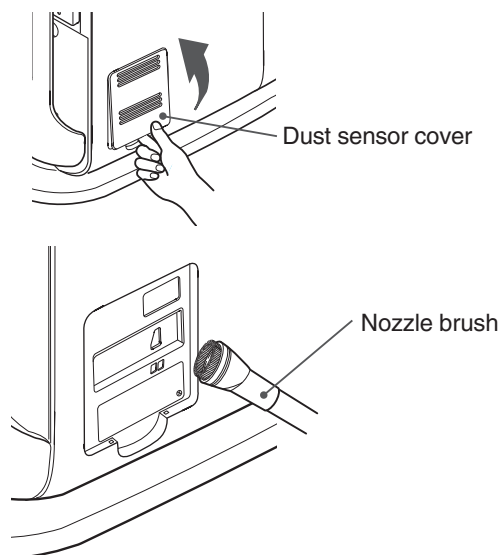

### 3 Wipe the lens with a cotton swab (commercial product)

- When dirt is difficult to remove, wipe the lens with a cotton swab slightly moistened with water, then wipe with a dry cotton swab after.
- Remove all dust around the lens.
- After cleaning, attach the dust sensor cover.
- After cleaning, plug the air purifier in a clean environment and turn on in Purify/Auto operation mode. If the Air Sensor does not turn green after about 10 minutes, there might be remaining dust left. Please clean it again.

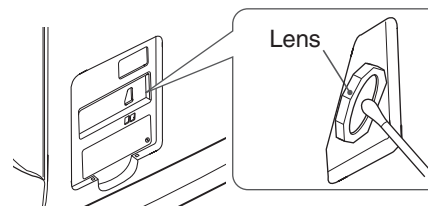

#### CAUTION

- Do not put excessive force on the lens. This may cause damage.
- Do not use excessive force when removing and attaching the tabs of the dust sensor cover. This may cause damage.



# Replacing the Filter

## Replacement Interval

- The filter is disposable. The deodorizing performance of the filter decreases with use.

The standard life of a filter is approximately 10 years as determined by the Japan Electrical Manufacturers' Association.

- A test according to JEM1467(Japan Electrical Manufacturers' Association) was conducted. If 5 cigarettes are smoked per day:

[Filter] Number of years is up to the point the air purifying time takes twice as long as when the filter was new.

\* This is only a guide. It differs from the actual use in an average household.

- The filter should be replaced immediately if its color resembles any of the colors on the dirtiness label attached to the unit.

- The colors on the dirtiness label only serve as a guide. Depending on the installation location, the actual color of the contaminated filter may differ from the color on the label.

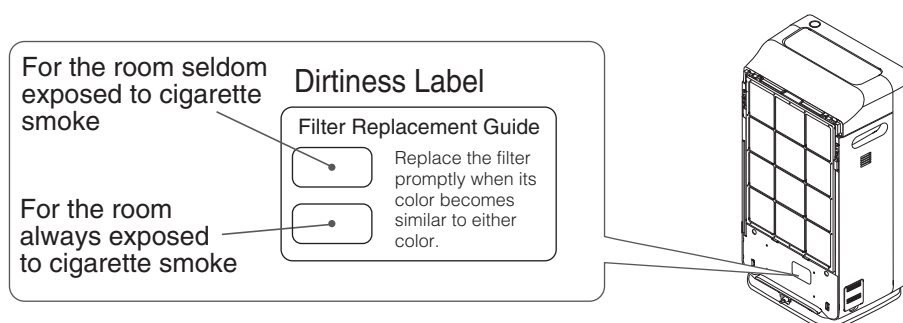

- Replace the filter when it becomes difficult to remove odor.
- Depending on the location and usage, it may also be shortened. If it becomes difficult to remove dust or odor, replace the filter immediately. Otherwise, the filter may generate odors.
- The following cases will shorten the life of the filter:
  - When the purifier takes in oily smoke, carbon substances (soot), etc. or when the smell of new building materials remains after the construction or remodeling of a building
  - When used in stores, such as in coffee shops, game parlors, barber shops, beauty parlors, hotels, inns, and offices
  - When used in places with strong smells such as cigarettes, barbecue, aroma oils, or air fresheners
  - When the purifier takes in combustion gases generated by heating appliances
  - When the purifier takes in solvents such as paints, adhesives, etc.
  - When used in dusty locations near roads subject to heavy traffic.

## Handling the Filter

- Make sure to take the filter out of its plastic cover before using.
  - Do not set the filter while it is still inside the plastic cover. This may cause a unit failure.
- Avoid handling it roughly.
  - Do not crush, crumple, or roll the filter.  
When the filter is broken, it will not have any cleaning effect.
- Do not wash the filter.
  - The filter cannot be reused even after washing. Please buy and replace it with a new filter.
- The filter contains plastic. Dispose of the filter according to local regulations.

# Replacing the Filter (Continued)

## How to Replace the Filter

1

Check if the operation and the fan have stopped, and then unplug the power cord

- While operating, press the  power button and stop operation.

2

Remove the rear panel and pre-filter → (P.E-14)

3

Remove the old filter → (P.E-14)

**CAUTION**

- Do not put excessive force and deform the filter.

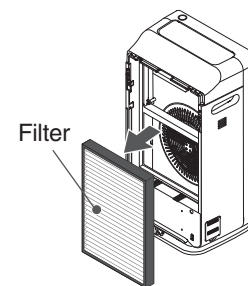

4

Remove the plastic packaging of the new filter, and attach the filter in the unit



**CAUTION**

- Use only a genuine filter for the Hitachi Air Purifier  
Other filters may cause unit to malfunction.

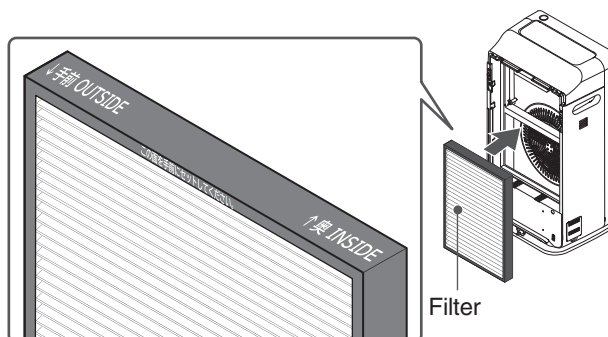

**CAUTION**

- If the filter is set while without removing its plastic packaging, it will not be able to have a cleaning effect. It will also cause unit malfunction.
- The vibration during transporting the unit might cause deodorizing agent granules to fall out from the filter.
  - When removing the plastic cover of the filter and attaching the filter to the unit, make sure that your hands, clothes, and the surroundings does not get dirty.
  - Wipe off any granules that may have fallen or clung to the filter.
  - This will not affect the deodorizing performance.

5

Attach the pre-filter and rear panel to the unit → (P.E-15)

# Troubleshooting Guide

## Before Requesting Repairs

Symptoms	Check	Solution
<b>Air does not come out or it will not turn on</b>	● Is the power plug properly inserted in the outlet?	Insert the power plug properly in the outlet.
	● Is the breaker switched off?	Switch on breaker.
	● Did you turn on the “Power” button on the unit?	Press the “Power” button to turn on.
	● Are the filter correctly installed in the unit?	Install filter correctly in the unit. → (P.E-14, E-15)
<b>It cannot be operated</b>	● Is the child lock set?	Cancel the setting. → (P.E-20)
	● Are there any water droplets or dust on the operation panel?	Wipe off with a soft cloth. → (P.E-6, E-7)
	● Are you wearing any gloves or have bandages?	Touch it directly.
	● Are you touching any other buttons?	Touch one at a time.
<b>The operation stopped mid-way</b>	● Are there any strong impact or is the unit tilted?	Make sure not to subject the unit to strong impacts. Or place it in on a stable, even location.
	● Is it operating in “Absence” or “Eco Saving Operation” cycle?	Switch to other quick cycles. → (P.E-18, E-19)
<b>The airflow rate does not decrease even though the air is clean</b>	● Is the airflow rate switched?	Touch Airflow Level button and select Auto or another airflow rate. → (P.E-17)
<b>The airflow rate does not increase even though the air is contaminated</b>	● Is the airflow rate switched?	Touch Airflow Level button and select Auto or another airflow rate. → (P.E-17)
	● Is the odor sensor opening blocked by dust or any other objects?	Clean the odor sensor. → (P.E-24)
	● When the power plug is in the outlet, did the air around become clean?	Switch the airflow rate. → (P.E-17) Or open a window, unplug the power plug from the outlet when the surrounding air becomes clean, and plug it in again after 10 seconds. → (P.E-22)
<b>The air sensor display color does not change from green</b>	● Is the unit placed in a location where it cannot be reached by odors and dust?	Try moving it to another location.
	● Is the dust sensor dirty?	Clean the dust sensor. → (P.E-24)
	● Is the odor sensor opening blocked by dust or any other objects?	Clean the odor sensor. → (P.E-24)
<b>The air sensor display color does not change from red</b>	● Is there anything nearby that the odor sensor may detect? ● Heating appliances that generate combustion gases ● Alcohol, cosmetics, sprays, etc.	The purifier may detect components of invisible gas that cannot be cleaned by the filter and still continue operating. Open a window for ventilation. → (P.E-22)
	● Is the dust sensor dirty?	Clean the dust sensor. → (P.E-24)
	● Is the odor sensor opening blocked by dust or any other objects?	Clean the odor sensor. → (P.E-24)
<b>It is hard to remove the smell or the unit has a smell</b>	● Is the pre-filter too dirty?	Refer to “Pre-filter” in “Cleaning” when cleaning the pre-filter. → (P.E-23)
	● Is the filter dirty? Or is it time to replace the filter?	Refer to “Replacing the Filter” when replacing the filter. Depending on the location or usage, the replacement interval may be shorter. → (P.E-25)
<b>The airflow rate switched in the middle of operation</b>	● Is it set in “Auto” airflow rate, or “Pollen” or “Eco Saving Operation” quick cycles?	Switch airflow rate and quick cycle. → (P.E-17 - E-19)
	● Are the rear panel, filters correctly set?	Set them correctly.

# Troubleshooting Guide (Continued)

## Following Conditions are Normal

### Sounds and Vibrations

Symptoms	Cause (This is normal)
The flap makes whirring, rattling, and rumbling noises when it is opened, closed, or in swing mode	It is the sound of the motor that moves the flap.
The unit vibrates when it is on "Max" airflow rate.	It is because of the rotation of the fan.
When switching the operation mode or airflow rate, the purifier sometimes makes whirring and whirling sounds	This is the sound of the unit changing the rotational speed of the motor.

### Heat and Smells

Symptoms	Cause (This is normal)
The air coming out of the air outlet smells	The unit's parts have a smell when it is first used. Or the deodorizing performance of the filter has decreased. Clean the filter. → (P.E-23)
The Touch Operation Panel is warm	The unit's interior is lined with control circuits. This causes the unit to become warm.

### Operations / Others

Symptoms	Cause (This is normal)
The movement of the flap is unstable, or its direction is misaligned	It may have become misaligned when it was moved by hand. If it does not work properly because it was moved by hand, stop it by pressing the "Power" button once, and start the operation again.
The fan stopped	The fan may stop if it is set in eco saving operation. → (P.E-18, E-19)
The rotation does not increase smoothly when "Max" airflow rate is used	The rotation gradually increases. It takes approximately 1 minute for the rotation to increase.
Noise enters the television and radio	Separate the purifier from the television and radio, or change the orientation of the purifier. Or, use an outlet in a different location.
The touch operation panel display disappeared	For power saving, the display and operation panel other than the notification display and the air sensor will turn off approximately one minute after the unit stops operating.

## Alert Display

Symptom	Cause
All airflow indicators ~ ≈ ≡ are blinking.	Faulty fan rotation.

Stop the operation, unplug the power cord from AC outlet and contact your dealer for service.

# Replacement Parts

Purchase from Hitachi Home Appliances dealers.

- **Filter assembly for Hitachi Air Purifier (Allergen-free, HEPA filter)**  
EPF-G60H

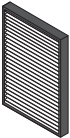

- **Pre-filter**  
Specify service part EP-HG50-004.

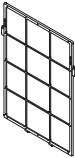

# Specifications

Power Supply	AC 220-240V 50-60Hz			
Applicable Floor Space	53m <sup>2</sup>			
	Max	High	Medium	Silent
Airflow Rate (m <sup>3</sup> /min.)	7.0	4.0	2.7	1.1
Power Consumption (W)	50	13	8	6
Unit Dimensions	669mm (H) × 360mm (W) × 254mm (D)			
Weight	Approx. 10.5kg			
Power Cord Length	Approx. 1.8m			

