

# LCD Projectors

# HITACHI

Inspire the Next

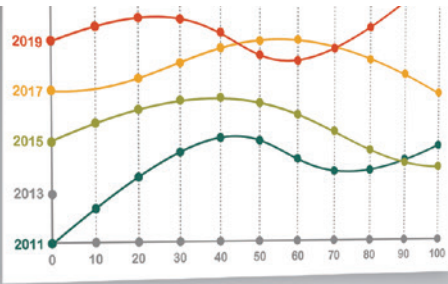

## Lineup of easy-to-use projectors to meet your applications.

\*Projected images are simulations



\*CP-EX353 and CP-EX303 do not support AMX Device Discovery and Crestron Connected.

### LINE UP

\*Local availability may be limited.

Network model	CP-EW4051WN WXGA 4,000lm	CP-EW3551WN WXGA 3,800lm	CP-EW3051WN WXGA 3,200lm	CP-EX4551WN XGA 4,500lm	CP-EX3551WN XGA 3,700lm	CP-EX3051WN XGA 3,300lm
Basic model	CP-EX353 XGA 3,700lm	CP-EX303 XGA 3,300lm				

#### ACCENTUALIZER and HDCR

Network model

ACCENTUALIZER makes pictures look more real by enhancing shade, sharpness, and gloss to make pictures clearer. The HDCR function corrects blurred images caused by room lighting or outside light sources, and creates an effect similar to increasing contrast resulting in clear images even in bright rooms.

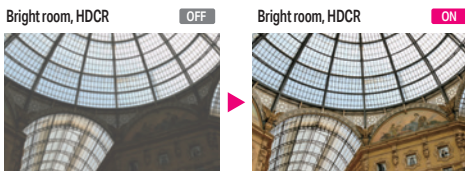

#### IMAGE OPTIMIZER

Network model

Equipped with IMAGE OPTIMIZER that maintains visibility of an image through automatic image correction in accordance with lamp consumption.

\* This function may not work properly when HDCR/ACCENTUALIZER is ON.  
\* Comparison photos are simulations.

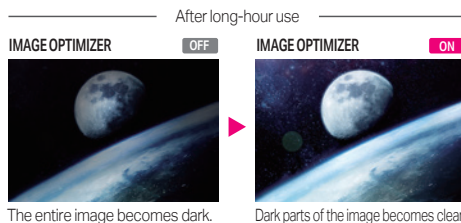

#### Perfect Fit

Network model

Equipped with Perfect Fit with which the position of four corners and four sides of a projected image can be adjusted. With the remote controller at hand, you can quickly correct the distorted image such as pincushion or barrel.

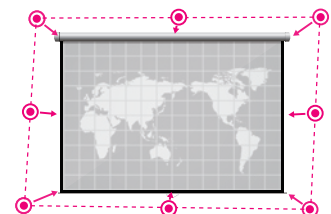

## Network Function / Capability

#### Wireless Capability (Option)

Network model

The projector is capable of a wireless network with the optional USB wireless adapter. You can control the projector with a computer via the network, and also project the screen of the computer on which the LiveViewer software is installed.

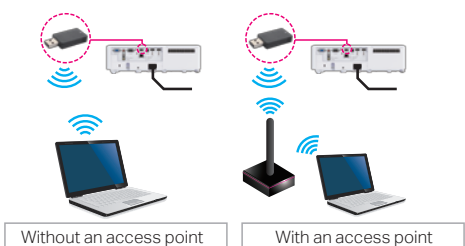

#### Smart Device Control

Network model

Using the dedicated free online application Projector Quick Connection, you can control the projector from a tablet or smartphone. In addition, you can project images, documents, and photos on the smart device.

\*Projector need to be connected to network.  
\*See the Hitachi website for details.  
[http://www.hitachi.co.jp/proj/en/apps/pj\\_connection.html](http://www.hitachi.co.jp/proj/en/apps/pj_connection.html)



\*This picture shows an example of network connection using optional wireless adapter.

#### Moderator Control Mode

Network model

Setting one computer from the multiple computers (up to 50\*) that are connected to the projector as the moderator (host) makes it possible for the moderator to project from the other computers (clients).

\*1 Image and audio transfer speed may vary depending on number of computer connected.

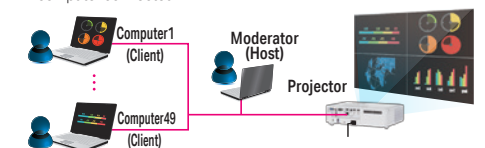

\*To secure better performance, a wired network is preferable. Required to install the LiveViewer software on all the computers. The functions are supported by LiveViewer (Windows® application) only.

\*The software LiveViewer can be downloaded from the website.  
<http://www.hitachi-america.us/projectors>  
<http://www.hitachidigitalmedia.com/>  
<http://www.hitachi.co.jp/proj/en/>

#### Other Useful Features

Network model

Basic model

• Internal speaker\*2 • Direct Power On / Off • DICOM® simulation mode\*3 • Audio Pass Through • My Screen • PIN Lock System

\*2 The network model has a 16w speaker. The basic model has a 1W speaker. \*3 This projector is not a medical device and is not compliant with the DICOM® standard, and neither the projector nor the DICOM® Simulation Mode should be used for medical diagnosis.

Notes • Comparison photos are simulations. • The images in this catalog are representations of the effects and differ from actual images.

Specifications									
Model name		CP-EW4051WN	CP-EW3551WN	CP-EW3051WN	CP-EX4551WN	CP-EX3551WN	CP-EX3051WN	CP-EX353	CP-EX303
Display system		3LCD							
Display device	Size of effective display area	0.59", aspect ratio 16 : 10				0.63", aspect ratio 4 : 3			
	Number of pixels	1,024,000 pixels H : 1280 × V : 800 (WXGA)				786,432 pixels H : 1,024 × V : 768 (XGA)			
Lens	Zoom					Manual (1.2×)			
	Focus					Manual			
Light Source		230W Lamp							
Screen size		30 - 300 inch							
Light output (Brightness)*1		4,000lm	3,800lm	3,200lm	4,500lm	3,700lm	3,300lm	3,700lm	3,300lm
Contrast ratio (full white / full black)*2		20,000 : 1							
Speaker		16W × 1 mono						1W × 1 mono	
Display	Horizontal	15 - 106 kHz							
Scanning frequency	Vertical	50 - 120 Hz							
Display	Computer	VGA, SVGA, XGA, WXGA, WXGA+, SXGA, SXGA+*3, WSXGA+*4, UXGA, Full HD, Mac16"							
Resolution	Video	NTSC, NTSC4.43, PAL, SECAM, PAL-M, PAL-N, PAL(60Hz), 480i@60, 480p@60, 576i@50, 576p@50, 720p@50/60, 1080i@50/60, 1080p@50/60							
Terminals	COMPUTER IN	Mini D-sub 15-pin connector × 2							
	MONITOR OUT	Mini D-sub 15-pin connector × 1 (shared wit COMPUTER IN2)							
	VIDEO IN	RCA connector × 1							
	HDMI IN	HDMI (HDCP compliant) × 2						HDMI (HDCP compliant) × 1	
	AUDIO IN	3.5mm stereo mini connector × 2, RCA connector L / R × 1						RCA connector L / R × 1	
	AUDIO OUT	3.5mm stereo mini connector × 1							
	CONTROL (RS-232C)	D-sub 9-pin connector × 1							
	LAN	RJ-45 connector × 1						-	
	USB-A	USB type A × 1 (PC-LESS presentation or Wireless adapter (option))						-	
	USB-B	USB type B × 1 (USB display*5 or USB mouse control)						-	
Operating temperature		0 - 35°C							
Operating humidity		10 - 90%RH (non-condensing)							
Power requirements		AC 100V - 120 (50/60Hz) : 3.3A, AC 220V - 240V (50/60Hz) : 1.6A						AC 100V - 120 (50/60Hz): 3.0A, AC 220V - 240V (50/60Hz): 1.5A	
Power consumption		AC 100V - 120 (50/60Hz) : 320W, AC 220V - 240V (50/60Hz) : 310W						AC 100V - 120 (50/60Hz): 290W, AC 220V - 240V (50/60Hz): 280W	
Standby mode power consumption		0.35 W at saving mode*6							
Standard outside dimensions (W × H × D)		355 × 106 × 267mm (14.0" × 4.2" × 10.5") (Including protruding parts), 349 × 88 × 264mm (14.0" × 3.5" × 10.4") (Excluding protruding parts)							
Weight		Approx. 3.5kg (7.7 lbs)						Approx. 3.4kg (7.5 lbs)	
Accessories		Power cord, Computer cable, Remote control, AA batteries, Lens cover*7, Adapter cover*7, Security label, User's manual (Book)							
Option Parts	USB Wireless Adapter	USB-WL-5G*8						-	
Lamp : DT02081, Filter set : UX39561, HAS-EX300 (Bracket for ceiling mount), HAS-104S (Slim adapter for fixing mount), HAS-204L (Standard adapter for fixing mount), HAS-304H (Long adapter for fixing mount)									

\* When PICTURE MODE is set to DYNAMIC, ACTIVE IRIS is set to OFF, and ZOOM position is WIDE (max). \* When PICTURE MODE is set to DYNAMIC, ACTIVE IRIS is set to ON, and ZOOM position is WIDE (max). \* Only for CP-EX4551WN, CP-EX3551WN, CP-EX3051WN, CP-EX353 and CP-EX303. \* Only for CP-EW4051WN, CP-EW3551WN and CP-EW3051WN. \* OS: 6.0 SAVING mode disables the functions of MONITOR OUT, AUDIO OUT, speaker sound, network communication, RS-232C control except POWER ON command, etc. in standby. \* Only for CP-EW4051WN, CP-EW3551WN, CP-EW3051WN, CP-EX4551WN, CP-EX3551WN and CP-EX3051WN. \*8 The availability of the USB-WL-5G varies depending on the country and the region.

Projection Distance

On a horizontal surface

CP-EW4051WN / CP-EW3551WN										
(1,280 × 800) (±10%)										
a Screen size (diagonal)		16 : 10 screen								
		b projection distance				c1 Screen height		c2 Screen height		
type		min.		max.						
(inch)	m	inch	m	inch	m	inch	cm	inch	cm	inch
60	1.5	1.9	73	2.2	88	75	30	6	2	
80	2.0	3.1	99	3.0	119	100	39	8	3	
100	2.5	3.1	124	3.8	149	125	49	10	4	
120	3.0	3.8	149	4.6	180	155	59	12	5	
150	3.8	4.8	187	5.7	226	188	74	14	6	
200	5.1	6.4	251	7.7	302	250	98	19	8	

CP-EW3051WN

(1,280 × 800) (±10%)

a Screen size (diagonal)	16 : 10 screen									
	b Projection distance						c1 Screen height		c2 Screen height	
	type		min.		max.					
	(inch)	m	m	inch	m	inch	cm	inch	cm	inch
60	1.5		1.9	73	2.2	88	75	30	6	2
80	2.0		2.5	98	3.0	119	100	39	8	3
100	2.5		3.1	124	38	149	125	49	10	4
120	3.0		3.8	149	46	179	150	59	12	5
150	3.8		4.7	187	57	225	188	74	14	6
200	5.1		6.4	250	76	301	250	98	19	8

CP-EX4551WN											
(1,024 × 768) (±10%)											
a Screen size (diagonal)		4:3 screen									
		b Projection distance				c1 Screen height		c2 Screen height			
type		min.		max.		cm		inch			
(inch)	m	m	inch	m	inch	cm	inch	cm	inch		
60	1.5	1.7	69	2.1	83	78	31	13	5		
80	2.0	2.4	93	2.8	112	105	41	17	7		
100	2.5	3.0	117	3.6	141	131	51	22	9		
120	3.0	3.6	141	4.3	170	157	62	26	10		
150	3.8	4.6	177	5.4	213	196	77	33	13		
200	5.1	6.0	237	7.2	285	261	103	44	17		

CP-EX3551WN / CP-EX3051WN / CP-EX353 / CP-EX303										
(1,024 x 768) (±10%)										
a Screen size (diagonal)	4 : 3 screen									
	b Projection distance						c1 Screen height		c2 Screen height	
	type		min.		max.					
(inch)	m	inch	m	inch	m	inch	cm	inch	cm	inch
60	1.5	1.7	69	2.1	83	78	31	13	5	
80	2.0	2.4	93	2.8	112	105	41	17	7	
100	2.5	3.0	116	3.6	140	131	51	22	9	
120	3.0	3.6	140	4.3	169	157	62	26	10	
150	3.8	4.6	176	5.4	212	196	77	33	13	
200	5.1	6.0	236	7.2	284	261	103	44	17	

b : Projection distance (from the projector's front panel to screen. Tolerance  $\pm 10\%$ )    c1 : Screen height from lens center to top (when installed on a horizontal surface)    c2 : Screen height from lens center to bottom (when installed on a horizontal surface)

## Dimensions

**[Top view]**

267mm (10.5")  
264mm (10.4")

**[Front view]**

355mm (14.0")  
349mm (13.7")  
106mm (4.2")  
88mm (3.5")

\*The figures above are not drawn to scale.

Environment	
<ul style="list-style-type: none"> <li>► <b>Compliance with EU Directive RoHS<sup>*1</sup></b></li> <li>► <b>Reduction of resin usage in production</b> Use of hot runners in molds for making upper housing in order to reduce mill ends.</li> <li>► <b>Power saving mode engaged during standby</b></li> <li>► <b>Eco mode</b> Eco mode provides power saving.</li> </ul>	<p><sup>*1</sup> RoHS is the acronym of "Directive 2011/65/EU of the European Parliament and of the Council of 8 June 2011 on the restriction of the use of certain hazardous substances in electrical and electronic equipment".</p>

—Design and specifications are subject to change without notice.

- The projected images and comparison photos in this catalog are simulations. • LCD panels, polarizers and other optical components and cooling fans may need replacement after prolonged usage. For more details, please consult a Hitachi sales representative. • Do not use in places where there is a lot of water, dampness, steam, dust, soot or tobacco smoke. This may result in fire or malfunction. • Optical components (lamp, LCD panel, polarizing plate, PBS [polarizer beam splitter]) have limited service lives. They must be repaired or replaced if they are used for a long period of time. • These projectors use a mercury lamp with high internal pressure. Because of its properties, this lamp may burst with a loud noise or burn out if struck or after it has been used for a period of time. The time until it bursts or burns out varies greatly according to differences between lamps and usage conditions. Turning the lamp's power on and off frequently shortens its service life. • Optical components other than the lamp: If the projector is used for six hours or more per day, they may need to be replaced in less than a year. • LCD panel: If the projector is used continuously for six hours or more, its replacement cycle may be shortened. • Do not turn projector on again for ten minutes after shutdown. Neglect can shorten the lifetime or the lamp. During use and immediately after use, do not touch anywhere near the lamp and the vents as these parts are extremely hot.
- Windows® is a trademark, or a registered trademark of Microsoft Corporation in the United States and/or other countries. • Crestron Connected and the Crestron Connected Logo are registered trademarks of Crestron Electronics. • HDMI and High-Definition Multimedia Interface are trademarks or registered trademarks of HDMI Licensing Administrator, Inc. in the United States and other countries. • DICOM is the registered trademark of the National Electrical Manufacturers Association for its standards publications relating to digital communications of medical information. • All other trademarks are the properties of their respective owners.

# HITACHI

<b>Hitachi America, Ltd., Digital Media Division</b>	2420 Fenton Street, Suite 200 Chula Vista, CA 91914, U.S.A. and Canada Tel: +1-800-448-2244 <a href="http://www.hitachi-america.us/digitalmedia">www.hitachi-america.us/digitalmedia</a>
<b>Hitachi Home Electronics Asia (S) Pte. Ltd.</b>	438A Alexandra Road #01-01/02/03, Alexandra Technopark, 119967, Singapore Tel: +65-6536-2520 <a href="http://www.hitachiconsumer.com.sg">www.hitachiconsumer.com.sg</a>
<b>Hitachi Sales (Malaysia) Sdn. Bhd.</b>	Lot 12, Jalan Kemajuan, Bangli Industrial Estate, 43650 Bandar Baru Bangli, Selangor Darul Ehsan, Malaysia Tel: +60-3-8911-2670 <a href="http://www.hitachiconsumer.com.my">www.hitachiconsumer.com.my</a>
<b>Hitachi Sales (Thailand), Ltd.</b>	333, 333/1-8 Moo 13, Bangna-Trad Road km 7, Bangkaew, Bangpluee, Samutprakarn 10540, Thailand Tel: +66-2335-5455 <a href="http://www.hitachi-th.com">www.hitachi-th.com</a>
<b>Hitachi (Hong Kong), Ltd.</b>	18th Floor, Ever Gain Centre, 28 On Mook Street, Shatin, N.T., Hong Kong Tel: +852-2113-8883 <a href="http://www.hitachi-hk.com.hk">www.hitachi-hk.com.hk</a>
<b>Hitachi Sales Corp. of Taiwan</b>	2nd Floor, No.65, Nanking East Road, Section 3, Taipei 104, Taiwan Tel: +886-2-2516-0500 <a href="http://www.hsct.com.tw">www.hsct.com.tw</a>
<b>Hitachi Australia Pty Ltd.</b>	Suite 801, Level 8, 123 Epping Road, North Ryde NSW 2113, Australia Tel: +61-2-9888-4100 <a href="http://www.hitachi.com.au">www.hitachi.com.au</a>
<b>Hitachi Europe Ltd., Digital Media Group Consumer Affairs Department</b>	Whitebrook Park, Lower Cookham Road, Maidenhead, Berkshire, SL6 8YA, UK Tel: +44-844-481-0297 <a href="http://www.hitachidigitalmedia.com">www.hitachidigitalmedia.com</a>
<b>Hitachi Consumer Marketing, Inc.</b>	<a href="http://www.hitachi.com.jp/proj/">http://www.hitachi.com.jp/proj/</a>
<b>Development and Manufacture : Maxell, Ltd.</b>	

2420 Fenton Street, Suite 200 Chula Vista, CA 91914, U.S.A. and Canada Tel: +1-800-448-2244 [www.hitachi-america.us/digitalmedia](http://www.hitachi-america.us/digitalmedia)  
 438A Alexandra Road #01-01/02/03, Alexandra Technopark, 119967, Singapore Tel: +65-6536-2520 [www.hitachiconsumer.com.sg](http://www.hitachiconsumer.com.sg)  
 Lot 12, Jalan Kemajuan, Bangli Industrial Estate, 43650 Bandar Baru Bangi, Selangor Darul Ehsan, Malaysia Tel: +60-3-8911-2670 [www.hitachiconsumer.com.my](http://www.hitachiconsumer.com.my)  
 333, 333/1-8 Moo 13, Bangna-Trad Road km 7, Bangkaew, Bangplee, Samutprakarn 10540, Thailand Tel: +66-2335-5455 [www.hitachi-th.com](http://www.hitachi-th.com)  
 18th Floor, Ever Gain Centre, 28 On Muk Street, Shatin, N.T., Hong Kong Tel: +852-2113-8883 [www.hitachi-hk.com.hk](http://www.hitachi-hk.com.hk)  
 2nd Floor, No.65, Nanking East Road, Section 3, Taipei 104, Taiwan Tel: +886-2-2516-0500 [www.hsct.com.tw](http://www.hsct.com.tw)  
 Suite 801, Level 8, 123 Epping Road, North Ryde NSW 2113, Australia Tel: +61-2-9888-4100 [www.hitachi.com.au](http://www.hitachi.com.au)  
**Hitachi Affairs Department** Whitebrook Park, Lower Cookham Road, Maidenhead, Berkshire, SL6 8YA, UK Tel: +44-844-481-0297 [www.hitachidigitalmedia.com](http://www.hitachidigitalmedia.com)  
<http://www.hitachi.co.jp/proi/>

**NM-E512 092018**