

使用説明書 INSTRUCTIONS

HITACHI
Inspire the Next

日立 G-SWORD 光の刃電鬚刨
HITACHI G-SWORD ROTARY SHAVER

RM-LTX7000DY
RM-LTX7000

只作家居用途
For household use only

交流/充電式兩用
AC/RECHARGEABLE



日本製造
Made in Japan

English Page 1~12

中文 頁 13~24

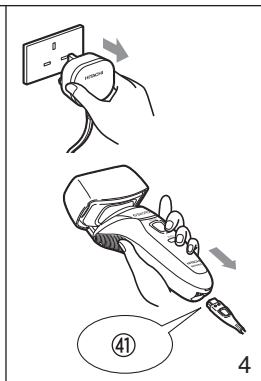
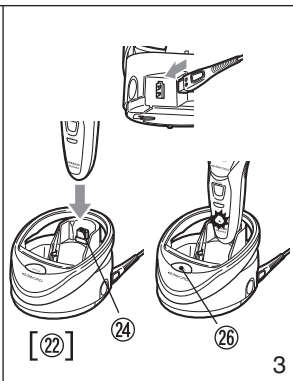
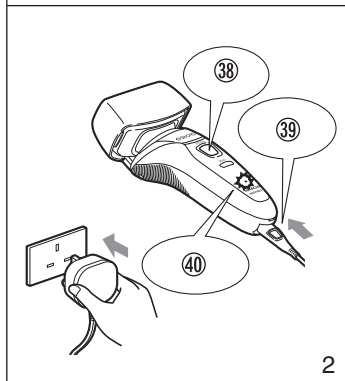
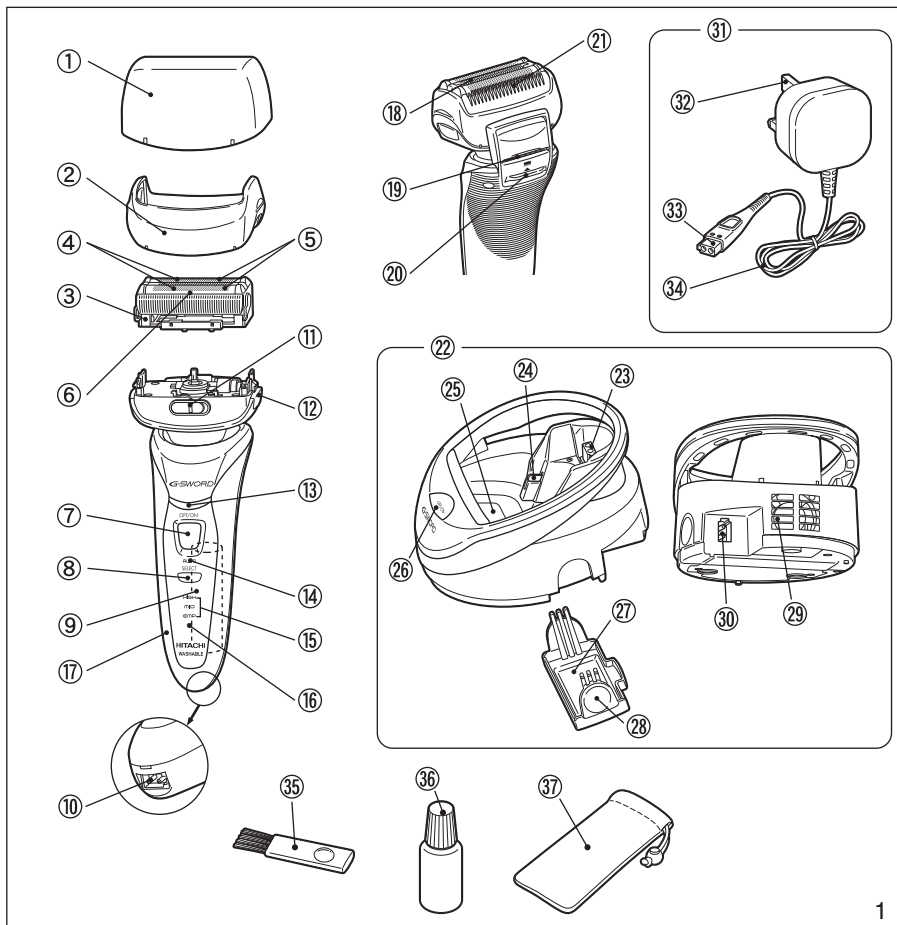

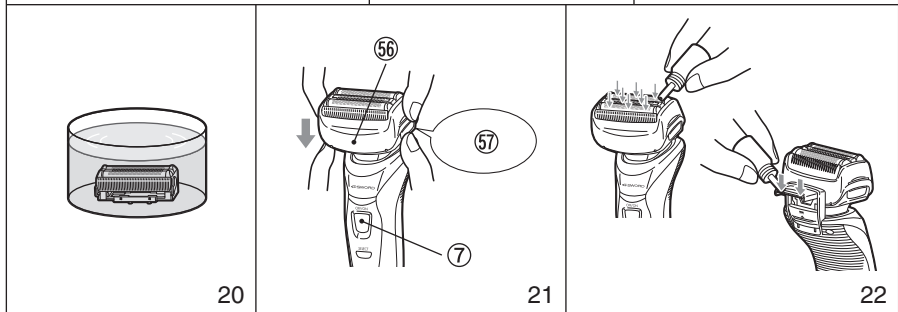
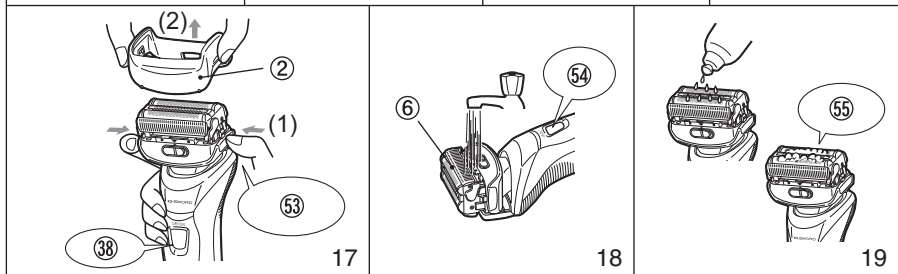
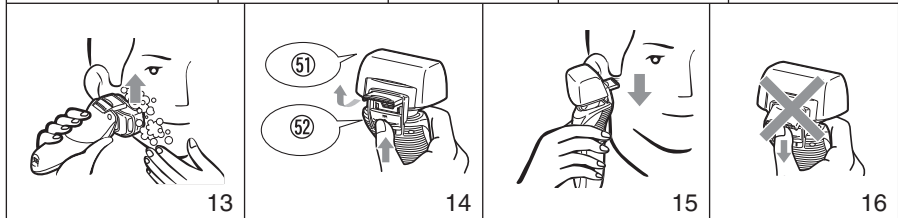
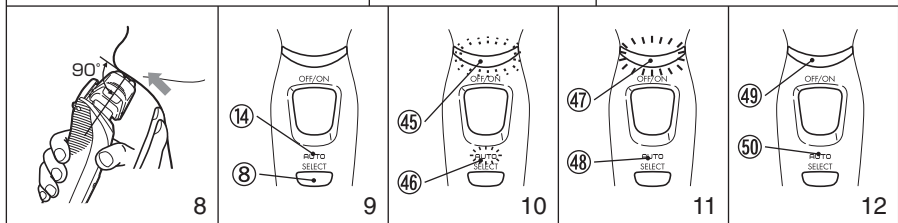
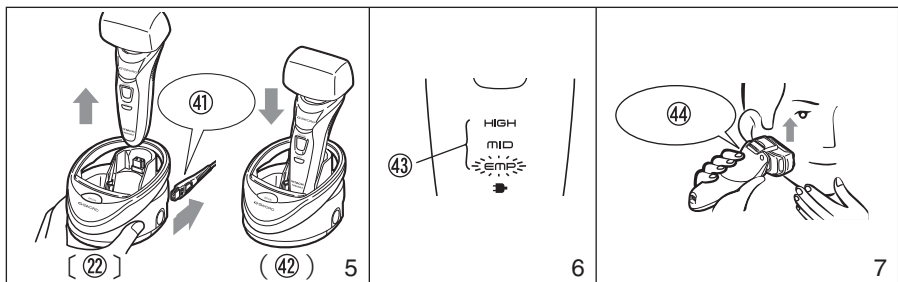

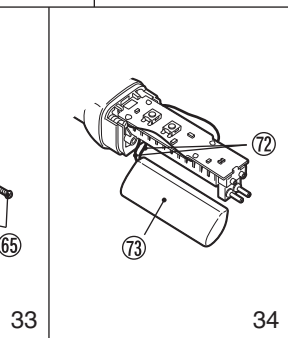
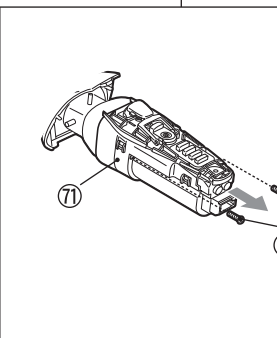
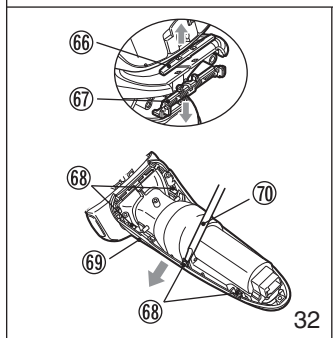
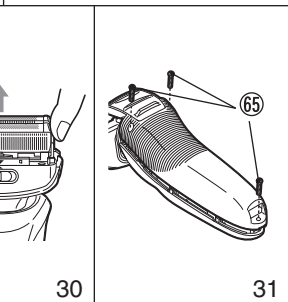
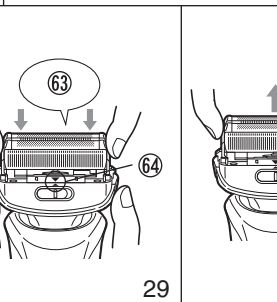
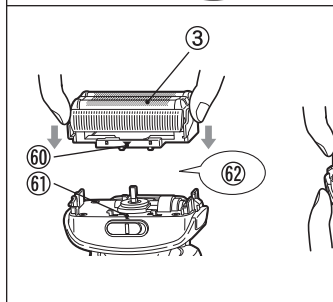
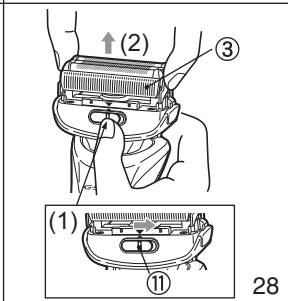
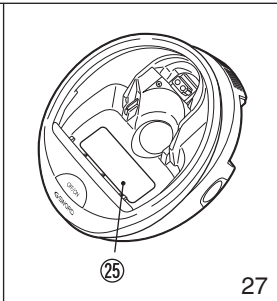
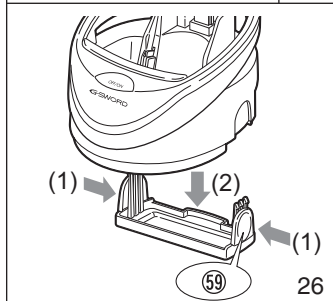
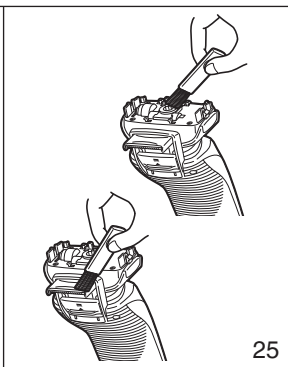
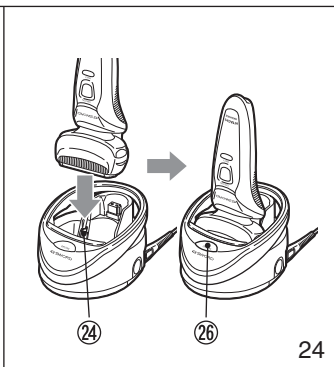
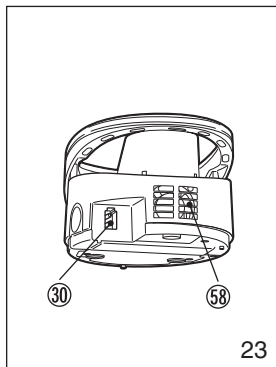











English

Safety precautions

- Items described here are for using the product safely and properly, and to prevent hazards and injury to the user and other persons before they occur.
- Items are classified as follows. All items are important descriptions related to safety, therefore make sure to observe them.



 DANGER	Extent of imminent hazard which has the potential to cause death or serious injury to the user in the case of improper handling.
 WARNING	Extent of hazard which has the potential to cause death or serious injury to the user in the case of improper handling.
 CAUTION	Extent of hazard or damage which has the potential to cause slight injury to the user or damage to property (house or household goods) in the case of improper handling.

<Example of graphic illustration>



-  This symbol means "prohibited" (never do this).
-  "Disassembly prohibited"
-  "Prohibited use in wet location"
-  "Prohibited to wet"
-  This symbol means "compulsory" (be sure to do).
-  "General activities"
-  "Pull out the power cord from outlet"

- After reading, make sure to keep this manual in a place where users can refer to it at any time.



WARNING

 Prohibited	Use only 100 - 240V AC for power supply. (Cause of fires and electric shocks)
	This appliance is not intended for use by persons (including children) with reduced physical, sensory or mental capabilities, or lack of experience and knowledge, unless they have been given supervision or instruction concerning use of the appliance by a person responsible for their safety.
	Children should be supervised to ensure that they do not play with the appliance.
	Never place the shaver within reach of children. (Cause of injury)
	Never use a power cord if they are damaged or insertion to the outlet is loosened. (Cause of electric shocks, short circuits and ignition)
	Never allow pins or dust to adhere to the power plug and plug for equipment. (Cause of electric shock, short circuit and ignition)
	Do not damage, unnecessarily bend, pull, twist, bind, place a heavy object on top, sandwich, process or wind the power cord around the power adapter, etc. (If the power cord breaks, fires or electric shocks may occur.)
	Do not look into the light emitting lens portion while the LED light dryer is in use. (Cause of blindness by ultraviolet light)
 Prohibited	Never wash the power adaptor and LED light dryer with water. Also, never soak them in water or splash water on them. (Cause of electric shocks and short circuits)
	Never foam-shave or clean with water while using the AC. (Cause of electric shocks and short circuits)



⚠ WARNING

 Prohibited	Do not use the power adaptor and LED light dryer in a place where water is splashed, such as a bathroom, or in a place with high humidity. (Cause of electric shocks and short circuits)
	Detach the hand-held part from the supply cord before cleaning it in water.
 Unplug	Be sure to disconnect the power adaptor from the outlet and main body for maintenance. Never connect or disconnect the power plug to/from the outlet with wet hands. (Cause of electric shocks or injury)
 Prohibited	Never modify the shaver. Only a qualified technician may make repairs. (Cause of fires, electric shocks or injury)

⚠ CAUTION

 Make sure	Check for any breakage or deformation of foil before use. (Cause of damage to skin)
	The foil wears each time it is used. When wear proceeds, breakage of blades may occur during use and cause damage to skin. Replace it with a separately sold replacement blade as soon as possible.
	When disconnecting a power plug for equipment, do not pull the cord, but be sure to pull the plug to disconnect. (Cause of electric shocks, short circuits or ignition)
	Regularly clean the power plug and plug for equipment so that dust does not form on them. (Cause of electric shocks, short circuits or ignition)
	Wipe away water drops on the main body sufficiently, and charge in dry state. (Cause of short circuits, burns due to heating)
	Use carefully if you have acne or abrasions on skin. (Breakage causes damage to skin)
	In case of accidental ingestion of shaver oil, force person to drink a large amount of water to vomit the oil, and seek medical attention. (Cause of damage to physical condition)
	In case of accidental entry of shaver oil into eyes, immediately wash with a sufficient amount of flowing water and seek medical attention. (Cause of eye impairment)
	After operation, keep it in a place free from moisture. (Cause of damage to the shaver if left in a bathroom due to condensation and rust occurring inside the main body)
	After use, make sure to put on the cap. (Cause of damage to skin by breakage or deformation of the foil)
 Prohibited	This is used for shaving only. Never use it for other (for hair, etc.) than shaving. (Causes of damage to skin and shortening the life of the foil.)
	Never share the shaver with family members or others. (Cause of infection or inflammation)
	Never push the blades strongly. (Cause of damage to skin especially lips or damage to the shaver.)
	Never bring fingers or nails into contact with the foil during use. (Cause of damage to the foil resulting in damage to skin)
	Never clean the foil-cutter assembly with a cleaning brush for maintenance. (Cause of deformation of the cutter or damage to the foil)

⚠ CAUTION

 Prohibited	Never use any other power adaptor and LED light dryer than the ones included. Also, do not charge any other product with the included power adaptor. (Cause of fires by short circuits or abnormal heating)
	Do not remove the main body from the LED light dryer during drying. (Cause of burns by the light emitting lens or foil that becomes hot during drying)
	Do not apply the trimming blade directly to ears and nose. (Cause of injury to ears and nose)
 Unplug	Disconnect the power plug from the outlet when it is not used. (Cause of injury, burns, or electric shocks and fires from electric leakage due to insulation degradation)

Safety precautions

1. Never use cream or gel shaving agents.
 - Cause of clogging and damage to the blade.
2. Never soak the blade in water.
 - Cause of damage to the shaver.
3. Never dry it using a dryer or a fan heater, etc.
 - Cause of deformation or damage to the shaver.
4. Do not charge at each time of use.
 - Cause of impairment of the battery performance
5. Do not dry any other body than this shaver with the LED light dryer.
 - Cause of failures
6. Do not place the LED light dryer in a tilted or unstable position, and do not move it during use.
 - Cause of failure of the equipment
7. Never allow to dry or leave it in a place exposed to direct sunlight and high temperatures.
 - Cause of damage to the shaver due to deformation and deterioration of the waterproof rubber.
8. Never wipe the shaver or the power adaptor with alcohol, benzene, and thinner, etc.
 - Cause of deformation and discoloration.

If the blade surfaces are applied to the skin too strongly as the battery level is low or maintenance is inadequate, an automatic stop may be made by the protection circuit functioning under an increased load. The shaver can be used by connecting the power adaptor and turning "ON" the switch again. Charge as it is or carry out a sufficient level of maintenance.

(If the shaver does not move even when the switch is turned "ON," connect the power adaptor to the main body, insert the power plug into an outlet, and then turn "ON" the switch again.)

Name and function of each portion (Fig.1)

- ① **Cap:** Protects the blade.
- ② **Head holder**
- ③ **Foil-cutter assembly**
Foil, cutter, center trimmer, and cleaning washer are assembled.
- ④ **Foil**
- ⑤ **Cutter (Drum razor blade)**
(incorporated in the cutter)
The cutter cannot be disconnected from the foil-cutter assembly.
- ⑥ **Cleaning washer**
Changes the flow to wash the cutter and foil for maintenance.
- ⑦ **Switch**
If this switch is pressed, the shaver is turned "ON" and if this is pressed again, the shaver is turned "OFF".
- ⑧ **Selector button**
Selects between auto mode, power mode, and normal mode.
- ⑨ **Battery (Built in)**
Lithium ion battery 1 pc.
- ⑩ **Main body socket**
- ⑪ **Foil-cutter assembly detaching knob**
By sliding this button sideways, the foil-cutter assembly can be detached.
- ⑫ **Head holder removal button**
Never press this button during operation.

- 13 **Mode indicator (Blue)**
Auto (flashing) Power (lighting),
Normal (lighting off)
- 14 **Auto lamp (Green)**
The auto mode operates to light
the lamp.
- 15 **Remaining battery level indicator lamp**
The capacity of the battery is displayed
by three lamps. When the "EMP" lamp
flashes during use, this indicates that
charging is required.
- 16 **Charging completion lamp "  "**
During charge: The lamp turns on. (Red)
After charging is completed: The lamp
turns off.
- 17 **Main body**
- 18 **Center trimmer**
Swivels to securely catch beard.
- 19 **Trimming blade**
Used when a difficult to shave long beard
is shaved with the foil, or when
sideburns are closely trimmed.
- 20 **Trimming knob** : Slide this upward.
- 21 **Comb**
Guides long or rough beard into the foil.
- 22 **LED light dryer** (Included in the RM-LTX7000DY)
- 23 **Charging connector**
- 24 **Main body detection switch**
The dry switch cannot be turned on unless
the main body is set properly.
- 25 **Light emitting lens**
- 26 **Dry switch**
Each time the switch is pressed, it switches
between ON and OFF.
Lights during drying.
Flashes slowly (at intervals of 2 seconds)
while the cutter is made to be
antibacterial.
Flashes quickly (at intervals of 0.5 seconds)
to indicate an error.
- 27 **Catch**
- 28 **Attachment/detachment button**
- 29 **Fan (Built-in)**
- 30 **Charger socket**
Insert the plug for equipment of the power
adaptor.
- 31 **Power adaptor : KH-187B**
- 32 **Power plug**
Insert this into the outlet to its base.
- 33 **Plug for equipment** 34 **Cord**
- 35 **Cleaning brush**
- 36 **Shaver oil** 37 **Pouch**

Preparation before use

How to charge

- Charge before first use.
- Make sure to use the included power adaptor for 100 - 240V AC power.

You can also charge by using an LED light dryer.

The recommended charging temperature is in the range of 10 – 35°C

At a temperature below the recommended temperature, the charging response may slow down,
causing an insufficient charge and a reduced number of operating times.

Each battery has a service life.

(The battery life greatly varies according to the conditions of use and storage.)

If the number of operating times is extremely small in spite of use in accordance with the
instructions, it is considered that the battery life is about to expire. For battery replacement, consult
with your distributor or customer service representative listed.

WARNING

Never connect or disconnect to/from the outlet with wet hands. (Cause of electric shocks or injury)

Avoid using in a place where water is splashed such as a bathroom or in a place with high moisture.

(Cause of electric shocks or short circuits)

CAUTION

Wipe away water drops on the main body sufficiently to dry it before charging.

(Cause of burns due to short circuits and heat generation)

1. Turn "OFF" the switch and connect the power adaptor to the main body and outlet. (Fig.2)

38 Turn "OFF" the switch.

39 Connect by aligning the (+) and (-) marks on the reverse side.

40 Charging completion lamp

During charge: The lamp lights (red).

After charging is completed: The lamp turns off.

Caution

- When the switch is turned "ON," this cannot be charged.
- When the capacity of the battery is sufficient, the charging completion lamp may be turned off early.

Charging by using an LED light dryer (Included in the RM-LTX7000DY)

- Connect the power adaptor to the LED light dryer and an outlet, and insert the main body socket into the charging connector of the LED light dryer. (Fig.3)

Caution

If the dry switch is pressed by mistake, the dry switch will flash.

It will go out if the dry switch is pressed again.

When the battery is completely discharged, the charging completion lamp may not light.

If charging is continued as it is, the battery will start to be charged after the charging completion lamp has lit.

Recommended

- Wipe off water droplets if adhered to the main body socket and the charging connector of the LED light dryer.
 - Please use another outlet if noise is generated from the TV, etc., during charging or operation.
2. After completion of charging, disconnect the power adaptor. (Fig.4)
- ④1 Disconnect holding the plug portion.
- During charging, the power adaptor and the main body may slightly heat up, this is not abnormal.
- After charging by using an LED light dryer (Included in the RM-LTX7000DY)
- After completion of charging, remove the main body from the charging connector while holding the LED light dryer, and disconnect the power adaptor from the outlet and LED light dryer. (Fig.5)
- ④2 Used as a stand
- The LED light dryer can be used as a stand by placing the main body since its socket portion fits in the center hole of the LED light dryer. Remove holding the plug portion.

- The standard charging time is 1.5 hours.
- With one charge, it can be used for about 15 days. (For use at three minutes per day.)
(The number of operating times may decrease depending on the operating conditions, such as beard thickness, pressing force to skin, method of maintenance, and low ambient temperature.)

Time to charge

If the remaining battery level indicator lamp flashes when the switch is turned "ON," this indicates that charging is required. Charge in good time. (Fig.6)

- ④3 Remaining battery level indicator lamp (Does not light while charging.)
- Guidelines for remaining battery level indicator lamps
"HIGH," "MID" and "EMP" lamps light: 80% or more
"MID" and "EMP" lamps light: 50% or more
"EMP" lamp light: Less than 50%
"EMP" lamp flashes: Charging is required

NOTICE

When the remaining battery level indicator lamp "EMP" flashes, the motor may stop automatically to prevent excessive discharge.

This product uses a lithium-ion battery.

In order to deliver full performance, observe the following:

- (1) Do not overcharge. The battery life will become short.
Charge after the remaining battery level indicator lamp "EMP" flashes.
- (2) Charge on condition that the ambient temperature is 10°C or more and under 35°C.
Due to the nature of the battery, it is recommended to charge in the range of 10 – 30°C.
At lower or higher temperatures, the battery performance may deteriorate.
- (3) Store in a dry, cool place.
Avoid storing in a hot place where the temperature is 40°C or more or in a cold place where it is 0°C or less.

How to use

- It is recommended to use the shaver at an ambient temperature of 5°C to 35°C.
Use or storage at a temperature below the recommended temperature may disable the shaver or cause a reduced number of operating times.
- For initial use, trim while lightly applying the shaver to skin.

How to shave with the foil

⚠ CAUTION

Check that there is no breakage and deformation of the foil before use.

(Cause of damage to skin)

Do not shave with the trimming blade down. (Cause of damage to skin)

Never press it strongly to the skin.

(Cause of damage to skin especially lips and cause of damage to the foil)

Never shave with only a part of the foil or bring fingers or nails into contact with the foil during use.

(Cause of damage to the foil resulting in damage to skin)

Use carefully if you have acne or abrasions on skin. (Breakage causes damage to skin)

1. Remove the cap and turn "ON" the switch..

- The remaining battery level indicator lamp or charge requesting lamp lights.
If the remaining battery level indicator lamp "EMP" or charge requesting lamp flashes, this indicates that charging is required. Charge by connecting the power adaptor to the main body or use the shaver as it is with alternating current.
- Never touch the switch during operation.

2. Shave with the trimming blade up so as to lightly glide the shaver against the flow of beard in the arrow direction. (Fig.7) ④④ Direct the trimming blade upward.

How to shave delicately

(1) Stretch the skin by hand, and raise beard.

(2) Press the blade surface perpendicular to skin. (Fig.8)

(3) Lightly press the shaver and slowly shave upward.

- When shaving a long grown beard which is difficult to shave by the foil
Cut long grown beard short with the trimming blade, and finish with the foil.

Caution

Never operate the shaver continuously for 20 minutes or more. The shaver automatically stops in approximately 20 minutes as a circuit protector. You can use it by turning on again.

3. After use, turn "OFF" the switch and put on the cap.

- The remaining battery level indicator lamp goes out in three seconds.

■ Mode selection

By pressing the selector button, the auto mode, power mode, or normal mode can be selected. After the normal mode, it returns to the auto mode. (Fig.9)

Auto → Powerful → Normal Select the mode by pressing the selector button.

Auto mode (Auto)

The auto mode operates to automatically control the power mode and normal mode depending on beard thickness. (Fig.10)

④⑤ Mode indicator "flashes (blue)." ④⑥ Auto lamp "lights (green)."

- The auto lamp "lights (green)."
- The mode indicator flashes (blue)."

Caution

If a large amount of beard clippings accumulate in the blade or oil on the blade face runs out, the auto mode may not operate.

- Use in auto mode

When the remaining battery level indicator lamp "EMP" has started flashing, the auto mode is reset, the auto lamp is turned off, and the mode changes to the power mode.

Power mode

Beard can be shaved strongly and quickly at the time of start or in response to a thick beard. (Fig.11)

- ④7 Mode indicator "lights."
- ④8 Auto lamp "turns off."
- The auto lamp is "turned off."
- The mode indicator "lights (blue)."

Normal Mode

Beard can be shaved comfortably and softly in response to normal beard and finishing. (Fig.12)

- ④9 Mode indicator "turns off."
- ⑤0 Auto lamp "turns off."
- The auto lamp and mode indicator are turned off.

When the switch is turned "OFF," the last mode is stored.

The stored mode is automatically set for the next use.

Foam-shaving is possible.

⚠ CAUTION

Foam-shaving is not allowed with AC. (Cause of short circuits)

Never press it strongly to the skin.

(Cause of damage to skin especially lips and cause of damage to the foil)

- Commercially available shaving foam enables to smooth the skin and shave deeper.
- Caution

Never use cream and gel shaving agents. (Cause of clogging or damage of the blade)

1. Foam well and apply to the face.
2. Further lightly press it to the skin to shave upward than when shaving dry (without shaving foam). (Fig.13)
If shaving foam dries during shaving, resulting in poor sliding on skin, apply shaving foam again.
3. Be sure to clean with water after foam-shaving with soap.
For how to clean with water, refer to "Maintenance" .

If soap remains, it will harden and damage the shaver including impairing the rotation of the cutter, resulting in deterioration in sharpness and a reduction in operating times.

4. Apply lubricant and store it in a place free from moisture after shaving.

Leaving it in a bathroom, etc., may result in damage since condensation and rust will occur inside the main body.

How to use with AC

⚠ WARNING

Avoid using in a place where water is splashed such as a bathroom or in a place with high moisture.

(Cause of electric shocks and short circuits)

Never foam-shave or clean with water. (Cause of electric shocks and short circuits)

1. Connect the power adaptor to the main body and outlet and turn "ON" the switch.
 - If the battery is completely discharged, the shaver will sometimes be difficult to start.
In this case, if the switch is turned "OFF," the battery is placed into a charging status.
Operate after charging the battery for about one minute.
If the battery is completely discharged, it may take 5 minutes or more to charge it.
2. Use following "How to shave with the foil."
3. After use, turn "OFF" the switch and disconnect the power adaptor from the outlet and main body.
Recommended
The battery is also consumed when the shaver is used with A/C. Charge it once a month.

How to shave with trimming blade

1. Turn "ON" the switch and extend the trimming blade. (Fig.14) ⑤1 With the cap attached ⑤2 Place your thumb on the projection of the trimming knob, and push it up.
 - Use it with the cap. (Otherwise, hair may enter the blade.)
2. Lightly press the trimming blade perpendicular to skin and slowly shave in the arrow direction.(Fig.15)

⚠ CAUTION

Never press the blade edge strongly. (Cause of damage to skin)

If hair has intruded the blade edge at one time, hair is pulled and entanglement is caused, and it may result in deterioration in sharpness.

3. Turn "OFF" the switch and store the trimming blade after operation. (Fig.16)

Caution

Never place fingers on the upper side of the trimming knob.

(The trimming blade will contact fingers at the time of storing.)

If the trimming knob is pushed downward with the trimming blade contacting fingers, storage will be impossible due to the disconnected lever.

Recommended

If the trimming blade cannot be stored, move the trimming knob upward and downward once or twice to restore it without forcibly pushing it in.

Maintenance

⚠ WARNING

Never wash the power adaptor and LED light dryer with water. Also, never soak them in water or splash water on them. (Cause of electric shocks and short circuits)

Be sure to disconnect the power adaptor from the outlet and main body for maintenance.

(Cause of electric shocks or injury)

⚠ CAUTION

Do not wash with water when using the shaver with AC. (Cause of short circuits)

Never push the blades strongly. (Cause of damage to skin especially lips or damage to the shaver.)

Do not clean the foil-cutter assembly with the cleaning brush.

(Cause of deformation of the cutter or breakage of the foil)

How to keep a comfortable sharpness

- After use (especially shaving with soap), make sure to perform maintenance. Make sure to wash the foil-cutter assembly with water.
Accumulation of beard clippings will cause deterioration in sharpness or scattering of beard clippings.
- For the main body and trimming blade, the cleaning brush can also be used.
Do not clean the foil-cutter assembly with the brush because doing so will cause deformation of the cutter or breakage of the foil.
- After washing with water, apply the included shaver oil to the foil.
 - Smoothens rotation. • Prevents reduction in operating times.
 - Keeps sharpness. • Prevents blade heat generation.
 - Prevents blade wear.

Purchase optionally available shaver cleaner after the attached shaver oil is used up.

Cleaning with water

- The foil-cutter assembly can be washed with water.

1. Turn "OFF" the switch to remove the cap and head holder. (Fig.17)

③ Remove the holder while pressing the head holder removal button.

Press the head holder removal button (1) to remove the head holder in the arrow (2) direction.

2. Turn "ON" the switch and pour water or lukewarm water between the foil assembly and main body for approximately 10 seconds to wash the foil and cutter assembly. (Fig.18)

④ Turn "ON" the switch.

Advice

If buildup is severe or difficult to remove, wash with water, apply a small amount of kitchen detergent (neutral) to the foil, turn "ON" the switch, and evenly foam the entire surface of the blade for approximately 20 seconds. Then, wash the shaver once again to remove buildup. (Fig.19)

⑤ Foam for approximately 20 seconds.

✖ If buildup still cannot be removed, remove the foil-cutter assembly, soak the shaver in water or lukewarm water containing a small amount of kitchen detergent (neutral) for approximately eight hours, then wash it with water to remove buildup. (Fig.20)

- Please refer to "How to replace the foil-cutter assembly" to detach or attach the foil-cutter assembly. Never use bathroom or toilet detergents, etc.

Caution

- Never turn "ON" the switch without pouring water on the blade and with the head holder removed. (Cause of scattering of hair clippings)
- Never use hot water. (Cause of deformation and failure of the shaver)
- Never soak the main body in water. (Cause of failure of the shaver)

3. After washing with water, wipe off water droplets on the main body and head holder.
Lightly wipe off water droplets on the foil surfaces with tissue, etc.
If wiping off is insufficient, water droplets may remain.
CAUTION
 - Never drain it by shaking. (Cause of the foil-cutter assembly coming off)
4. Press the lower part of the head holder removal button to attach the head holder. (Fig.21)
 - ⑤ Front (Notched side corresponds to the back side.)
 - ⑤ Push in the head holder until it clicks.
 - Make the front face of the head holder face the switch side for attachment.

Caution
The head holder cannot be connected in a state where it is facing back to front.
5. After drying, turn "ON" the switch, apply the included shaver oil to the foil and trimming blade, and after 4 to 5 seconds, turn "OFF" the switch.
Wipe the surfaces of the foil and trimming blade with tissue, etc., and put on the cap. (Fig.22)
Recommended
After drying, be sure to apply the shaver oil to the foil and trimming blade.
(This will prevent deterioration in sharpness, reduction in rotational rate of the motor, reduction in operating times, premature damage due to wear of the foil, and heat generation of the blade.)
6. After maintenance, keep it in a place free from moisture.
 - Leaving it in a bathroom, etc., may result in damage since condensation will occur inside the main body.
7. Prevent deterioration of the battery.
 - Prevent deterioration of the battery.

If you do not use the shaver for 3 months or more, discharge until the remaining battery level indicator lamp "EMP" flashes, and then charge for approximately 45 minutes.



This mark means suitable for cleaning under an open water tap.

Drying with the LED light dryer (Included in the RM-LTX7000DY)

- The main body and trimming blade cannot be dried.
 - Use at an ambient temperature of 15~35 °C or more.
1. Connect the power adaptor to the LED light dryer and an outlet. (Fig.23) ⑤ Suction slot
Caution
 - Do not block the suction slot.
 - Keep out of the reach of children.
 2. After washing with water, wipe off water droplets on the main body, and attach the head holder.
 - Lightly wipe off water droplets on the blade surfaces with tissue, etc.
 3. Mount the main body on the LED light dryer. (Fig.24)
Set the main body as its front (switch side) faces front and its blade surfaces face down.
Caution
 - Wipe off water droplets adhered to the main body and foil surface.
 - Be careful because the main body may topple over if tilted forward.
 - Use this shaver exclusively.
 4. Press the dry switch.
During drying, the dry switch lights in blue and the light emitting lens lights in purple, and the fan rotates. After drying, the light emitting lens lights in purple for approximately 15 hours, and the inscription "G-SWORD" on the LED light dryer flashes slowly (at intervals of 2 seconds) and then goes out.
 - The drying time is approximately 1.5 hours. After completion of drying, it automatically switches to the LED light antibacterial mode, and the LED stays lit for approximately 15 hours. (If the ambient temperature is under 15°C, it will be detected by the sensor, with the result that the drying time will become approximately 3 hours, followed by the LED light antibacterial mode for approximately 15 hours.)

Note

If the dry switch is pressed when the main body is not set properly, the inscription "G-SWORD" on the dry switch flashes quickly. Set the main body again.

⚠ CAUTION

Do not remove the main body during drying (when the inscription "G-SWORD" on the dry switch lights). (Cause of burns by the light emitting lens or foil that becomes hot during drying)

5. After completion, take out the main body, and disconnect the power adaptor from the outlet.
Caution : Never wash the LED light dryer with water. (Cause of failures)
6. After drying, apply the shaver oil, and keep it in a place free from moisture.
 - After drying, apply the shaver oil and store in a place free from moisture.
For details, see 5 and 6 under "Maintenance (Cleaning with water)."

■ To deliver full performance of the lithium-ion battery

If you do not use the shaver for 3 months or more, discharge until the remaining battery level indicator lamp "EMP" flashes, and then charge for approximately 45 minutes.

Brush cleaning

Never clean the foil-cutter assembly with a brush.

Otherwise, the cutter will deform to damage the foil, or the brush tip may be caught in the foil.

1. Turn "OFF" the switch and detach the head holder and the foil-cutter assembly.
Please refer to "How to replace the foil-cutter assembly" to detach the foil-cutter assembly.
2. Clean the main body and trimming blade. (Fig.25)
3. After cleaning, store the trimming blade, attach the foil-cutter assembly and head holder, and cover the cap. Please refer to "How to replace the foil-cutter assembly" to attach the blade assembly.

Recommended

Once a week, turn "ON" the switch, apply of the included shaver oil to the foil and trimming blade, and after 4 to 5 seconds, turn "OFF" the switch, and wipe the surfaces of the foil and trimming blade with tissue, etc.

- Remove contamination on the main body with a cloth which contains water or diluted kitchen detergent (neutral) and firmly wrung.

CAUTION

Never use alcohol, benzene, and thinner, etc. (Causes of deformation and discoloration)

Maintenance of the LED light dryer (Included in the RM-LTX7000DY)

- The LED light dryer cannot be washed with water.

Caution

- Make sure to disconnect the power adaptor from the LED light dryer.
 - Do not tilt the LED light dryer or turn it upside down.
(Cause of spillage or internal entry of water droplets having accumulated in the catch)
1. Clean the catch. (Fig.26)  Remove while pushing the attachment/detachment buttons.
 - Remove the catch by pushing the attachment/detachment button.
Be careful not to tilt it if water has accumulated.
 - Pour out the water, and lightly wipe with a dry cloth or tissue, etc.

Caution

When removing the catch, if the LED light dryer is turned upside down, water droplets may enter the inside, short-circuiting the circuit board.

- After maintenance, attach the catch.
2. Clean the inside. (Fig.27)
 - Lightly wipe away dust, dirt, etc., adhered to the light emitting lens and the inside with a cloth or tissue, etc., moistened with water.
 - Clean the corners and projections and depressions with a cotton swab, etc.

How to replace the foil-cutter assembly

⚠ CAUTION

When replacing the foil-cutter assembly, make sure to disconnect the power plug and turn "OFF" the switch. (Cause of failures)

Never strongly hold the foil-cutter assembly. (Cause of damage and injury to fingers)

Recommended

After blade replacement, make sure to apply the included shaver oil.

For spraying places, see 5 under "Maintenance (Cleaning with water)."

(Cause of failure of movement of the cutter or heat generation of the blade surface)

- Turn "OFF" the switch to remove the cap and head holder. (Fig.17)
Press the head holder removal button (1) to remove the head holder in the arrow (2) direction.
- Detach the foil-cutter assembly. (Fig.28)
Slide the foil-cutter assembly detaching knob to the right (1),pick up and pull both ends of the foil-cutter assembly straight upward (2) to detach it.
 - Never pull it diagonally, otherwise, it may not be detached.
- Press the lower part of the head holder removal button to attach a new foil-cutter assembly. (Fig.29)
 - Alignment mark(▼) ⑥1 Alignment mark(▲)
 - Align the alignment marks (▼) and (▲) of the foil-cutter assembly and main body.
 - Push down the both ends of the foil-cutter assembly until it clicks.
 - Alignment mark

Caution

 - Floating of the foil-cutter assembly will result in failure.
 - The foil-cutter assembly cannot be connected in a state where it is facing back to front.
- Confirm the attachment of the foil-cutter assembly. (Fig.30)
Pick up and lightly pull both ends, and if the assembly cannot be removed, it is properly attached.
- Press the lower part of the head holder removal button to attach the head holder. (Fig.21)
Align the front face of the head holder to the switch side for attachment.
Caution : The head holder cannot be connected in a state where it is facing back to front.

Troubleshooting

Before requesting repair, check the following:

Symptom	Check point	Remedy
- Hot blade surface - Deterioration in sharpness	Check to see if the outer-inner blade assembly is securely attached (not floating).	Push in the outer-cutter assembly until it clicks allowing no gap to the main body.
- Weak rotation - Small number of operating times - Stop during use	Check for heavy accumulation of beard clippings inside the blade. Check the blade surface for oil shortage.	Periodically perform maintenance.
- Scattering of beard clippings with the switch "ON" - Strong smell	Check for accumulation of beard clippings. Check for insufficient maintenance.	Periodically perform maintenance.
- Charging completion lamp turns off early	Check for full charge.	There is no problem. Use as is.
- Remaining battery level indicator lamp flashes early	Check for being not in use for 3 months or more.	Charge when the remaining battery level indicator lamp "EMP" flashes to indicate that charging is required.
- No movement with the switch "ON"	Check for being out of charge. Check for accumulation of beard clippings. Check the blade surface for oil shortage.	- Turn "OFF" the switch, and charge for approximately 1 minute before use. - Disconnect the power adaptor once, and insert it again. - Periodically perform maintenance.
- Failure of charging with the LED light dryer - No movement of the LED light dryer (dry switch flashing quickly)	Check to see if the power adaptor is properly connected. Check to see if the main body is properly set to the LED light dryer.	Check to see if the power adaptor is properly connected. Check to see if the main body socket is properly set in the charging connector. Reset the main body.

Symptom	Check point	Remedy
- Failure of drying with the LED light dryer	Check for accumulation of dust, etc., inside the LED light dryer.	Periodically perform maintenance.
	Check to see if water drops on the main body and blade surface have been wiped off after washing with water.	Wipe off water drops on the main body and blade surface before setting.

Check the above, and if the shaver is still in poor condition, do not repair by yourself but consult your distributor.

Specifications

Power supply	Power adaptor (KH-187B)	100 – 240V AC, 50/60Hz, 14VA		
	Main body	Battery (Lithium-ion battery 3.6V DC, 1300mAh) x 1		
Charging time	1.5 hours as standard	Rated time	5 minutes	
Mass	Main body : Approximate 200g Power adaptor : Approximate 70g LED light dryer : Approximate 150g			
Accessories	Pouch, Shaver oil, Cleaning brush			

Please note when disposing of the product

⚠ DANGER

Do not charge the removed battery and also: (Cause of heat generation, catching fire, or rupture)

- Do not throw in fire or overheat it.
- Do not puncture with a nail, give a shock, disassemble, or modify it.
- Do not bring (+) and (-) into contact with metal, etc.
- Do not carry or store it together with a necklace, hairpin, etc.
- Do not leave it in a hot place, such as near a fire or under a scorching sun.

⚠ WARNING

Keep the removed battery out of reach of children.

If they are suspected of having swallowed the battery, immediately seek medical attention.

If the battery fluid leaks, do not touch it with bare hands but take the following action.

- If the fluid gets in eyes, do not rub eyes but immediately rinse with clean water and then seek medical attention.
- If the fluid adheres to the body or clothing, sufficiently rinse with clean water and then seek medical attention.

Do not disassemble except when disposing of the product.

■ This product includes recyclable parts.

For disposal of the parts, observe your local laws and regulations etc.

How to remove the lithium-ion battery

1. Keep the switch "ON" until the shaver stops moving completely to discharge the lithium-ion battery.
2. Remove the cap, head holder, and outer-cutter assembly.
3. Remove the screws from the rear cover with a Phillips screwdriver, and remove the rear panel. (Fig.31) ⑥5 Screws
4. Remove blind piece B and blind piece C from the front panel by using tweezers or the like, disengage the claws with a flat-blade screwdriver or the like, and remove the front panel. (Fig.32)
⑥6 Blind piece C ⑥7 Blind piece B ⑥8 Claws ⑥9 Front panel ⑦0 Flat-blade screwdriver
5. Remove the two Phillips screws from the housing case, and remove the housing case. (Fig.33)
⑦1 Housing case
6. Take out the lithium-ion battery, and cut the lead wires separately near the base of the battery. (Fig.34)
⑦2 Lead wires ⑦3 Lithium-ion battery

⚠ CAUTION



Do not bring the (+) and (-) lead wires of the removed lithium-ion battery into contact.

(Cause of short circuits or burns)









中文

安全上的注意事項

- 此處表示的注意事項，是為了讓您安全、正確地使用本產品，以防止對您以及他人造成危害與損害。
- 注意事項區分如下。
每一項均是有關安全的重要內容，請務必遵守。

 危險	如果錯誤使用會造成使用者死亡或重傷之緊迫的危害程度。
 警告	如果錯誤使用可能會造成使用者死亡或重傷的危害程度。
 注意	如果錯誤使用可能會造成使用者輕傷或損壞物品(房屋、家庭用具等)的危害和損壞程度。

<圖示例>



	 記號，表示“禁止”(絕對不要做)的行為。  “禁止拆開”  “禁止在有水的場所使用”  “禁止用濕手觸摸”
	 記號，表示“強制”(必須做)的行為。  “一般的行為”  “將電源插頭從插座上拔下”

- 閱讀後，必須妥善保管，將其放置使用者隨時可以參閱的地方。

警告

 禁止	不可使用交流100V-240V以外的電源。(否則會造成火災或觸電)
	生理、感覺或心理能力欠佳或缺少經驗及知識的人士(包括兒童)不得使用本產品，除非他們得到其安全責任人在本產品使用方面的監督或指導。
	應對兒童進行監督，確保其不玩耍本產品。
	不可使用損壞的電源線或電源插頭，也不可使用鬆動的插座。(否則會因損傷電源線，造成火災或觸電)
	電源插頭或配件插頭上不可粘附存。(否則會造成觸電、短路或起火)
	不可損傷、用力彎曲、拉扯、扭曲、捆紮、重壓、夾入、加工電源線或捲繞在電源變壓器上。(否則會損壞電源線，造成火災或觸電)
	烘乾充電器使用中不可正視LED燈。(否則會因紫外線造成失明)



⚠ 警告

 禁止	絕對不可用水清洗電源變壓器、烘乾充電器。也不可用水浸泡或淋水。 (否則會造成觸電或短路)
	使用交流電時，不可用肥皂剃鬚或沖洗剃鬚刀。 (否則會造成觸電或短路)
	請不要在潮濕或浴室容易淋到水的地方使用電源變壓器及烘乾充電器。 (否則會造成觸電或短路)
	清洗刀片前，請拔掉電源。
 拔下電源 插頭	清潔保養時，必須請拔掉電源。 若沾濕了手，不可插入或拔除電源插頭。(否則會造成觸電或受傷)
	不可擅自讓未經授權的人士拆解、修理或修改。 (否則會造成火災、觸電、受傷或故障)
 禁止	

⚠ 注意

 務必遵守	使用前先檢查外刀是否破損或變形。(否則會刮傷皮膚)
	經常使用會使外刀逐漸磨損，刮傷皮膚。 應儘早更換新外刀(另售)。
	拔下配件插頭時，不可拉電源線，必須用手握住插頭拔下。 (否則會造成觸電、短路或起火)
	請定期清潔電源插頭、配件插頭，不可使插頭粘上灰塵。 (否則會造成觸電、短路或起火)
	擦淨機身上的水滴，使其乾透後再充電。 (否則會造成短路或發熱而導致燙傷)
	皮膚上有暗瘡或傷口時，使用時應特別注意。 (否則會刮傷皮膚)
	若飲了剃鬚刀潤滑油時，應大量飲水吐出，並請醫生治療。 (否則會影響身體健康)
	如果剃鬚刀潤滑油誤入眼睛時，應立即用水沖洗，並請醫生治療。 (否則會損害眼睛)
	使用後，放置濕氣少的地方保存。 (如果放置浴室潮濕的地方，會使機身內部產生露水或生銹造成機器故障)
	使用後必須蓋上保護蓋。 (否則會因外刀破損或變形，造成皮膚損傷)

⚠ 注意

 禁止	本產品為專用電鬚刨。不可用於剃鬚以外的目的(不可用來剪髮)。 (否則會損傷皮膚, 或縮短電鬚刨的使用壽命)
	不可與家人或其他人共用。(否則會造成感染或發炎)
	不可用力按壓外刀。(否則會刮傷嘴唇或造成皮膚損傷)
	不可只用外刀邊緣剃鬚、以及用手指或指甲觸碰外刀。 (否則會造成外刀破損而導致皮膚受傷)
	清潔保養時, 不可用清潔刷清潔內外刀組。 (否則會造成內刀變形或外刀破損)
	不可使用附件以外的電源變壓器以及烘乾充電器。 也不可用附屬電源變壓器來對其它商品充電。 (否則會造成短路或異常發熱而導致起火)
	不可在烘乾中從機身上拔下烘乾充電器。 (否則會因LED燈或外刀發熱而導致燙傷)
不可用修剪刀直接觸碰耳朵或鼻子。 (否則會造成耳朵或鼻子受傷)	
 拔下電源 插頭	不使用時, 務必將電源插頭從插座上拔下。 (否則會造成受傷、燙傷、因絕緣劣化引起的觸電或漏電火災)

使用上的注意事項

1. 不可使用膏狀或膠狀剃鬚劑。
 - 否則會造成刀網堵塞或故障。
 2. 不可浸泡在水中。
 - 否則會造成機器故障。
 3. 不可用吹風機或暖風機吹乾刀頭。
 - 否則會造成變形或機件故障。
 4. 不可在每次使用後進行充電。
 - 否則會損壞蓄電池性能。
 5. 不可用烘乾充電器烘乾本機以外的本體。
 - 否則會造成故障。
 6. 烘乾充電器僅供電鬚刨的刀頭部份作烘乾之用, 請不要用於其他部份。
 - 否則會造成機器故障。
 7. 不可放置陽光直接照射或高溫地方。
 - 否則會造成變形或因防水橡膠劣化而導致機器故障。
 8. 不可用酒精、汽油或稀釋劑, 擦拭機身或烘乾充電器。
 - 否則會造成變形或變色。
- 在低電量的狀態下, 用力將刀片壓在臉部上保養不足的情況時, 本機會自動斷電, 停止運作以保護電路功能。
- 再次將開關設為「ON」即可使用, 最好請提早充電或進行充分的清潔保養。
 - 如果將開關設為「ON」也不起動時, 直接使用充電器, 接上電源後把開關設為「ON」。

各部名稱及功能(圖1)

- ① 保護蓋
用於保護刀片。
- ② 刀頭蓋
- ③ 內外刀組
將內刀、外刀與中心修剪器以及清洗器組裝在一起。
- ④ 外刀
- ⑤ 內刀(光觸媒滾筒式刀片)
不能從內外刀組中拆下內刀。
- ⑥ 刀頭內藏清洗器
清潔時，讓水流產生變化，清洗內外刀刀。
- ⑦ 開關
每按下一次開關可以切換ON和OFF。
- ⑧ 選擇按鈕
可以切換為自動模式、強力模式、標準模式。
- ⑨ 蓄電池
鋰離子電池 1個
- ⑩ 機身插口
- ⑪ 內外刀組拆除鈕
向橫向滑動即可拆下內外刀組。
- ⑫ 頂蓋拆除鈕
使用中不可按下。
- ⑬ 模式指示燈(藍色)
自動(閃爍)、強力(亮燈)、標準(熄燈)
- ⑭ 自動指示燈(綠色)
自動模式運作時指示燈亮燈。
- ⑮ 電量指示燈(橙色)
用3種指示燈顯示蓄電池電量。
使用中「EMP」指示燈閃爍時，表示必須充電。
- ⑯ 充電結束指示燈「■」
充電中：亮燈(紅色)
充電結束後：熄燈
- ⑰ 機身
- ⑱ 中央修剪刀
進行擺動準確抓住鬍鬚。
- ⑲ 修剪刀
修剪臉頰邊的鬍子或較長的鬍子。
- ⑳ 修剪刀按鈕
向上滑動就能推出修剪刀。
- ㉑ 梳
引導長而密的鬍子到外刀處。
- ㉒ LED光觸媒除菌烘乾充電器
(簡稱:烘乾充電器) 僅限RM-LTX7000DY
- ㉓ 充電連接器
- ㉔ 機身檢測開關
如果不正確安裝機身，則不能按下起動開關。
- ㉕ LED燈
- ㉖ 烘乾開關
每按下一次開關可以切換ON和OFF。
烘乾中：亮燈
內刀抗菌中：緩慢閃爍(間隔2秒鐘)
異常表示：快速閃爍(間隔0.5秒鐘)
- ㉗ 底座蓋
- ㉘ 拆裝按鈕
- ㉙ 排風扇(內裝)
- ㉚ 充電器插口
用於插入電源變壓器。
- ㉛ 電源變壓器
型號：KH-187B
- ㉜ 電源插頭
將插頭插入到底。
- ㉝ 機身/配件插頭
- ㉞ 電源線
- ㉟ 清潔刷
- ㊱ 剃鬚刀潤滑油
- ㊲ 旅行袋

使用前的準備

充電方法

- 初次使用前，請先進行充電。
- 請務必使用交流100-240V電壓的附屬電源變壓器。另外，還可使用烘乾充電器進行充電。
- 推薦充電溫度為10~35°C。如果溫度低於建議溫度，會引起充電反應遲鈍，導致充電不足而造成使用次數減少。
- 蓄電池也有壽命。(電池壽命因使用和保存狀態會有很大變化。)
即使按照使用說明書使用，使用次數仍大幅減少時，可能是電池使用壽命到期造成的。
電池的更換請與購買的銷售店商談。

⚠警告

若沾濕了手，請不要插入或拔除電源變壓器。(否則會造成觸電或受傷)
絕對不可用水清洗電源變壓器。也不可用水浸泡或淋水。(否則會造成觸電或短路)

⚠ 注意

擦淨機身上的水滴，使其烘乾後再充電。(否則會造成短路、發熱而導致燙傷)

1. 將開關設為「OFF」後，將電源變壓器連接於機身和插座上。(圖2)

③⑧ 開關於「OFF」狀態

③⑨ 將背面的(+)(-)標記對準後連接

④⑩ 充電結束指示燈為

充電中：亮燈(紅色) 充電結束後：熄燈

注意

- 開關設為「ON」時，不能充電。
- 蓄電池電量充足時，充電結束指示燈會熄燈。

使用烘乾充電器充電時(僅限RM-LTX7000DY)

· 將電源變壓器連接於烘乾充電器插座上，將機身插口插入烘乾充電器的充電連接器。(圖3)

注意

- 誤按下烘乾開關時烘乾開關會閃爍。再次按下烘乾開關則熄燈。

蓄電池沒電後會出現充電結束指示燈不亮的現象。如果繼續充電時，充電結束指示燈會亮燈並開始向蓄電池充電。

須知

- 機身插口及烘乾充電器的充電連接器沾上水滴時，請擦拭乾淨。
- 充電中或使用中，如電視機等出現噪音時，請使用其它的插座。

2. 充電結束後，將電源變壓器從插座和機身上拔下。(圖4) ④⑪ 用手拿住插頭部分拔下

- 充電中，電源變壓器和機身可能會有些發熱，這並非故障。

使用烘乾充電器充電時(僅限RM-LTX7000DY)

· 充電結束後，按住烘乾充電器將機身從充電連接器上拔下，握住烘乾充電器，並從插座拔下電源。(圖5)

④⑫ 作底座使用

· 將機身底下的插口部對準烘乾充電器中央，可作底座使用。

· 標準充電時間為1.5小時。

· 一次充電時間約可使用15天。(一天使用3分鐘的情況下)

(根據鬍鬚的濃密度、按壓皮膚的力度、清潔保養方法、以及環境溫度等使用條件的不同，可能會減少使用次數。)

充電時

將開關設為「ON」，電量指示燈「EMP」閃燈時，表示必須充電。

請進行充電。(圖6)

④⑬ 電量指示燈 (充電中不會亮燈)

● 電量指示燈的大致標準

「HIGH」、「MID」、「EMP」指示燈亮燈……80%以上

「MID」、「EMP」指示燈亮燈……50%以上

「EMP」指示燈亮燈……未滿50%

「EMP」指示燈閃爍……必須充電

告知

電量指示燈「EMP」閃爍時，電鬚刨馬達會自動停止，以防止過度用電。

本產品使用的是鋰離子電池。為了能夠充分發揮蓄電池的性能，務必遵守以下事項。

(1) 不可過度充電。否則會縮短電池的使用壽命。

電量指示燈「EMP」閃爍後進行充電。

(2) 周圍溫度為10°C以上、低於35°C的情況下進行充電。

由於蓄電池的特性，建議於10~30°C以內進行充電。

如果於低溫或高溫下充電，會降低電池的性能。

- (3) 必須放置在乾燥且陰涼的地方。
不可放置在40°C以上的炎熱地方或0°C以下的寒冷的地方。

使用方法

- 建議使用溫度為5°C~35°C。
- 如果在低於建議溫度的低溫狀態下使用或保存時，會有不能運作或使用次數減少的情況。
- 初次使用時，請輕輕貼在皮膚上慢慢地試著剃鬚。

外刀的剃鬚方法

⚠注意

使用前先檢查外刀是否破損或變形。(否則會刮傷皮膚)
不可將修剪刀側朝下剃鬚。(否則會刮傷皮膚)
不可用力按壓皮膚。(否則會造成刮傷嘴唇或皮膚、甚至令外刀破損)
不可在使用中只用外刀邊緣剃鬚、以及用手指或指甲觸碰外刀。
(否則會造成外刀破損而導致皮膚受傷)
皮膚上有暗瘡或傷口等時，使用時應特別注意。(否則會刮傷皮膚)

- 拆下保護蓋，將開關設為「ON」。
 - 電量指示燈為亮燈狀態。電量指示燈「EMP」變成閃爍時，表示必須充電。將電源變壓器連接在機身上進行充電，或直接使用交流電。
 - 使用中不可觸碰開關。
- 將修剪刀朝上，與逆著鬚鬚生長方向朝箭頭方向慢慢地剃鬚。(圖7)
④ 將修剪刀朝上
正確的剃鬚方法
 - 用手繃緊皮膚使鬚鬚立起。
 - 將刀面成直角貼在皮膚上。(圖8)
 - 輕輕貼在皮膚上與逆著鬚鬚生長方向慢慢地剃鬚。
 - 用外刀剃除不易剃去的長鬚鬚時
先用修剪刀剪短長鬚鬚，然後再用外刀修剃。

注意
不可連續使用超過20分鐘。
為了保護電路約20分鐘後會自動停止。再次設為「ON」即可使用。
- 使用後，將開關設為「OFF」，並蓋上保護蓋。
 - 電量指示燈約3秒鐘後熄滅。

■選擇模式

每按下一次選擇按鈕，可以切換成自動模式、強力模式、標準模式。
標準模式之後返回自動模式。(圖9)

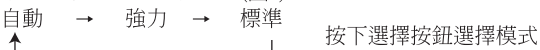

自動模式

根據鬚鬚的濃密度，自動模式起動後，可以自動切換成強力模式或標準模式。(圖10)

- ⑤ 模式指示燈：「閃爍(藍色)」 ⑥ 自動指示燈：「點燈(綠色)」
- 自動指示燈為「亮燈(綠色)」狀態。
 - 模式指示燈為「閃爍(藍色)」狀態。

注意

如果刀片上積存大量的鬚鬚屑、或刀面缺油時，自動模式會有不起動的情況。

- 使用自動模式時
如果電量指示燈「EMP」閃爍時，自動模式就會被解除，
自動指示燈熄燈後，切換成強力模式。

強力模式

對開始剃鬚或濃密鬍鬚，可以進行強力且快速的剃鬚。(圖11)

- ④7 模式指示燈：「點燈」
- ④8 自動指示燈：「熄燈」
- 自動指示燈為「熄燈」狀態。
- 模式指示燈為「點燈(藍色)」狀態。

標準模式

用於一般的鬍鬚修剃，可以進行舒適、柔軟的剃鬚。(圖12)

- ④9 模式指示燈：「熄燈」
- ⑤0 自動指示燈：「熄燈」
- 自動指示燈和模式指示燈為熄燈狀態。
- 如果將開關設為「OFF」時，則會記憶關閉前使用的模式，再次使用時，其模式為記憶的使用模式。

■可使用肥皂剃鬚(剃鬚泡沫)

⚠ 注意

使用交流電時，不可使用肥皂剃鬚。(否則會造成短路)

不可用力按壓皮膚。(否則會造成刮傷嘴唇或皮膚、甚至令外刀破損)

· 使用市面的剃鬚泡沫，可使皮膚光滑便於剃得更乾淨。

注意

不可使用膏狀或膠狀剃鬚劑。(否則會造成刀網堵塞或轉數降低，甚至故障)

1. 將肥皂充分起泡沫後塗抹在臉上。
2. 應該比乾剃(不使用剃鬚泡沫)時，更輕的貼住皮膚，與逆著鬍鬚生長方向慢慢地剃鬚。

(圖13)

剃鬚中途，因剃鬚泡沫乾了造成皮膚不光滑時，請再次塗抹剃鬚泡沫。

(否則會造成轉數降低或停止)

3. 使用後，必須用水沖洗乾淨肥皂成分。有關清洗方法，請參照「清潔保養方法」。

必須將肥皂成分沖洗乾淨，否則會因結塊造成內刀不能旋轉，導致機器的故障、降低刀片的鋒利度或使用次數減少的問題。

4. 清潔保養後，放置濕氣少的地方保存。

如果放置在浴室潮濕的地方，會使機身內部產生露水或生鏽造成機器故障的原因。

交流電的使用方法

⚠ 警告

請不要在潮濕或浴室容易淋到水的地方使用電源變壓器。(否則會造成觸電或短路)

不可用肥皂剃鬚或沖洗剃鬚刀。(否則會造成觸電或短路)

1. 將電源變壓器連接於機身和插座上，並將開關設為「ON」。
 - 當蓄電池完全沒電後，可能會出現難以起動的情況。此時，如果將開關設為「OFF」狀態即可充電，請先充電約1分鐘後再使用。
 - 如果完全沒電時，會需要5分鐘以上充電時間。
2. 按照「外刀的剃鬚方法」使用。
3. 使用後，將開關設為「OFF」，將電源變壓器從插座和機身上拔下。
 - 須知
 - 作為交流電使用時，因消耗蓄電池，請一個月充電一次。

修剪刀的剃鬚方法

1. 將開關設為「ON」後，推出修剪刀。(圖14) ⑤ 裝上保護蓋使用
 - ⑤ 用手指按住修剪刀按鈕的凸起部份朝上推
 - 請裝上保護蓋使用。(防止鬍鬚屑進入外刀)
2. 將修剪刀成直角輕輕貼住皮膚，並朝箭頭方向慢剃。(圖15)

⚠ 注意

不可用力按壓剃刀前端或橫向滑動。(否則會刮傷皮膚)

如果在剃刀前端進入大量的鬍鬚時，則會產生拉扯或夾住鬍鬚的情況，因而減低刀片的鋒利度。

3. 使用後，將開關設為「OFF」，並收存修剪刀。(圖16)

注意

不可將手指放在修剪刀按鈕的上方。(否則會在收存時觸碰修剪刀。)

如果將手指放在修剪刀上推下修剪刀按鈕時，會造成手柄脫落而不能收存的情況。

須知

不能收存修剪刀時，不可用力按下。

只要將修剪刀按鈕上下反復操作1~2次即可收存剃刀。

清潔保養

⚠ 警告

請不要在潮濕或浴室容易淋到水的地方使用電源變壓器及烘乾充電器。
(否則會造成觸電或短路)

清潔保養時，必須拔掉電源。(否則會造成觸電或受傷)

⚠ 注意

使用交流電時，不可用水清洗。(否則會造成短路)

不可用力按壓外刀。(否則會刮傷嘴唇或造成皮膚損傷)

不可用清潔刷清潔內外刀組。(否則會造成內刀變形或外刀破損)

■ 為保持舒適的鋒利度

- 使用後(特別是肥皂剃鬚後)，必須進行清潔保養。內外刀組必須用水清洗。
如果積存鬍鬚屑，則會機身降低刀片的鋒利度或鬍鬚屑飛散。
- 也可使用清潔刷清潔機身和修剪刀。
不可用清潔刷清潔內外刀組，否則會造成內刀變形或外刀破損。
- 每次清洗後，必須用附屬的剃鬚刀潤滑油塗抹外刀。
 - 使旋轉滑順。
 - 保持鋒利度。
 - 防止刀片磨損。
 - 防止使用次數減少。
 - 刀片不易發熱。

如果附屬的剃鬚刀潤滑油用完後，請購買另售的剃鬚刀清潔劑。

用水清洗

· 可用水清洗內外刀組以及機身。

1. 將開關設為「OFF」後，拆下保護蓋和刀頭蓋。(圖17) ㊸ 按住刀頭蓋拆除鈕並取下
按住刀頭蓋拆除鈕(1)，將刀頭蓋朝箭頭(2)方向取下。
2. 將開關設為「ON」後，用水或溫水沖洗內外刀組和機身間約10分鐘來洗淨內外刀組。
(圖18) ㊹ 將開關設為「ON」

髒污嚴重或不容易洗淨時

應先用水清洗後，在外刀上塗抹少量廚房用洗劑(中性)，並將開關設為「ON」，使整個刀面均勻起泡沫約20分鐘後，再次用水沖洗，即可除淨髒污。(圖19) ㊺ 約20分鐘起泡沫
※ 如果仍不能除淨髒污和異味時，拆下內外刀組，放入加有少量廚房用洗劑(中性)的水或
溫水浸泡8小時，然後用水清洗，即可除淨髒污和異味。(圖20)

· 有關內外刀組的拆卸和安裝方法，請參照「內外刀組的更換方法」。

不可使用浴室和廁所用洗劑等。

注意

- 不可在卸下刀頭蓋狀態下，不沖水就將開關設為「ON」。(否則會造成鬍鬚屑飛散)
- 不可使用熱水。(否則會造成變形或機器故障)
- 不可將機身浸泡在水中。(否則會造成機器故障)

3. 用水清洗後，擦乾機身及刀頭蓋上的水滴。

- 用紙巾等輕輕的擦淨外刀表面的水滴。
- 如果擦拭不乾淨，會有水滴殘留。

注意

- 不可搖動機身弄乾水滴。(否則會造成內外刀組脫落)

4. 按住刀頭蓋拆除鈕的下方，裝上刀頭蓋。(圖21)

⑤⑥ 正面(凹口面為後面) ⑤⑦ 按入刀頭蓋直至聽見「喀嚓」聲為止。

- 將刀頭蓋的正面對準開關鍵的一面。

注意

如果倒轉刀頭蓋的前後，則不能裝上。

5. 烘乾後，將開關設為「ON」，於外刀和修剪刀上塗抹附屬的剃鬚刀潤滑油，4~5秒鐘後將開關設為「OFF」。然後用紙巾等擦淨外刀和修剪刀表面，蓋上保護蓋。(圖22)

須知

乾了後，必須於外刀和修剪刀上噴灑剃鬚刀潤滑油。(可以防止刀片鋒利度下降、使用次數減少、以及因外刀磨損而導致損壞或刀片發熱等情況。)

6. 清潔保養後，放置濕氣少的地方保存。

- 如果放置在浴室的潮濕地方，會使機身內部產生露水造成機器故障。

7. 防止蓄電池劣化。

- 3個月以上未使用時，先進行放電直至電量指示燈(EMP)閃爍後，再進行約45分鐘的充電。



該標誌表示本機可以直接用自來水沖洗。

使用烘乾充電器烘乾 僅限RM-LTX7000DY

- 機身和修剪刀不能使用烘乾充電器風乾。
- 於周圍溫度15~35°C以上的環境中使用。

1. 將電源變壓器連接於烘乾充電器的插座上。(圖23) ⑤⑧ 吸入口

注意

- 不可堵住吸入口。
- 不可放置孩子容易拿到的地方。

2. 用水清洗後，將機身的水滴擦淨後裝上刀頭蓋。

- 用紙巾等輕輕的擦淨刀面的水滴。
- 如果擦拭不乾淨，會有水滴殘留。

3. 將機身安裝於烘乾充電器上。(圖24)

將機身的正面(開關鍵的一面)向跟前，刀面朝下進行安裝。

注意

- 擦淨附於機身和外刀表面的水滴。
- 如果機身向前傾斜時，會有翻倒的情況，請注意。
- 除本機以外不可使用。

4. 按下烘乾開關。

烘乾中，烘乾開關為藍色，LED燈為紫色時，風扇旋轉。

烘乾後約15小時，G-SWORD字母慢慢閃爍(間隔2秒鐘)後熄燈。

· 烘乾時間進行約1.5小時。烘乾結束後自動變成LED抗菌模式，照射LED約15小時。(周圍溫度低於15°C時，傳感器檢測烘乾時間為約3小時，LED抗菌模式為約15小時。)

注意

如果未在機身正確安裝下按下烘乾開關時，烘乾開關的G-SWORD字母將快速閃爍(間隔0.5秒鐘)。請重新裝入機身。

⚠ 注意

烘乾中(烘乾開關的G-SWORD字母點亮時)不可從機身拔下。

(否則會因烘乾中LED燈或外刀發熱而導致燙傷)

5. 結束後，取出機身將電源變壓器從插座上拔下。

注意

絕對不可用水清洗烘乾充電器。(否則會造成故障)

6. 烘乾後，塗抹剃鬚刀潤滑油後，放置濕氣少的地方保存。

· 有關詳情請參照「清潔保養」(用水清洗)的第5~6項。

■ 為了能夠充分發揮鋰離子電池的性能

3個月以上未使用時，先進行放電直至電量指示燈(EMP)閃爍後，再進行約45分鐘的充電。

用清潔刷清潔

不可用清潔刷清潔內外刀組。

否則會造成內刀變形、外刀破損或毛刷屑掛在外刀上。

1. 將開關設為「OFF」後，拆下刀頭蓋和內外刀組。

有關內外刀組的拆卸方法，請參照「內外刀組的更換方法」。

2. 清潔機身、修剪刀。(圖25)

3. 清潔後，收存修剪刀，並裝上內外刀組和刀頭蓋，蓋上保護蓋。

有關內外刀組的安裝方法，請參照「內外刀組的更換方法」。

須知

每週一次，將開關設為「ON」，於外刀和修剪刀上塗抹附屬的剃鬚刀潤滑油，4~5秒鐘後將開關設為「OFF」，然後用紙巾等擦淨外刀和修剪刀表面。

· 對機身的髒污，可用擰乾的含有水稀釋廚房用洗劑(中性)的布擦拭乾淨。

注意

不可使用酒精、汽油或稀釋劑。(否則會造成變形或變色)

烘乾充電器的清潔保養 僅限RM-LTX7000DY

不可用水清洗烘乾充電器。

注意

· 用水清洗時，必須從烘乾充電器上拔下電源變壓器。

· 不可傾斜或倒置烘乾充電器。(否則會造成底座蓋內積存的水溢出或浸入內部)

1. 清潔底座蓋。(圖26) ㊟ 按下裝拆按鈕並拆下

· 按下裝拆按鈕可以拆下底座蓋。有積水時，注意不要傾斜。

· 倒掉水，用乾布或紙巾等輕輕擦淨。

注意

拆下底座蓋時，不可將烘乾充電器倒置，否則會因水滴浸入內部而導致短路。

· 清潔保養後，請裝上底座蓋。

2. 清潔內部。(圖27)

· 用水浸濕布或用紙巾等擦淨LED燈或內部粘附的垃圾、塵埃或髒污等。

· 角落或凹凸部，請用棉棒清潔。

內外刀組的更換方法

⚠ 注意

更換內外刀組時，必須先將電源插頭拔下，並將開關設為「OFF」。(否則會造成故障)

不可用力拿住內外刀組。(否則會損壞內外刀組造成手指受傷)

須知

更換刀片後，請務必噴灑剃鬚刀潤滑油。噴灑部位請參照「清潔保養」(用水清洗)的第5項。(否則會造成內刀不會旋轉或刀面發熱)

- 將開關設為「OFF」後，拆下保護蓋和刀頭蓋。(圖17)
按住刀頭蓋拆除鈕(1)，將刀頭蓋朝箭頭(2)方向取下。
- 拆下內外刀組。(圖28)
將內外刀組拆除鈕向右滑動(1)，捏住內外刀組兩端垂直向上拉拔(2)，即可拆下內外刀組。
· 不可斜著拉拔。否則會造成不能取下的情況。
- 按住刀頭蓋拆除鈕的下方，裝上新內外刀組。(圖29)
⑥0 對準標記(▼) ⑥1 對準標記(▲) ⑥2 將內外刀組和機身的標記(▼)、(▲)對準
⑥3 朝下按入內外刀組的兩端直至聽見「喀嚓」聲為止。 ⑥4 對準標記
注意
· 內外刀組浮起時會造成故障。
· 如果裝反內外刀組的前後則不能裝上。
- 確認內外刀組的安裝狀態。(圖30)
如果捏住內外刀組兩端輕輕拔出，則表示正常。
- 按住刀頭蓋拆除鈕的下方，裝上刀頭蓋。(圖21)
將刀頭蓋的正面對準開關鍵的一面。
注意
如果倒轉刀頭蓋的前後，則不能安裝內外刀組。

疑難排解

委託修理之前，請檢查以下情況。

現象	檢查部位	處理方法
<ul style="list-style-type: none"> · 刀面發熱。 · 鋒利度差。 · 旋轉力弱。 · 使用次數少。 · 使用中途停止。 	是否確實裝好內外刀組。 (有否出現浮起現象)	為避免與機身間產生間隙，應將內外刀組按入到底，直至發出「喀嚓」聲為止。 請定期進行清潔保養。
	刀片內側是否積存大量的鬍鬚屑。	
	刀面上是否缺油。	
<ul style="list-style-type: none"> · 將開關設為「ON」時，鬍鬚屑四處飛散。 · 異味嚴重。 	是否積存鬍鬚屑。	請定期進行清潔保養。
	清潔保養是否不充分。	
<ul style="list-style-type: none"> · 充電結束指示燈提早熄燈。 	是否充電已滿。	沒有異常。請繼續使用。
<ul style="list-style-type: none"> · 電量指示燈提早閃爍。 	未使用期間是否於3個月以上。	電量指示燈「EMP」閃爍時，表示必須充電。請進行充電。
<ul style="list-style-type: none"> · 將開關置於「ON」也不起動。 	<ul style="list-style-type: none"> · 是否需要充電。 · 是否積存鬍鬚屑。 · 是否刀面缺油。 	<ul style="list-style-type: none"> · 將開關置於「OFF」，充電約1分鐘後再進行使用。 · 一旦拔下電源變壓器，再次插入。 · 請定期進行清潔保養。
<ul style="list-style-type: none"> · 不能用烘乾充電器進行充電。 · 烘乾充電器不起動。(烘乾開關快速閃亮) 	<ul style="list-style-type: none"> · 電源變壓器是否正確連接。 · 機身是否正確裝在烘乾充電器上。 	<ul style="list-style-type: none"> · 確認電源變壓器是否正確連接。 · 確認機身插口是否正確插入充電連接器上。 · 請重新裝在機身上。

現象	檢查部位	處理方法
· 即使使用烘乾充電器也不能烘乾。	· 烘乾充電器內部是否粘附灰塵。	請定期進行清潔保養。
	· 用水清洗後，是否擦淨機身或刀面上的水滴。	· 擦淨機身或刀面上的水滴後再裝上。

檢查以上情況後，仍不能恢復正常時，切勿擅自修理，詳情請諮詢購買的經銷店。

規格

電源	電源變壓器 (KH-187B)	AC100-240V 50-60Hz通用 14VA		
	本體	蓄電池(鋰離子電池DC3.6V、1300mAh)1個		
充電時間	標準1.5小時	額定時間	5分鐘	
重量	本體:約200g 電源變壓器:約70g 烘乾充電器:約150g			
附件	旅行袋、剃鬚刀潤滑油、清潔刷			

棄掉產品時須知

⚠ 危險

取出蓄電池後，不可再充電以及進行以下事項。(否則會造成發熱、起火或破裂)

- 不可投入火中或加熱。
- 不可用釘子刺入或施加衝擊力、分解和改造。
- 不可用金屬接觸(+)和(-)。
- 不可與項鍊或髮夾一起搬運或保存。
- 不可放於火旁或炎暑高溫的地方。

⚠ 警告

不可將取出的蓄電池放於嬰兒或幼兒能拿到的地方。如果不小心飲入時，立即請醫師治療。蓄電池漏液時，不可用手觸摸，並進行以下處理。

- 液體浸入眼睛時，不可擦揉眼睛，立即用乾淨的水清洗後，請醫師治療。
 - 液體粘附身體或衣服時，必須用乾淨的水充分清洗後，請醫師治療。
- 請勿拆開產品,棄掉時除外。

■ 本產品中，還有其它可以回收再利用的零件。

棄掉零件時，請按照居住地區的有關條例等規定進行處理。

鋰離子電池的拆卸方法

1. 將開關設為「ON」，使鋰離子電池放電，直至剃鬚刀完全不轉為止。
 2. 拆下保護蓋、刀頭蓋以及內外刀組。
 3. 用(+)螺絲刀拆下後蓋的螺絲，並取下後板。(圖31) ⑥5 螺絲
 4. 用尖針插入前蓋板的遮蔽件B和遮蔽件C取下，用一字形螺絲刀等拆下卡爪，取下前蓋板。(圖32)
- ⑥6 遮蔽件C ⑥7 遮蔽件B ⑥8 卡爪 ⑥9 前蓋板 ⑦0 一字形螺絲刀
5. 拆下外殼蓋的2個(+)螺絲，取下外殼蓋。(圖33) ⑦1 外殼蓋
 6. 取出鋰離子電池，於電池根部附近分別切斷導線。(圖34)
- ⑦2 導線 ⑦3 鋰離子電池

⚠ 注意

不要將取出的鋰離子電池觸碰正(+)負(-)極導線。(否則會造成短路或燙傷)