

Instruction Manual

Hitachi

Cordless Stick Vacuum Cleaner

Model

PV-XL300J

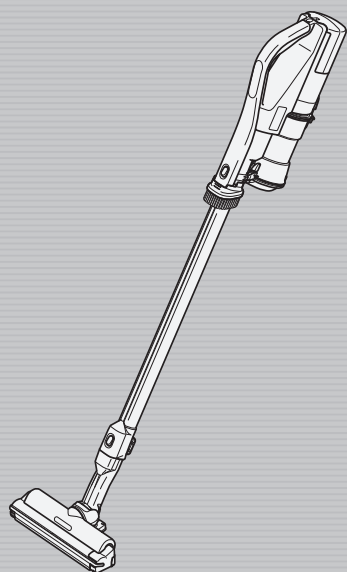

Thank you for purchasing a Hitachi Cordless Stick Vacuum Cleaner.

This vacuum cleaner is designed for household and indoor use only. Do not use for commercial, non-cleaning related, and outdoor purpose.

To ensure proper use, read this manual carefully before using the vacuum cleaner.

For future reference, keep this manual in an easily accessible place.

To ensure proper use, read the safety precautions (P.E-4 to E-8).

HITACHI

Inspire the Next

Contents

Before use

Part names and assembly.....	E-2
Safety precautions.....	E-4
Usage notes.....	E-8

To operate

Controls and indicators	E-8
Control buttons	E-8
Indicator during charging or use.....	E-9
Charging the vacuum cleaner....	E-10
To operate.....	E-12
Using the attachments.....	E-13
Power head.....	E-13
Handy brush.....	E-14
Crevice nozzle.....	E-15
Broom brush	E-15

Maintenance

Emptying the dust case and cleaning the filters.....	E-16
Checking the level of dust and debris in dust case....	E-16
Emptying the dust case	E-16
Cleaning the filters	E-18
Attaching the dust case	E-20
Maintenance	E-20
Vacuum cleaner, attachments, attachment accessories	E-20
Washable Parts	E-21
Maintaining (washing with water) the filters	E-21
Cleaning the power head.....	E-23

Appendix

Troubleshooting	E-25
Replacing the battery	E-28
Disposing of the vacuum cleaner....	E-28
Replacement parts.....	E-30
Specifications	E-30



Part names and assembly

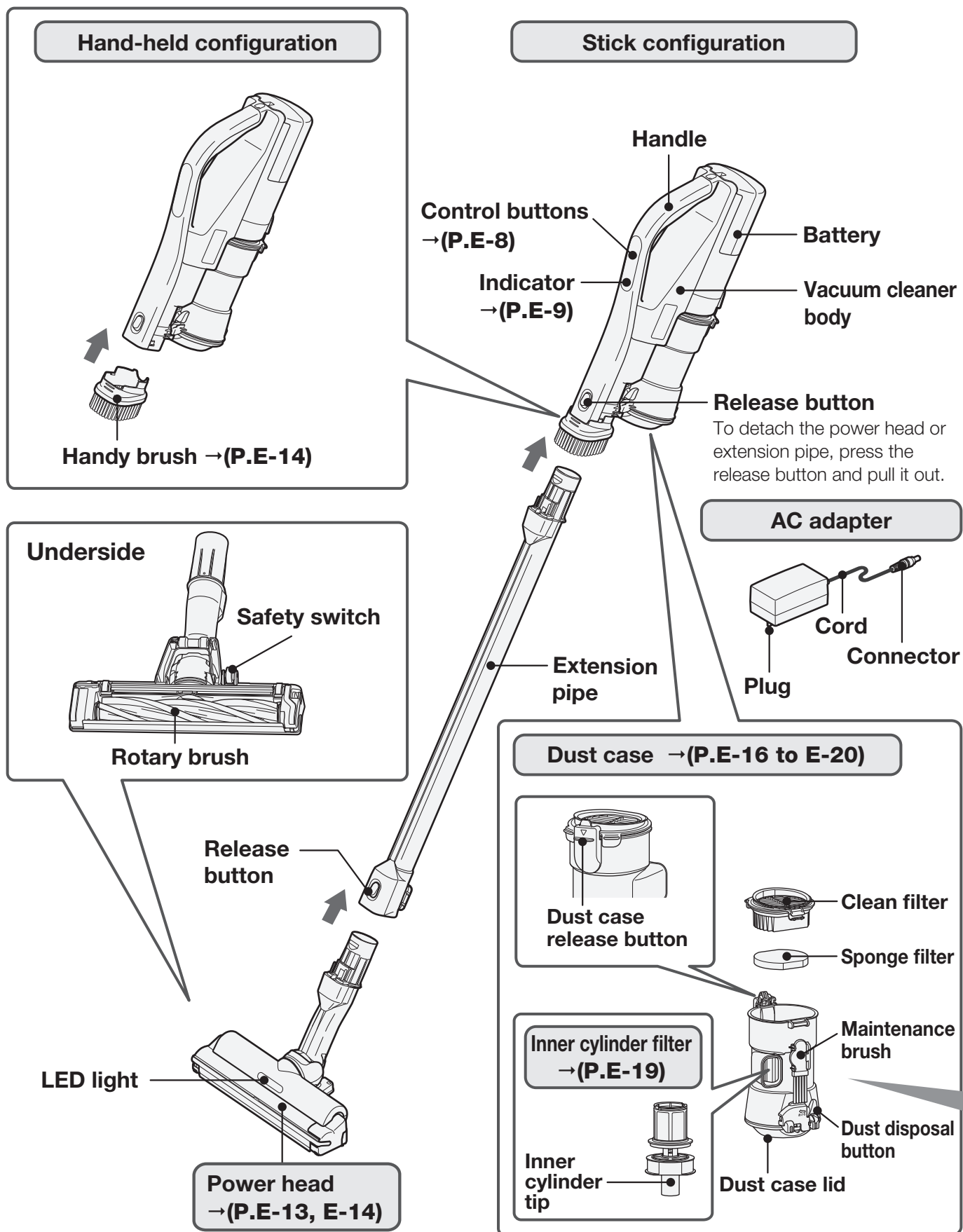

- If you shake the power head, it might make a rattling noise. This is normal.
- The fibers of the material might appear streaky in some of the black areas of the extension pipe, which is not abnormal.
- When attaching the power head and extension pipe, you might not hear a click, which is not abnormal.
- A protective film is attached to the control buttons and the model indicator label on the side of the vacuum cleaner.

Vacuum cleaner stand →(P.E-10)

Hook for the stand

Attachment groove

Insert the hook for the stand into the attachment groove of the stand.

The crevice nozzle or broom brush can be attached to the indent in the base.

Crevice nozzle Broom brush

Overall view when housed

Vacuum cleaner body

Extension pipe

Broom brush

Crevice nozzle

Power head

Vacuum cleaner stand

Stand

Base

Click

With your thumbs pressed against the lower part of the stand, hold the stand with both hands, and push the stand into the base until you hear a "click" sound.

Stand

Indent

Base

Attachments						
<p>Power head (1 pc.) (D-DP22) →(P.E-13, E-14)</p>	<p>Extension pipe (PVP-05) (1 pc.)</p>	<p>AC adapter (PVA-EX02-BS) (1 pc.)</p>	<p>Vacuum cleaner stand</p> <table style="width: 100%; border-collapse: collapse;"> <tr> <td style="width: 50%; border-right: 1px solid black; padding: 5px;"> <p>Base (1 pc.)</p> </td> <td style="width: 50%; padding: 5px;"> <p>Stand (1 pc.)</p> </td> </tr> </table>		<p>Base (1 pc.)</p>	<p>Stand (1 pc.)</p>
<p>Base (1 pc.)</p>	<p>Stand (1 pc.)</p>					



Attachment accessories			
<p>Maintenance brush (1 pc.)</p> <p>(Attached to the back side of the dust case)</p>	<p>Handy brush (1 pc.) →(P.E-14)</p>	<p>Crevice nozzle (1 pc.) →(P.E-15)</p>	<p>Broom brush (1 pc.) →(P.E-15)</p>



Safety precautions

Please follow these safety precautions.

This section describes safety precautions that must be followed in order to prevent injury to the user or other people, or damage to property. Please thoroughly read and follow the precautions in this manual.

■ The severity of injury or damage that might occur if these precautions are ignored or the vacuum cleaner is used improperly is classified and explained below. Hitachi is not responsible for any injury or damage that occurs as a result of ignoring these precautions.

	DANGER	This indicates warnings that, if ignored, could present imminent danger of serious injury or death.
	WARNING	This indicates warnings that, if ignored, could result in serious injury or death.
	CAUTION	This indicates warnings that, if ignored, could result in minor injury or property damage.

Warning symbols used in this manual	
	This indicates warnings or cautionary notes.
	This indicates prohibited actions that must not be performed.
	This indicates instructions that must be followed.

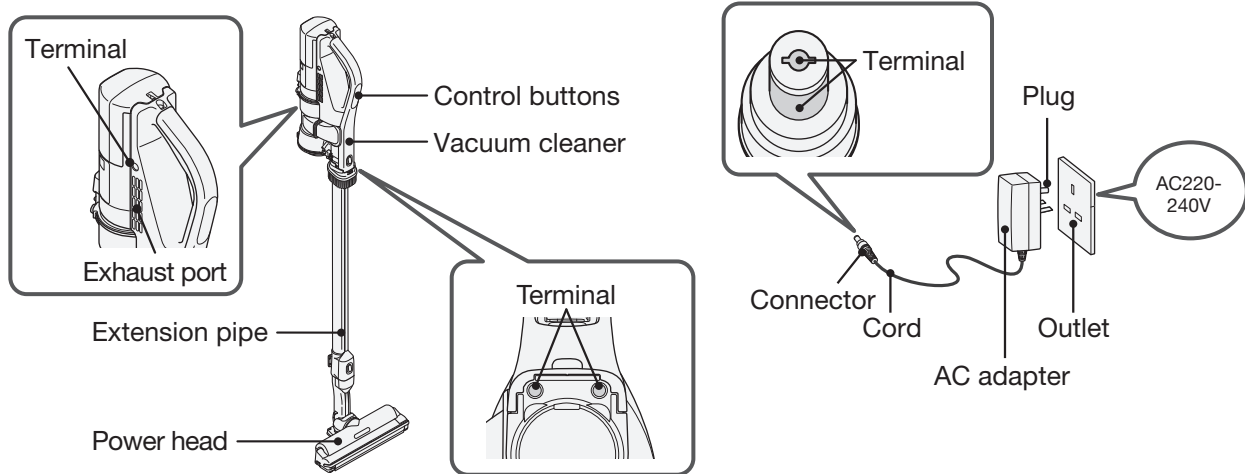

DANGER

-  ● **Do not repair or modify any part of the vacuum cleaner. Do not disassemble any part of the vacuum cleaner unless instructed to in this manual.**
Failure to heed this warning might cause leaking of the battery, the generation of heat, fire, or injury. For repairs, please contact a Hitachi authorized service agent.
- **Keep the vacuum cleaner and AC adapter away from water and other liquids.**
Failure to heed this warning might lead to rupturing of the battery, fire, malfunction, or electric shock.
- **Do not connect the terminals of the vacuum cleaner, extension pipe, and AC adapter with metal objects such as a wire and pin.**
Do not carry or store with metal necklaces, hairpins, etc.
Failure to heed this warning might cause the vacuum cleaner to malfunction or cause the battery to short-circuit, resulting in leaking, the generation of heat, rupturing, or fire.
- **Do not throw into fires or apply heat.**
- **Do not charge, use, or leave near sources of heat such as fire or a stove, under direct sunlight or in cars exposed to the sun, etc.**
Failure to heed this warning might cause the battery to leak, generate heat, rupture, smoke, fire, deform, or malfunction.

! WARNING

If the vacuum cleaner malfunctions or you notice any of the following problems, stop using the vacuum cleaner immediately.



- The vacuum cleaner does not turn on when you press a control button, even though the battery is fully charged.
- The power turns on and off when the AC adapter, cord, or connector is moved.
- The vacuum cleaner sometimes stops in operation.
- The vacuum cleaner makes strange sounds in operation.
- The vacuum cleaner or AC adapter is deformed or abnormally hot.
- The cord is damaged or abnormally hot.
- It smells like something is burning.
- You notice some other problem or malfunction..

Continuing to use the vacuum cleaner under these conditions could result in smoke, fire, or electric shock. Turn off the vacuum cleaner immediately and unplug the AC adapter from the outlet. Then, contact a Hitachi authorized service agent to request an inspection and repair.

Outlet, plug, cord, and AC adapter



- **Use an AC220-240V outlet.**
Do not use an extension cord, and do not plug the AC adapter in the same outlet as other appliances.
- **Periodically clean the plug of any dust and debris by using a dry cloth.**
- **Insert the plug of the AC adapter all the way into the outlet.**



- **Do not damage the cord.**
(Do not damage or modify the cord. Do not forcefully bend, bundle, pull, or twist it, and do not put it under heavy objects or pinch it between objects.)
- **Do not use the AC adapter if the cord or the plug or connector is damaged, and do not use a loose outlet.**
- **Make sure the cord does not get caught in the rotary brush of the power head.**
- **Do not handle the plug (insert the plug into an outlet or remove the plug from an outlet) with wet hands.**
- **Do not touch the terminals on the AC adapter or vacuum cleaner.**
- **To charge the vacuum cleaner, use the AC adapter that was provided with the vacuum cleaner. Do not attempt to charge the vacuum cleaner by using other AC adapters.**
- **Do not use the AC adapter that was provided with the vacuum cleaner to charge any other type of battery, even if the battery is a rechargeable battery.**

Failure to heed this warning might cause fire or electric shock.

Power head (inlet)



- **Do not touch the safety switch or the rotary brush.**
Failure to heed this warning might cause injury. Be careful especially around children.
- **Do not place the power head on parts of your body (on top of your feet, etc.) when pulling the power head.**
Failure to heed this warning might cause injury.

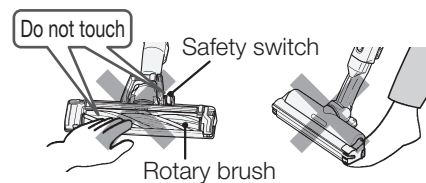

Others



- **Do not use the vacuum cleaner near inflammable or combustible items or materials (kerosene, gasoline, paint thinner, benzine, toner, iron powder, detergents, large amounts of flour, aerosol sprays, flammable gas, cigarette butts, etc.), or to clean up such items or materials.**
- **Do not use the vacuum cleaner to clean up things with sharp points (thumbtacks, needles, toothpicks, hairpins, etc.).**
- **Do not use the vacuum cleaner to clean up suds or foam from carpet cleaners or other types of detergents.**
- **Do not use the vacuum cleaner outdoors.**
- **Do not wash any part of the vacuum cleaner with water unless that part is listed as a part that can be washed. Do not use the vacuum cleaner in the shower or bathtub.**
- **Do not charge or store the vacuum cleaner in a location prone to high humidity.**
Failure to heed this warning might cause eruption, fire, electric shock, or injury.
- **Do not lean the vacuum cleaner against a wall or other surface.**
- **Make sure that the power head is attached when using the vacuum cleaner stand.**
The vacuum cleaner might fall over, becoming damaged or causing injury or damage to the floor.

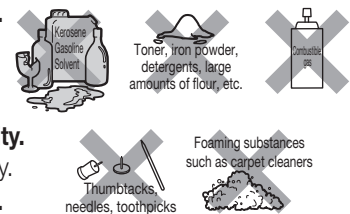

Safety precautions (Continued)

⚠ CAUTION

Socket, AC adapter, cord



- **When unplugging the AC adapter, hold and pull it not the cord**
- **When unplugging the AC adapter connector from the vacuum cleaner, hold and pull the tip of the connector, not the cord**
Holding and pulling the plug by the cord might damage the cord or cause a short circuit, which might result in an electric shock or fire.
- **If the cleaner is not used for a long period of time, be sure to unplug the AC adapter.**
Failure to do so might cause the insulation to deteriorate, which might result in an electric shock, short circuit, or fire.

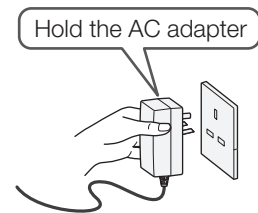

Power head (inlet), extension pipe



- **Do not let the vacuum cleaner run for an extended period of time with the inlet blocked.**
Failure to heed this warning might cause overheating, leading to fire or the deformation of the vacuum cleaner and power head.
- **Before performing maintenance on the vacuum cleaner, remove the power head from the vacuum cleaner.**
Failure to heed this warning might cause injury.
- **Do not attach the parts of this vacuum cleaner to other products, or attach the power head of other products to this vacuum cleaner.**
Failure to heed this warning might cause overheating, leading to fire or the deformation of the power head.
- **Do not clean using the tip of the extension pipe, and do not insert pins or other items in the area joining the vacuum cleaner to the extension pipe.**
Failure to heed this warning might cause short-circuiting, resulting in electric shock, fire, or damage to the vacuum cleaner or to the floor.
- **Do not move the power head left and right while they are facing forward.**
Failure to heed this warning might cause damage to the floor.
- **Do not use with foreign objects attached, such as sand or pebbles.**
Failure to heed this warning might cause damage to the floor.
- **Do not use the vacuum cleaner under or in between blankets.**
Failure to heed this warning might cause overheating, leading to fire or the deformation.

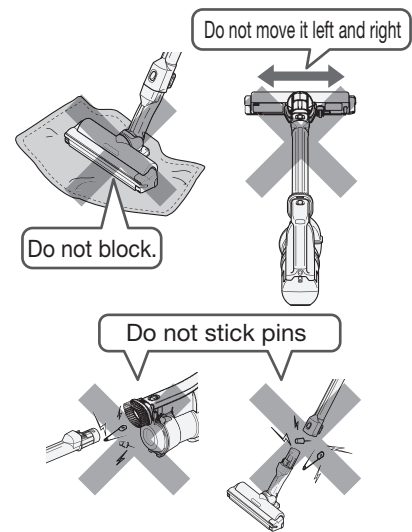

Exhaust port



- **Do not block the exhaust port.**
Failure to heed this warning might cause overheating, leading to fire or the deformation of the vacuum cleaner.
- **Do not expose your body to the air released from the exhaust port for long periods of time.**
Failure to heed this warning might cause minor burns.

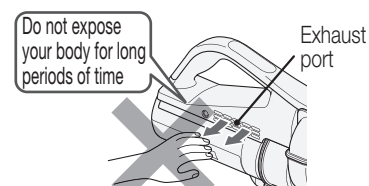

Others



- **When carrying the vacuum cleaner, do not hold the dust case.**
The vacuum cleaner might fall and cause injury or damage the floor.
- **Keep away from fire.**
Failure to heed this warning might cause short-circuiting due to vacuum cleaner deformation, resulting in fire.
If the vacuum cleaner is used near a flame, exhaust from the vacuum cleaner might cause the flame to grow into a conflagration.
- **Turn off the vacuum cleaner before performing maintenance.**
Failure to heed this warning might cause injury.
- **Do not carry the vacuum cleaner around while it is attached to the vacuum cleaner stand.**
The vacuum cleaner might fall off, which could cause an injury or damage the floor.
- **Do not clean using the tip of the vacuum cleaner without the handy brush.**
Failure to heed this warning might cause short-circuiting, resulting in electric shock, fire, or damage to the vacuum cleaner or to the floor.
- **Do not drop the vacuum cleaner, power head, extension pipe, AC adapter, vacuum cleaner stand, or attachment accessories from high places.**
Failure to heed this warning might cause injury or damage to the floor or dropped part.
- **Do not place the vacuum cleaner stand on an unstable surface.**
The vacuum cleaner might fall over, becoming damaged or causing injury or damage to the floor.
- **Do not place the vacuum cleaner stand in places with high condensation or humidity.**
Failure to heed this warning might cause floor discoloration.
- **Do not look directly at the LED light.**
Failure to heed this warning might cause damage to your eyes.

Others



- Children should be supervised to ensure that they do not play with the appliance.
- This appliance is not intended for use by persons (including children) with reduced physical, sensory or mental capabilities, or lack of experience and knowledge, unless they have been given supervision or instruction concerning use of the appliance by a person responsible for their safety.
- Only allow children at least 8 years old to use the AC adapter. Give sufficient instruction so that the child is able to use the AC adapter in a safe way and explain that it is not a toy and must not be played with.
- Instruct the child not to try and recharge non-rechargeable batteries because of the danger of eruption.
- Cleaning and user maintenance shall not be made by children without supervision.

Battery (lithium-ion battery)

DANGER



- Do not connect the battery to anything other than this vacuum cleaner. Do not disassemble, modify, or solder the battery. Do not charge the battery when it is not connected to the vacuum cleaner. Replacement of the battery is to be performed by a trained service technician. Do not remove the battery except when disposing of this vacuum cleaner.
Please consult with a Hitachi authorized service agent.
- Do not touch the terminals or connect them by using metal items such as wires and pins.
- Do not transport or store the battery in the same container as metal objects such as necklaces, hairpins, coins, or keys.
- Do not subject the battery to strong physical shock. For example, do not put nails into the battery, hit the battery with a hammer, step on the battery, or throw the battery.
- Keep away from fire.
- Do not leave the battery near sources of heat such as a fire or stove, under direct sunlight, or in a car under the sun.
- Do not use any battery other than the one specified for this vacuum cleaner.
- Do not put the battery in a microwave or an oven.
- Do not submerge the battery in water or other types of liquid, or expose it to water or other types of liquid.

Failure to heed this warning might cause the battery to leak, generate heat, rupture, smoke, fire, electric shock, or injury.



- If the liquid inside the battery enters your eyes, do not rub your eyes, but thoroughly wash them with clean water immediately, and then consult a doctor.
Failure to do so might cause damage to your eyes.

WARNING



- Do not use the battery if it is leaking or has an abnormal odor, discoloration, deformation, or damage due to being dropped or you notice something unusual.
Failure to heed this warning might cause the generation of heat or smoke, rupturing, or fire. If liquid from the battery leaks onto the floor, it might damage the floor.
- If the battery is leaking, do not touch it with bare hands.
Failure to heed this warning might cause skin irritation.
- Keep the battery away from infants and children.
Failure to heed this warning might cause electric shock or injury.



- If liquid from the battery gets on your clothes, immediately wash them in clean water. If the liquid gets on your skin, consult a doctor.
Failure to heed this warning might cause skin irritation.

Safety precautions (Continued)

CAUTION



- **When charging the battery, ensure that the ambient temperature is between 5°C to 34°C.**
Charging the battery in temperatures outside of this range might prevent the battery from being fully charged. As a result, the battery might take a long time to charge, or you might only be able to use the vacuum cleaner for a short time. Failure to heed this warning might cause the battery to deteriorate.
- **If the battery is still charging longer than the specified charging time, unplug the AC adapter.**
- **Do not touch the battery for a long period of time while charging or operating the vacuum cleaner.**
Failure to heed this warning might cause minor burns.
- **Store the vacuum cleaner in a location with low humidity or little dust and debris.**
Failure to heed this warning might cause the generation of heat or smoke, rupturing, or fire.

Usage notes

To prevent malfunction and other problems, be sure to follow these instructions.

Be sure to thoroughly read these instructions, as well as those indicated by **Note** in other locations in this manual, and to use the vacuum cleaner in accordance with these instructions.

- **Do not subject the vacuum cleaner, the power head, extension pipe, vacuum cleaner stand, AC adapter, or attachment accessories to strong physical shock.**
Failure to heed this warning might cause the deformation or damage.
- **Do not use the vacuum cleaner to clean up the following objects.**
Failure to heed this warning might cause strange odors or malfunction.
 - Water or other liquids, wet objects, or desiccants
 - Large amounts of sand or powder, long string or thread, or glass
- **Do not ride on the vacuum cleaner, the power head, vacuum cleaner stand, or attachment accessories.**
Doing so might cause malfunctions.
- **Wash the parts with water and air dry them in the shade.**
Failure to heed this warning might cause strange odors or malfunction.

Controls and indicators

Control buttons

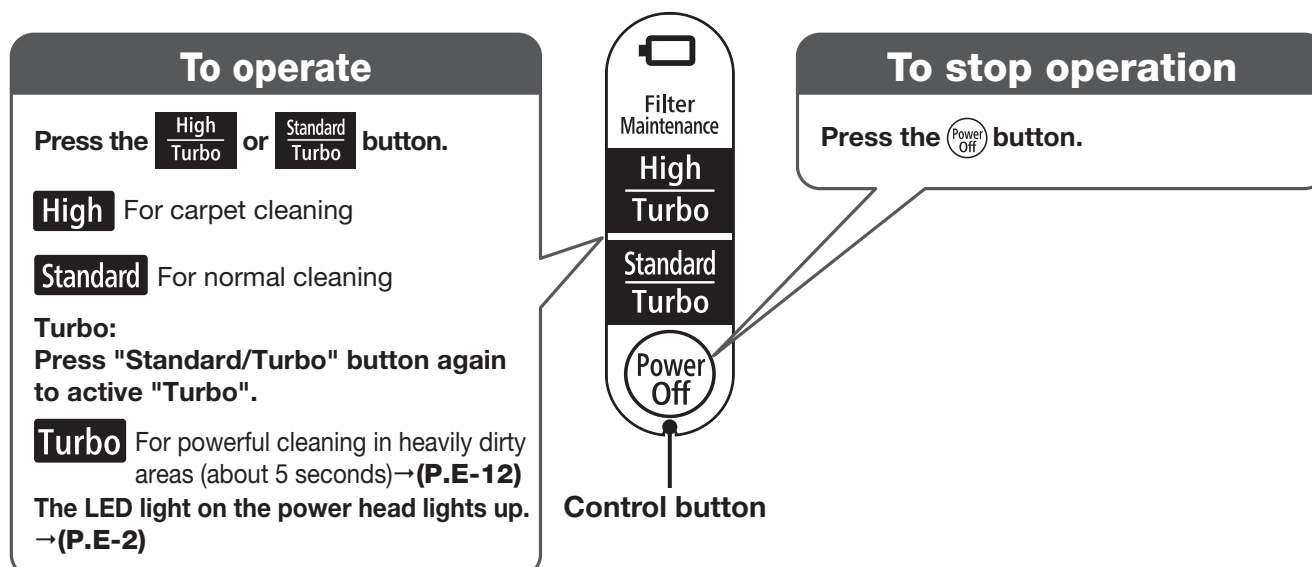

Indicator during charging

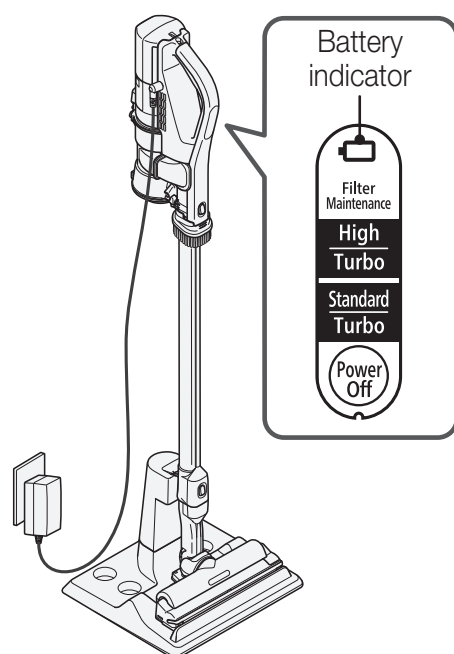

Battery indicator	Charging status
On	The battery is charging. Charge time is approx. 3.5 hours. Depending on the ambient temperature, usage time, etc, if the battery's temperature is very hot, charging may automatically go into standby until the temperature lowers to an appropriate temperature for charging, causing the charging time to increase. →(P.E-28)
Off	The battery is fully charged. When the battery is fully charged, the battery indicator turns off.

- * If the battery indicator blinks rapidly (about two times per second), this indicates an abnormality with the AC adapter or the battery. →(P.E-28)
- * If you disconnect the AC adapter connector from the vacuum cleaner after the battery indicator turns off, and then connect it to the vacuum cleaner back, the battery indicator turns on, but this does not indicate a problem with the vacuum cleaner.



WARNING

Do not touch the terminals on the AC adapter or vacuum cleaner.

Failure to heed this warning might cause electric shock or injury.

Indicators during use

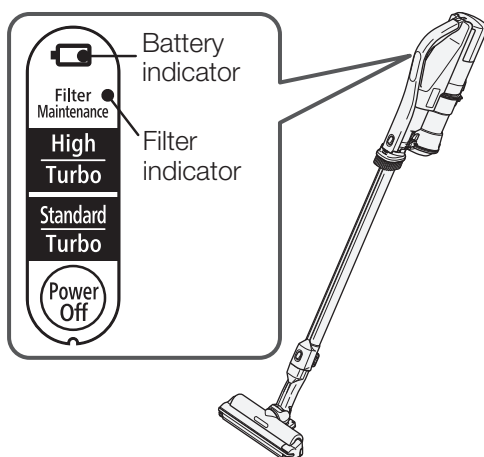

Indicator		Operating status
	Off	The remaining battery level is high.
	Blinking (about once per second)	The remaining battery level is low. Charge the battery.
	Blinking (about once per second)	The filter needs to be cleaned →(P.E-18, E-19, E-21, E-22) .

- * Depending on the environment in which the vacuum cleaner is to be used, the battery indicator might start blinking earlier.
- * If the battery indicator blinks rapidly (about two times per second), this indicates an abnormality with the battery. →(P.E-28)
- * If the battery indicator blinks slowly (about once per four seconds), this indicates that the vacuum cleaner might be running in safe mode with reduced suction power in order to prevent overheating of the vacuum cleaner's motor or battery. →(P.E-25)
- * The filter indicator does not blink while the vacuum cleaner is being operated in the Standard setting.



CAUTION

If the filter indicator blinks, do not repeatedly start and stop operating the vacuum cleaner without cleaning the filter.

Failure to heed this warning might cause a malfunction.

If the filter indicator on the vacuum cleaner blinks while the vacuum cleaner is running:

- Empty the dust case and remove any dust and debris attached to each of the filters. →(P.E-16 to E-19)
- If the filter indicator on the vacuum cleaner blinks while the vacuum cleaner is running, even though dust and debris has already been removed from each filter, wash each filter with water. →(P.E-21, E-22)

Charging the vacuum cleaner

Charge the battery before using the vacuum cleaner. The battery is not fully charged at the time of purchase. It generally takes about 3.5 hours to charge the battery. (It might take longer to charge the battery depending on factors such as the ambient temperature and how long the vacuum cleaner was in use.)

1 Plug the AC adapter into an outlet.



WARNING

Do not use an AC adapter other than the adapter that was included with the vacuum cleaner. Failure to heed this warning might cause electric shock, injury, or malfunction.

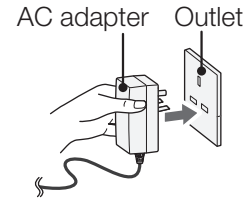

2

Charging on the vacuum cleaner stand

1 Dock the vacuum cleaner on the vacuum cleaner stand.

- Insert the hook for the stand into the attachment groove of the stand.

2 Insert the connector of the AC adapter into the terminal on the vacuum cleaner.

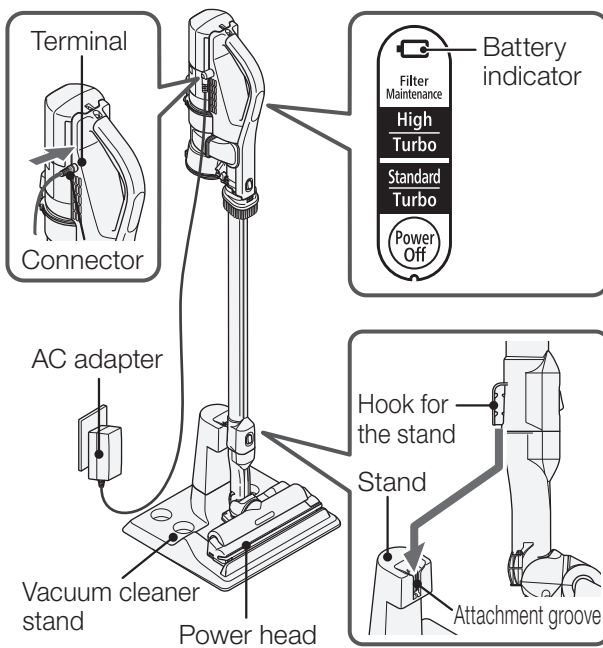

WARNING

Risk of injury

Make sure that the power head is attached when using the vacuum cleaner stand. The vacuum cleaner might fall over, becoming damaged or causing injury or damage to the floor.



CAUTION

Risk of damage to the floor.

- Place the vacuum cleaner stand on a flat surface such as the floor.
- Do not drag the vacuum cleaner stand or the vacuum cleaner while it is resting on the floor or any other flat, level surface.

Direct Charging

Insert the connector of the AC adapter into the terminal on the vacuum cleaner.

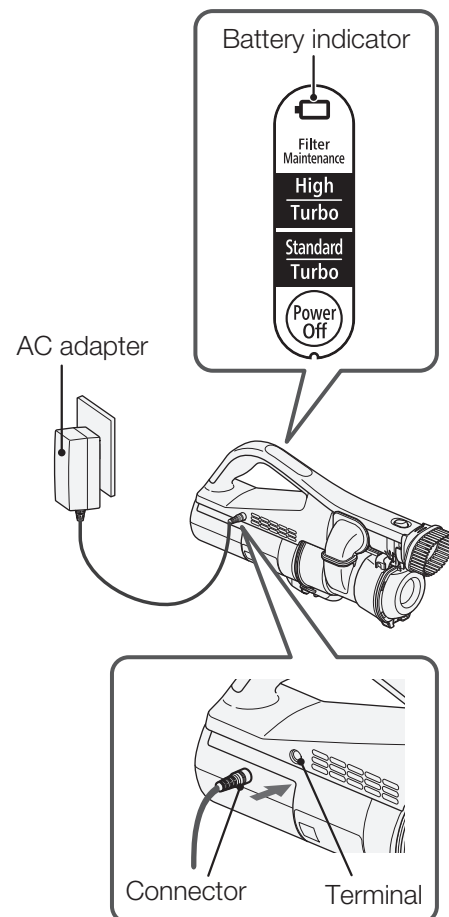

CAUTION

Risk of damage to the floor.

- When inserting the connector into the vacuum cleaner to charge, place the vacuum cleaner on a flat surface e.g. floor.
- Do not drag the vacuum cleaner while it is resting on a flat surface e.g. floor.

When it is used for the first time or when it is not used for several days,

- The operating time might become shorter or the charging time might become longer.
 - We recommend that you replug the connector into the vacuum cleaner to recharge the battery before use.
- When you insert the connector into the terminal of the vacuum cleaner, the battery indicator lights up.
 - If you disconnect the AC adapter from the vacuum cleaner after the battery indicator turns off (indicating that the battery is fully charged), and then reconnect the AC adapter to the vacuum cleaner, the battery indicator turns on (indicating that the battery is being charged), but this does not indicate a problem with the vacuum cleaner.
 - While the vacuum cleaner is being charged, the vacuum cleaner or AC adapter might become hot, but this does not indicate a problem with the vacuum cleaner.
 - The vacuum cleaner will not operate even if the control buttons is pressed while charging.

Note

- When charging the battery, make sure the ambient temperature is between 5°C to 34°C. Charging the battery in temperatures outside of this range might prevent the battery from being fully charged. As a result, the battery might take a long time to charge, or you might only be able to use the vacuum cleaner for a short time.
If you charge the battery in a hot or cold area for 3 hours or more, the battery indicator will blink rapidly (estimated twice per second). In this case, recharge it in place with an ambient temperature between 5°C to 34°C.
- If the battery indicator does not turn on, or it turns on briefly and then turns off, remove the connector of the AC adapter from the vacuum cleaner and then insert the connector back into the vacuum cleaner.
- Charging it near a radio might cause sound interference when the radio is in operation.
When charging the vacuum cleaner, plug the AC adapter into an outlet that is at least 2 meters away from any radio equipment.

To prolong battery life

- Be sure to charge the vacuum cleaner after each use, even if you only used the vacuum cleaner for a short period of time.
- If the vacuum cleaner is not to be used for more than a month, please fully charge the battery before storing it. Charging it once a year if the vacuum cleaner is not in use will prolong the battery life. (Storing a depleted battery will deteriorate the battery performance and battery life.)
- If the vacuum cleaner stops in the middle of operation, because the battery has run out, you might still be able to use the vacuum cleaner for a short while by pressing the control buttons. However, this type of action is not recommended. Performing this type of action will shorten the battery life.

To operate

1 Remove the connector of the AC adapter from the vacuum cleaner.

Hold the connector of the AC adapter and pull it out *direction as shown in the right diagram.
If you press the control buttons during charging, the cleaner will not operate.

⚠ CAUTION

When unplugging the connector, hold it. Do not pull on the cord.

Pulling on the cord might damage the cord and cause short-circuiting, resulting in electric shock or fire.

Note Do not subject the connector to excessive force.
Doing so might cause malfunctions.

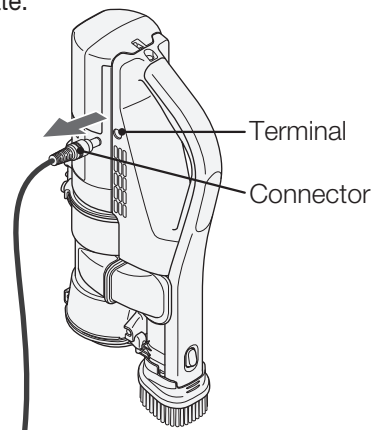

2 Attach an attachment.

When replacing an attachment, remove it by pushing the release button and pulling the attachment in the direction of the arrow.

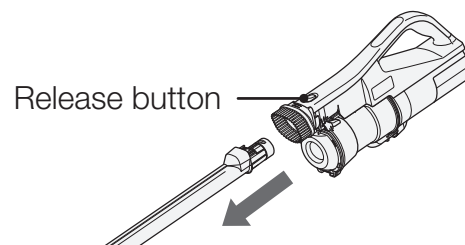

3 Press the **High Turbo** or **Standard Turbo** button.

The continuous operating time of the vacuum cleaner is approximately 8 minutes if used on the High setting, approximately 30 minutes if used with the power head on the Standard setting, and approximately 45 minutes if used without the power head on the Standard setting.

* The operation time may be shorter in cold places.

Press the same control button again during operation.

Turbo: Operates for 5 seconds. Suction is higher than "High" setting. Resume back to original setting after 5 seconds.

* To switch to the High or Standard setting while operating in the Turbo setting, press the **Power Off** button to end operation, and then press the **High Turbo** or **Standard Turbo** button again.

* To repeat Turbo operation, return to original setting and restart Turbo setting.

* Using the Turbo setting will shorten the continuous operation time. To protect the vacuum cleaner motor, the Turbo setting may not be available when the battery level is low or if the filter is clogged.

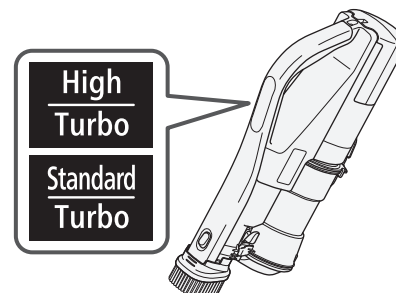

⚠ CAUTION

Risk of injury or damage to the floor.

Do not strongly press or hit the vacuum cleaner against the floor.

The vacuum cleaner might be deformed or the dust case might fall.

4 To stop, press **Power Off**.

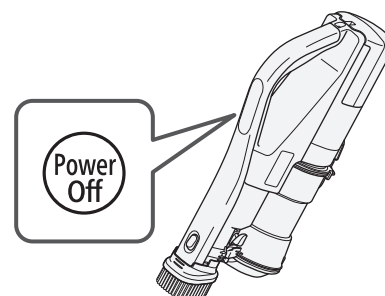

5 Charge the vacuum cleaner after using it. →(P.E-10)

Using the attachments

CAUTION

Risk of damage to the floor

If you move the vacuum cleaner while protrusions such as the vacuum cleaner or dust case are in contact with the floor surface, the floor surface might be damaged.

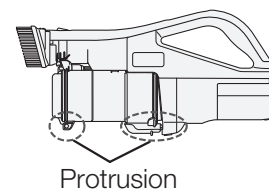

Power head

Use in accordance with the floor type

Vacuum efficiently and thoroughly by moving the power head back and forth across floor. Please use it by attaching it to the inlet of the vacuum cleaner or the extension pipe.

Carpet

Clean by moving back and forth. Dust and debris will be collected thoroughly when pulling back.

When cleaning a new carpet for the first time, the cleaner might collect many loose threads.

Flooring/Tatami

To prevent damage to the floor, move along the grain of the flooring.

- When cleaning a new tatami, its surface might become polished.

- If dust and debris still remain on the floor after you move the vacuum cleaner toward you, lift the power head and then move the vacuum cleaner away from you (back over the dust and debris).

WARNING

Risk of injury

Do not place the power head on parts of your body (on top of your feet, etc.) when pulling the power head.

It might get your body parts caught in the rotary brush.

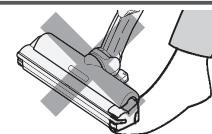

CAUTION

Risk of damage to the floor

Do not leave the power head in the same position while the vacuum cleaner is running.

Do not firmly press the power head against the floor.

- The floor might be damaged if it is easily damaged especially such as cypress or padded flooring*.

* Padded flooring is flooring where the surface is cushioned using vinyl chloride, etc.

- Firmly pressing the power head against uneven surfaces such as thresholds might wear out the wheels and damage the floor.

- If dust and debris gets tangled in the wheels, the wheels cannot rotate, which might cause wear and tear and floor damage.

- After extended use, the brushes, wheels, and rotary brush might wear down. Using the power head while they are worn out might damage the floor. You cannot replace the brushes or wheels by yourself. Please contact a Hitachi authorized service agent to have the brushes, wheels, and rotary brush replaced as a set. The rotary brush can be purchased as a replacement part. →(P.E-30)

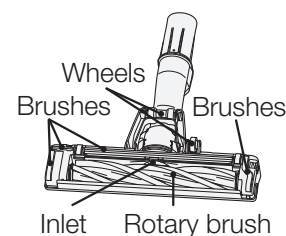
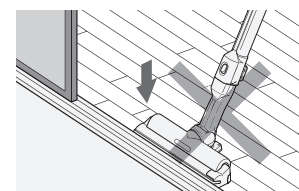

Note

- The vacuum cleaner might have difficulty vacuuming in Turbo mode depending on the floor type e.g. carpets with long fibers. In such case, switch to "Standard" setting. In such case, switch to the "Standard" operation.

- If the suction power becomes weak, there might be dust and debris blocking the power head inlet. In this case, perform maintenance for (wash with water) each filter. →(P.E-21, E-22)

- Do not push the power head against the floor with excessive force, because the power head might leave a mark on the floor.

If the power head leaves a mark on the floor, please refrain from using the vacuum cleaner in that area, and remove the mark by using a soft cloth.

Using the attachments (continued)

The safety switch of the power head

When you lift the power head from the floor, the safety switch activates and the rotary brush stops rotating for your safety.

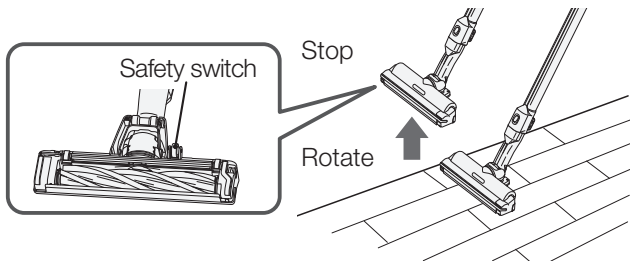

For information on maintaining the safety switch, →(P.E-23)

⚠ WARNING

Risk of injury
Do not touch the safety switch or the rotary brush of the power head.

The rotary brush might rotate.
Be careful especially around children.

■ Multi angle head

Turning the handle changes the orientation of the power head. Narrow places can be efficiently vacuumed.

Rotate to the left

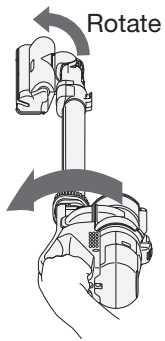

Rotate to the right

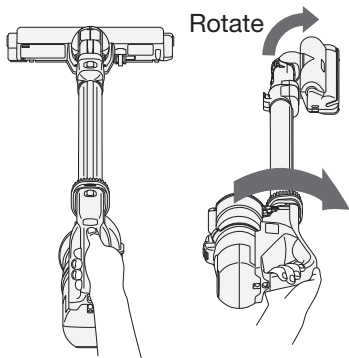

⚠ CAUTION

Risk of damage to the floor

- Do not move the power head left and right while they are facing forward.
- Do not pull the power head backwards while holding it aloft.

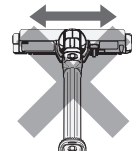

Risk of damage

- Do not strongly hit the power head against a wall or corner.
- Do not press hard against the floor surface with the power head facing left or right.

Handy brush

Attach to the vacuum cleaner before use.

Attachments can be applied while the handy brush is attached to the vacuum cleaner.

Attaching the handy brush

- 1 Match the position of the protrusion on the side of the handy brush with the groove on the vacuum cleaner.
- 2 Press in the direction of the arrow.

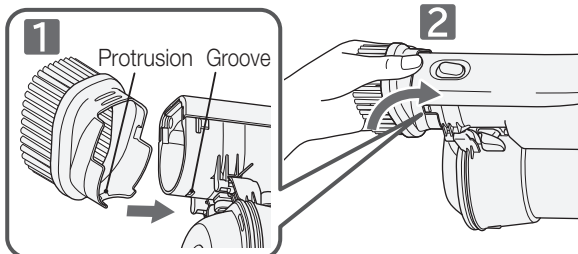

Detaching the handy brush

Press the grooved area of the handy brush and pull in the direction of the arrow.

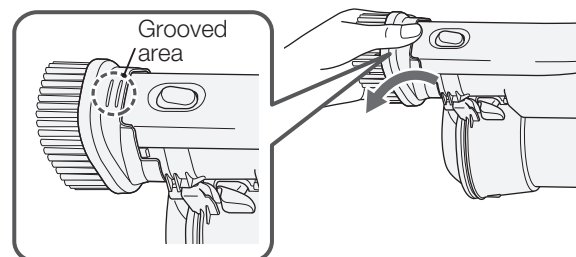

⚠ CAUTION

Risk of electric shock, fire, malfunction or damage.

- Do not clean using the tip of the vacuum cleaner without the handy brush.
- Do not press against items that are particularly easy to be damaged, such as pianos.

Note

- It might be damaged if excessive force is applied. If the handy brush is pressed down on floors with too much force, it might become damaged, crack, or damage to the floor.
- The handy brush can be washed with water. After washing, dry it thoroughly in the shade before using. Using it while it is still wet might result in malfunction.

Crevice nozzle

It is used to clean narrow spaces and corners. Please use it by screwing to the inlet of the vacuum cleaner or the extension pipe.

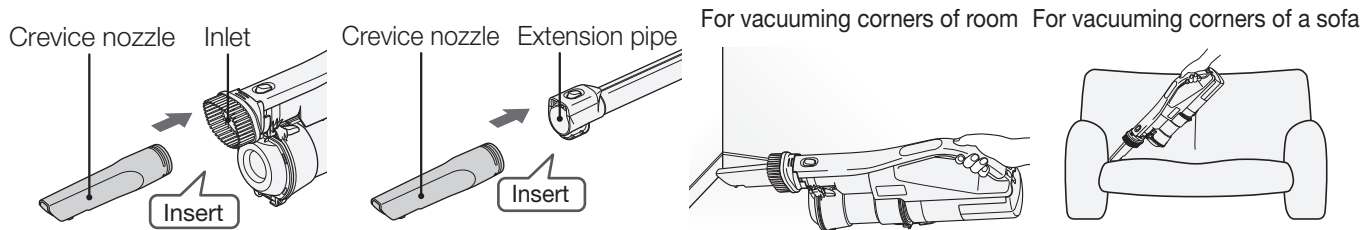

Broom brush

The combination of a broom-like brush and a thin tube is convenient for cleaning sash grooves. You can change the angle according to the place you want to clean. Please use it by attaching it to the inlet of the vacuum cleaner or the extension pipe.

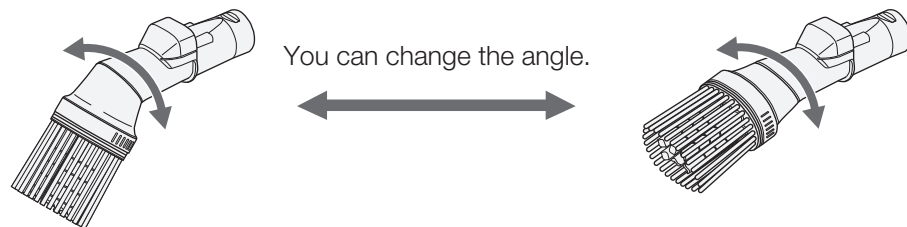

CAUTION

Risk of damage

Do not press against areas that are particularly easy to be damaged, such as pianos.

Note

- It might be damaged if excessive force is applied.
 - Do not drop or apply too much force in the direction of the **A** arrow.
 - If the tube is pressed down on floors with too much force, it might become damaged or cracked.
 - When changing the angle, rotate the brush while holding the grooved area part.
- Do not strongly press the tube against the floor since it might leave a mark on the floor. If the tube leaves a mark on the floor, refrain from using it at that location, and remove the mark using soft cloths, etc.
- The broom brush can be washed with water. After washing, let the brush dry thoroughly in the shade, and use it. If you use it while it is wet, it might cause an abnormal odor or malfunction.
- If there is dust on the tip or inside the nozzle, the suction power will reduce, so remove the dust using tools such as tweezers.

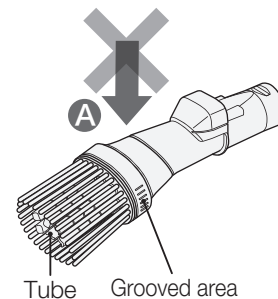

When the brush part comes off from the base part (how to attach the brush part)

- 1** Hold the grooved area of the brush part and align the groove of the brush part with the protrusion of the base part.
- 2** Press until it fits entirely.
- 3** Rotate the brush side to the state of the diagram.

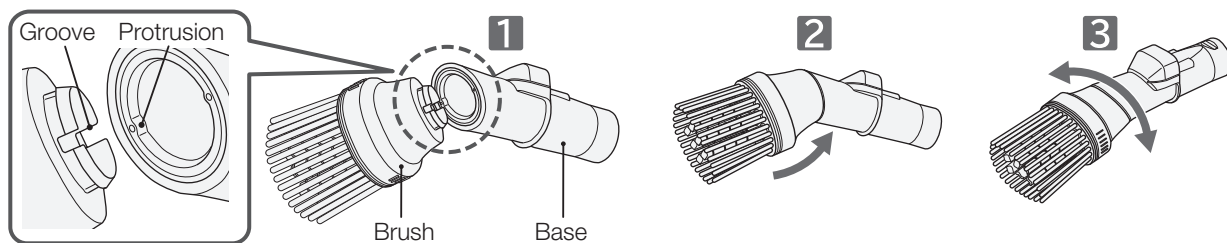

Emptying the dust case and cleaning the filters

Cyclonic vacuum cleaners have the advantage of not requiring paper filter bags. To vacuum with strong suction power, we recommend that you remove dust every time you use your cleaner and clean the filter frequently.

- Empty the dust case before exceeding the "Max line" (guideline). If dust rises above the "Max line", it might be difficult to remove the dust from the dust case.
- Dust might not rotate depending on the type of dust and how it accumulates. This is normal.

Note Fine dust might disperse in the air when the dust case is emptied. Empty the dust case in a well-ventilated environment such as outdoors, or wear a mask and avoid breathing in the dust.

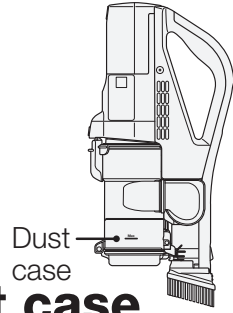

Checking the level of dust and debris in dust case

Check whether the dust and debris in the dust case has reached the max line.

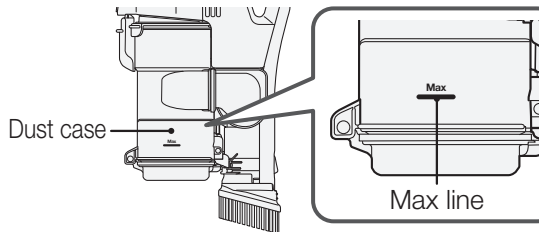

- When dispose the dust and debris from the dust case, remove the dust and debris adhered to the dust case and clean the filter. →(P.E-16 to E-18)
- If dust and debris is wrapped around the inner cylinder filter and cannot be removed, detach and maintain the inner cylinder filter. →(P.E-19)

Emptying the dust case [when attached to the vacuum cleaner]

1 Tilt the vacuum cleaner and position the dust case to face the trash can.

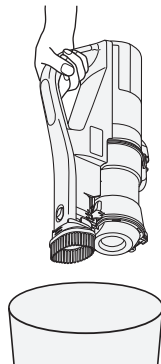

2 Press the dust disposal button.

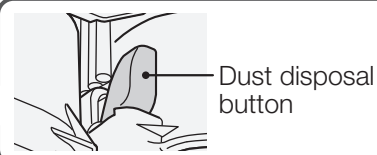
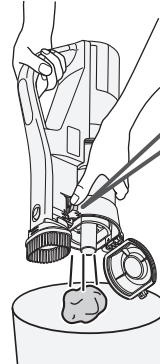

Note

Dust and debris might be hard to remove depending on the type of dust and debris and how it accumulates. Add vibration by tapping the sides of the dust case or detaching the inner cylinder filter →(P.E-19)

2 Remove attached dust and debris.

Remove the dust and debris and fine dust and debris using soft cloths, etc.

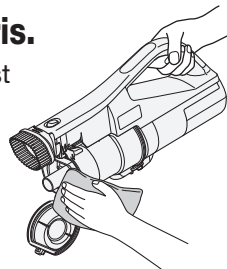

CAUTION

Risk of injury

You might have unintentionally vacuumed sharp objects such as glass shards or pins. Be careful when performing maintenance.

3 Close the dust case lid.

Close until you hear a "click" sound.

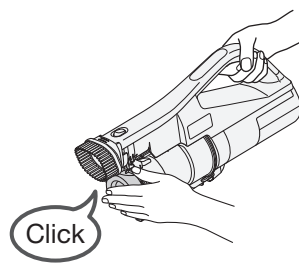
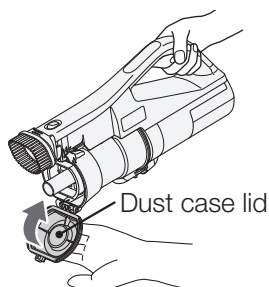

Note

In order to maintain strong sucking power, regularly perform frequent maintenance of the filter. →(P.E-18, E-19, E-21, E-22)

Emptying the dust case [When removed]

1 Remove the dust case.

1 Hold the dust case and pull down the dust case release button.

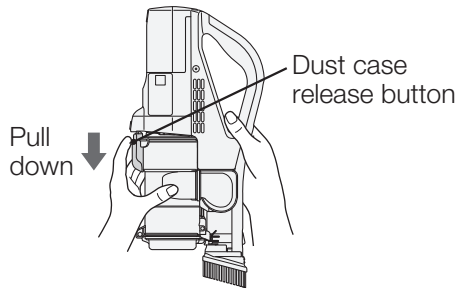

2 Pull out the dust case in the arrow direction.

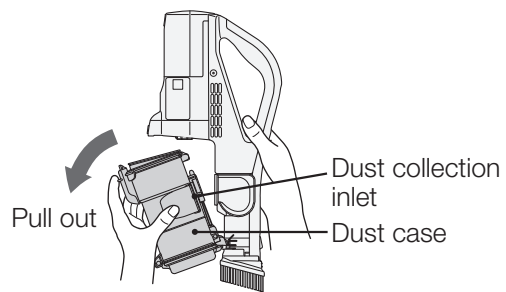

- Note**
- Do not detach the dust case with the vacuum cleaner set down. Dust and debris might spill.
 - If dust and debris spills inside the vacuum cleaner, remove the dust and debris and attach the dust case as it was.
 - Do not turn the dust and debris collection inlet downward when holding the dust case or placing it. Dust and debris might spill.

2 Open the dust case lid and empty the dust case.

Make sure the dust case lid is facing down, and then press the dust and debris disposal button.

Note

Dust and debris might be hard to remove depending on the type of dust and debris and how it accumulates. Add vibration by tapping the sides of the dust case or detaching the inner cylinder filter. →(P.E-19)

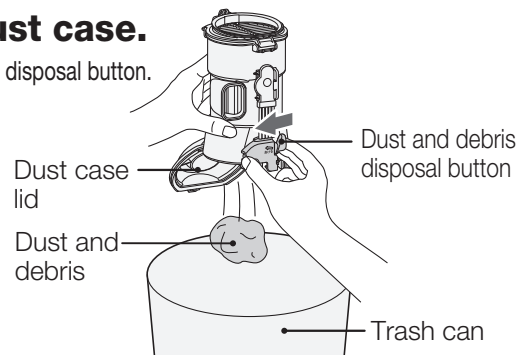

3 Remove attached dust and debris.

1 Detach the maintenance brush attached to the back side of the dust case.

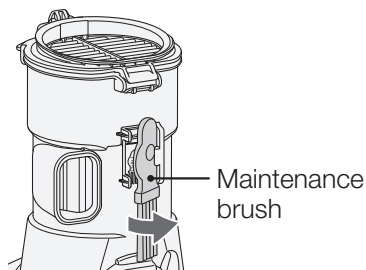

2 Remove the dust and debris and fine dust and debris with the maintenance brush.

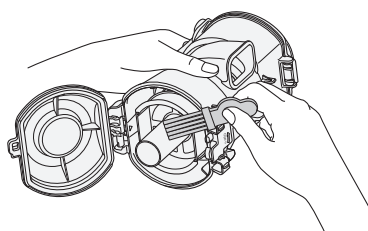

CAUTION

Risk of injury
You might have unintentionally vacuumed sharp objects such as glass shards or pins. Be careful when performing maintenance.

4 Close the dust case lid.

Close until you hear a "click" sound.

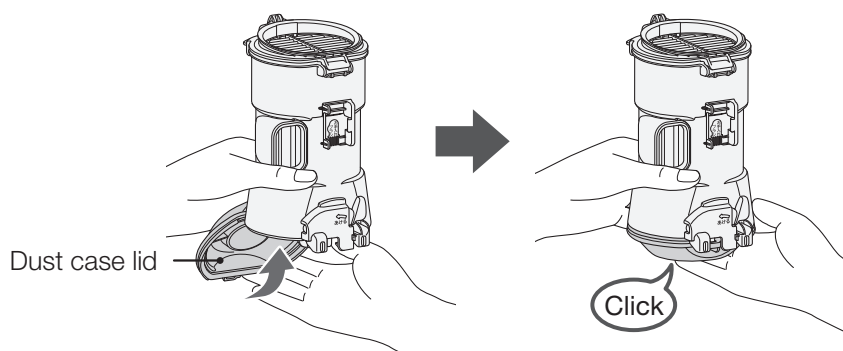

Note

In order to maintain strong sucking power, regularly perform frequent maintenance of the filter. →(P.E-18, E-19, E-21, E-22)

Emptying the dust case and cleaning the filters (continued)

Cleaning the filters

Clean filter

1 Open the clean filter.

1 Set the dust case on the floor.

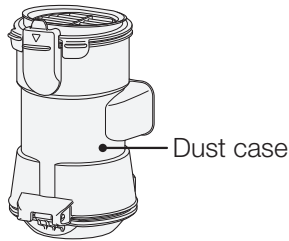

2 Grab and hold the lower part of the dust case, lift up the knobs of the clean filter, and open the cover in the direction indicated by the arrow.

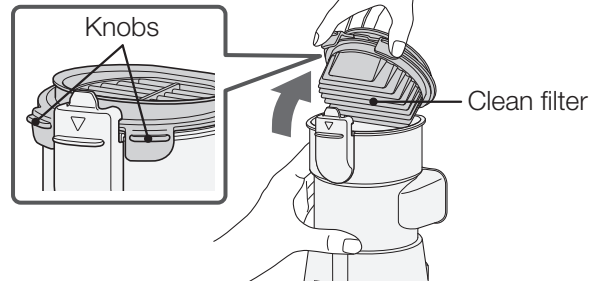

2 Remove dust and debris from the clean filter

1 Detach the clean filter.

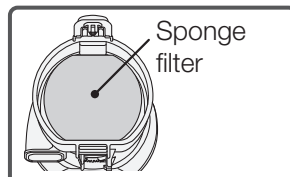

Wash the sponge filter with water if there is dirt on the filter. →(P.E-21)

Note

Be sure to attach the sponge filter after emptying the dust case or cleaning the filters.

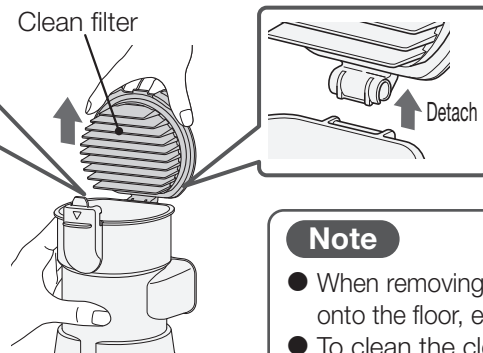

2 Remove attached dust and debris by using the maintenance brush.

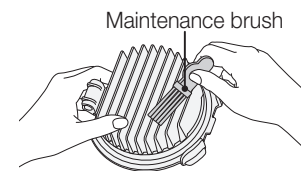

Note

- When removing dust and debris, do not slap the clean filter onto the floor, etc. Failure to do so might cause damage.
- To clean the clean filter, use the maintenance brush that was provided with the vacuum cleaner.

Perform maintenance (wash with water) when you are concerned about dirt or the suction power is weak. →(P.E-21)

3 Attach the clean filter.

Attach the clean filter in the reverse order of removal.

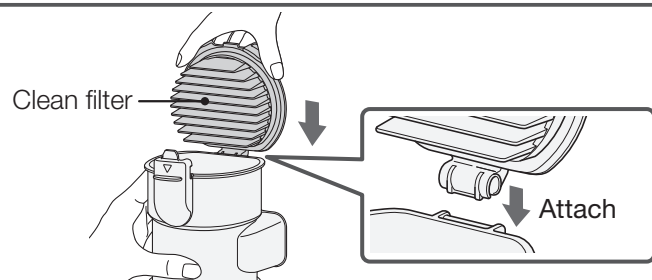

4 Close the clean filter.

Press firmly until you hear a "click" sound.

Note

Make sure the sponge filter is attached.

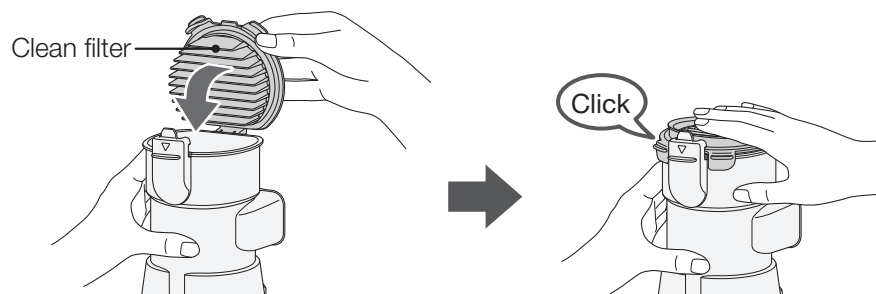

Inner cylinder filter

1 Open the dust case lid →(P.E-17) and remove the inner cylinder filter.

- 1 Turn the inner cylinder filter in the Unlock direction as far as it will go.
- 2 Lift the inner cylinder filter straight up.

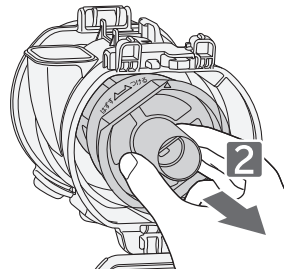
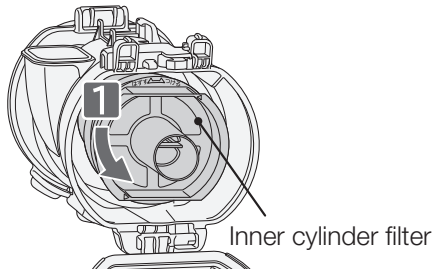

Note

Dust and debris might spill when you remove the inner cylinder filter. To catch the dust and debris, spread newspaper on the ground before you remove the inner cylinder filter.

2 Remove dust and debris from the inner cylinder filter.

You can easily remove dust and debris caught in the inner cylinder filter by sliding the maintenance brush in the direction indicated by the arrow.

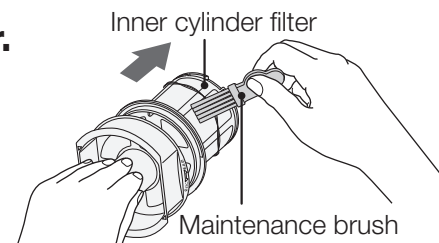

3 Attach the inner cylinder filter and close the dust case lid. →(P.E-17)

- 1 Match the inner cylinder filter with the center of the dust case.
- 2 Push the inner cylinder filter down and turn the inner cylinder filter in the Lock direction until you hear a click.

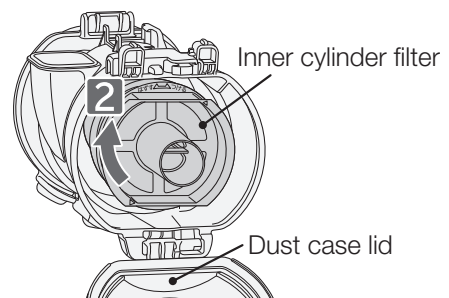
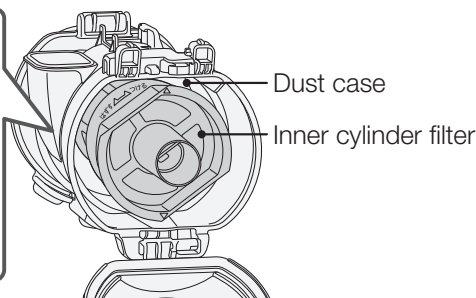
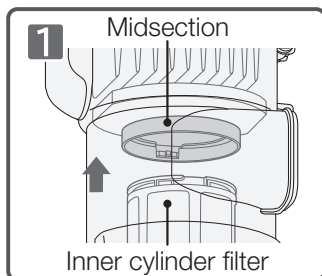

Note If the filter is not securely attached, it might fall when you empty the dust case. Similarly, if you use the vacuum cleaner without securely attaching the filter, strange sounds might come from around the filter.

4 Attach the maintenance brush to the back side of the dust case.

- 1 Attach the maintenance brush to the hook of the dust case.
- 2 Firmly attach the knob of the maintenance brush until you hear a "click" sound.

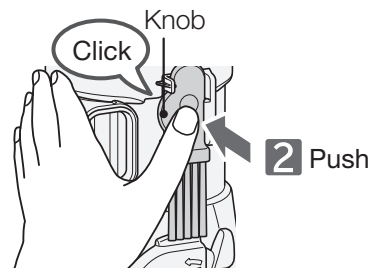
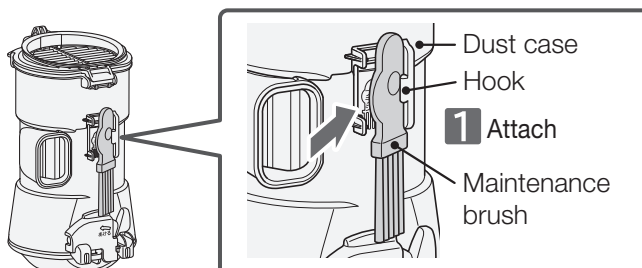

Note If the vacuum cleaner is started without the maintenance brush attached to the back side of the dust case equipped on the vacuum cleaner, the brush might become detached. Securely attach the maintenance brush to the back side of the dust case.

Emptying the dust case and cleaning the filters (continued)

Attaching the dust case

Attach the dust case

1 Hook the grooves (two places) of the dust case on the protrusions (two places) of the vacuum cleaner.

2 Firmly attach the dust case until you hear a "click" sound.

Hold the vacuum cleaner in the positions shown in the figure. It might be difficult to install the vacuum cleaner if you hold other parts of it.

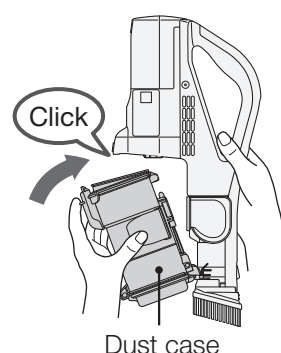
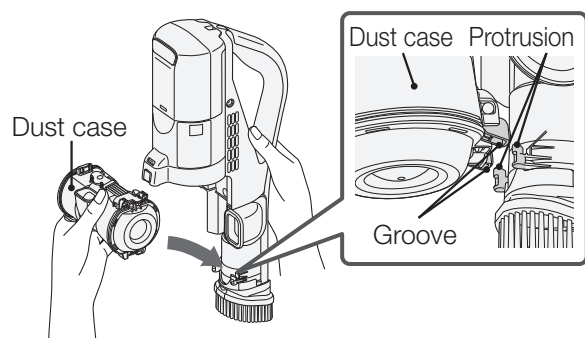

Maintenance

To clean with high suction power, we recommend performing frequent maintenance.

Vacuum cleaner, attachments, attachment accessories

Perform maintenance when you are concerned about dirt.

Moisten a soft cloth and then wring it out thoroughly.

WARNING

Risk of eruption, fire, electric shock, or injury.

- When cleaning the vacuum cleaner and the AC adapter, disconnect the connector of the AC adapter from the vacuum cleaner, and unplug the plug from the outlet.
- When maintaining the vacuum cleaner, remove the connector from the vacuum cleaner.
- Do not use flammable objects, combustibles (thinner, benzene), etc.

CAUTION

Risk of injury

Before performing maintenance on the vacuum cleaner, make sure the vacuum cleaner is turned off.

Note

Do not use alcohol, cleansers, chemical dust and debris cloths, etc. They might cause cracks or discoloration.

Terminals on the AC adapter

Disconnect the AC adapter from the outlet, and use a soft, dry cloth to wipe the terminals of the connector.

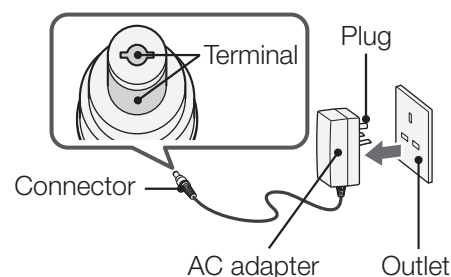

Washable Parts

The handy brush →(P.E-14), crevice nozzle/broom brush →(P.E-15), clean filter →(P.E-21), sponge filter →(P.E-21), inner cylinder filter/dust case →(P.E-22), and rotary brush →(P.E-24) are washable. Do not wash any other attachments or parts with water.

After washing the parts with water, allow it to dry thoroughly in the shade before using it.

About 24 hours is required for the clean filter, sponge filter and rotary brush to dry.

(The drying time varies depending on the environment and season.)

Note During maintenance, fine dust and debris might disperse into the air. Perform maintenance in a wellventilated environment (for example, outdoors) or wear a mask to avoid breathing in the dust and debris.

Maintaining (washing with water) the filters

Wash the filters with water, if the filter indicator blinks in red or the vacuum cleaner's suction power is weak.

Clean filter, sponge filter

1 Wash the filters with water by using the maintenance brush.

- Gently remove any attached dust and debris from the filters before washing them with water.
- Detach and then wash the clean filter with water.
→(P.E-18, E-21)
- When washing the clean filter with water, thoroughly remove any dust and debris stuck in its folds.

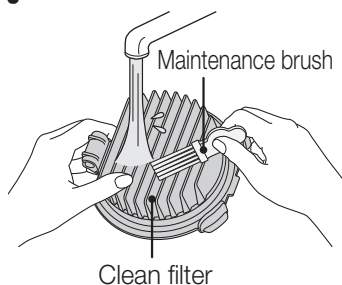

CAUTION

Risk of injury

You might have unintentionally vacuumed sharp objects such as glass shards or pins. Be careful when performing maintenance.

Note

To clean the clean filter, use the maintenance brush that was provided with the vacuum cleaner.

2 To wash the sponge filter, gently squeeze the sponge filter while holding it under running water.

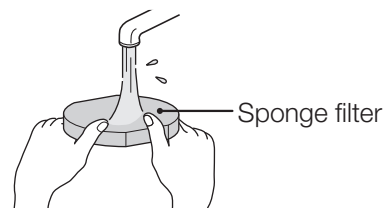

3 Air dry the filters.

- Air dry thoroughly in the shade. Drying the clean filter and sponge filter requires about 24 hours. (The drying time varies depending on the environment and season.)
- Also, do not dry it with hot air such as that from a hair dryer. Doing so might cause a performance degrade, damage, or deformation.

4 Attach the sponge filter.

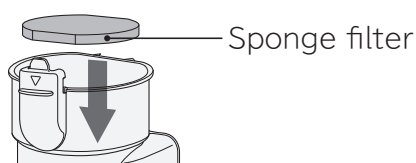

Note

- Be sure to attach the sponge filter. If you do not attach the sponge filter, the clean filter might become clogged after a short period of use or the vacuum cleaner might make strange sounds.
- After washing the filter with water, allow it to thoroughly air dry in the shade before you reassemble it. Do not use them without drying. Doing so might clog the filters soon and cause weak suction power or abnormal odor.

5 Attach the clean filter. →(P.E-18)

Maintenance (continued)

Inner cylinder filter

1 Remove the inner cylinder filter. →(P.E-19)

2 Wash the inner cylinder filter and dust case with water.

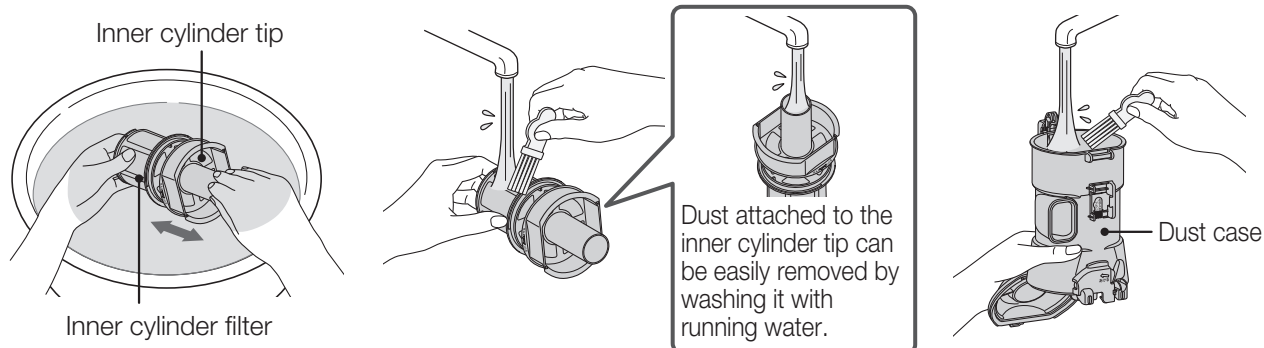

Move the inner cylinder tip in the direction of the arrow and wash with water.

- Note**
- Gently remove any attached dust and debris from the filters before washing them with water.
 - Drain the water attached to the inner cylinder filter thoroughly after washing.

3 Air dry the filter.

- After washing the filter with water, allow it to thoroughly air dry in the shade before you reassemble it. Do not use it without drying. Doing so might clog the filters soon and cause weak suction power or abnormal odor.
- Also, do not dry it with hot air such as that from a hair dryer. Doing so might cause a performance degrade, damage, or deformation.

4 Attach the inner cylinder filter. →(P.E-19)



CAUTION

Risk of damage to the vacuum cleaner

Attach the dust case and filters before operation.

If any dust and debris enters the motor, the filter inside the vacuum cleaner might be clogged and strange sounds might come from the vacuum cleaner.

In this case, please consult a Hitachi authorized service agent.

Note

If the suction power is weak even after washing the filters with water, the clean filter, sponge filter, etc. might be worn.

To request replacement, please contact a Hitachi authorized service agent.

Cleaning the power head

- Perform maintenance when suction power is weak or when dirt becomes a concern.
- We recommend periodic maintenance (about once a month).

Dust and debris stuck to the safety switch, rotary brush, brushes, wheels, air inlet, and rotating sections might cause damage to the floor, reductions in suction power, or malfunctions.



CAUTION

Risk of injury

Before performing maintenance, detach the power head from the vacuum cleaner or extension pipe.

Remove attached dust and debris

Remove the attached dust and debris by using the crevice nozzle or other tools.

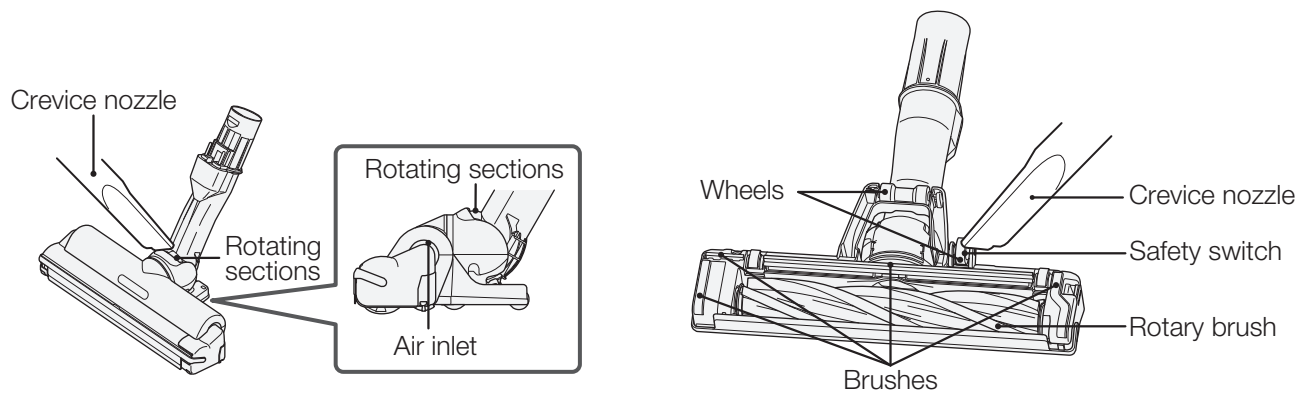

Remove tangled dust and debris

Remove any dust and debris by using tweezers or other tools.

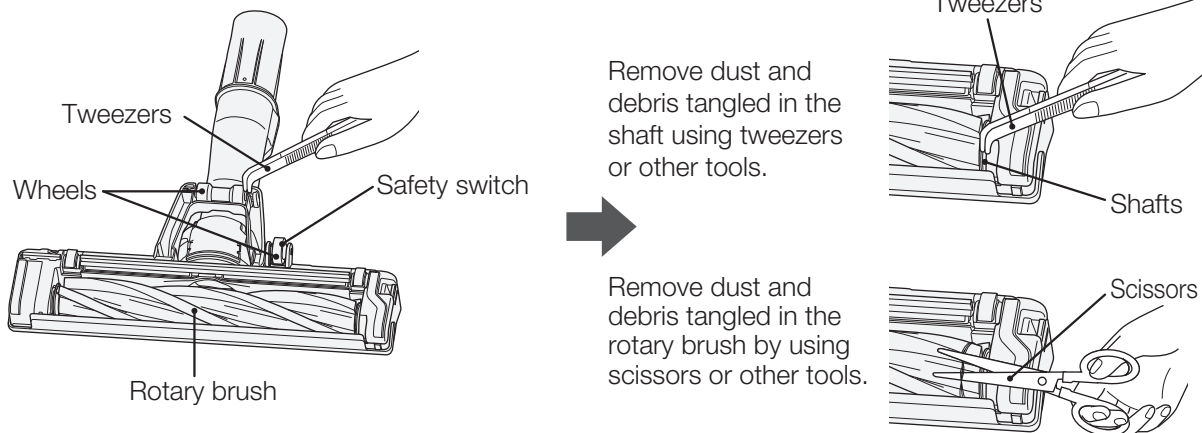

Remove dust and debris tangled in the shaft using tweezers or other tools.

Remove dust and debris tangled in the rotary brush by using scissors or other tools.



CAUTION

Risk of malfunction or damage to the floor

- If dust and debris get tangled in the wheels, the wheels cannot rotate, which might cause malfunction, wear, or floor damage.
- After extended use, the brushes, wheels, and rotary brush might wear down. Using the power head while they are worn out might damage the floor. You cannot replace the brushes or wheels by yourself. Please contact a Hitachi authorized service agent to have the brushes, wheels, and rotary brush replaced as a set. The rotary brush can be purchased as a replacement part. →(P.E-30)

Note

Do not subject the safety switch to excessive force. Failure to do so might cause damage.

Cleaning the power head (Continued)

Rotary brush maintenance.

1

Remove the brush holder.

Turn the power head over and remove the brush holder while pushing the tab in the direction of the arrow.

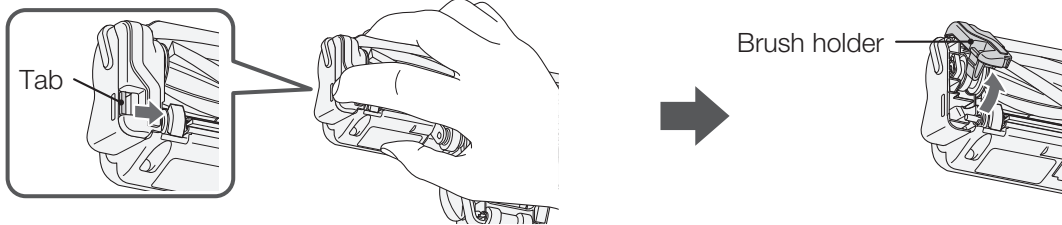

2

Detach the rotary brush and remove dust.

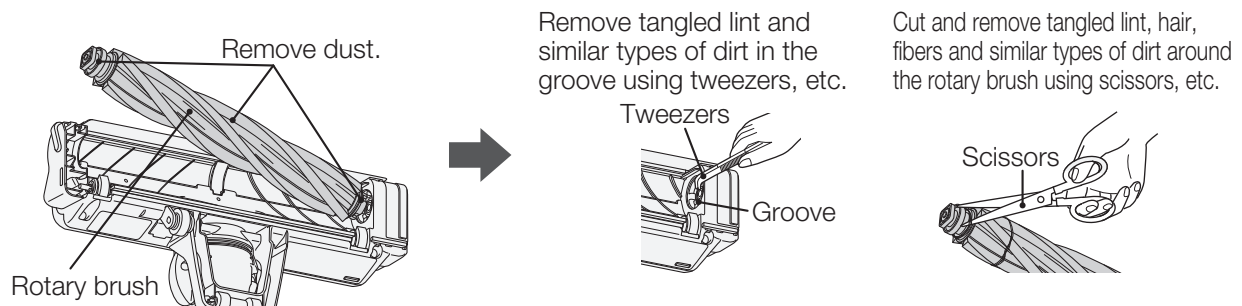

Washing the rotary brush with water

- 1** Wash it with water.
- 2** Shake to remove excessive water.
- 3** Thoroughly air dry.

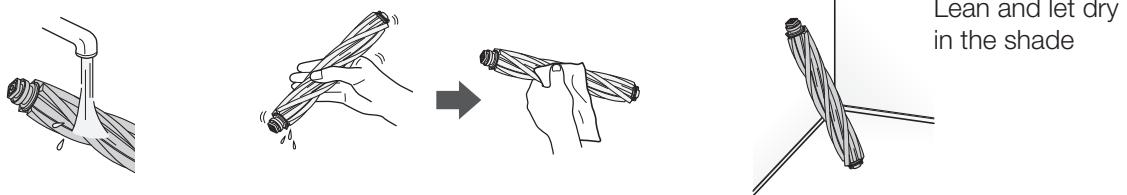

Note

- Do not use cleansers, bleach, etc. Doing so might cause discoloration, deformation, etc.
- After washing with water, thoroughly air dry it in the shade before attaching it. Drying it requires approx. 24 hours. (The drying time varies depending on the environment and season.)

3

Adjust the rotary brush with the groove and attach it to its original position.

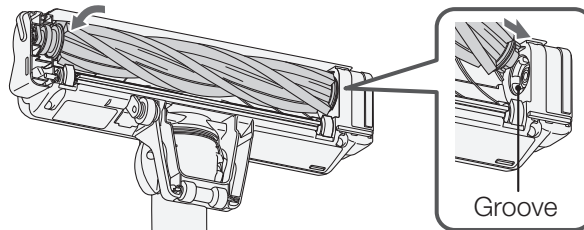

4

Attach the brush holder.

- 1** Insert the hook
- 2** Firmly attach the brush holder until you hear a click.

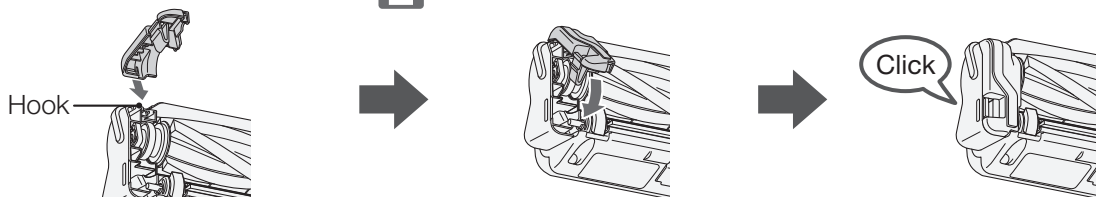

Note

When attaching the brush holder, fasten the hook first. Failure to do so might cause damage.



Troubleshooting

Before requesting for repair

Check the following points again.

The vacuum cleaner does not operate, or stops while the vacuum cleaner is running. The suction power is weak. The rotary brush does not rotate.

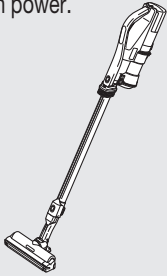
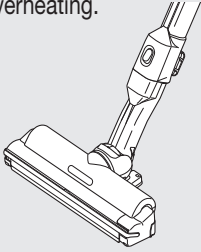
The safeguard might be operating. Release the safeguard with the following instructions.

Safeguard and cause	Suction power of the vacuum cleaner becomes weak or stops while the vacuum cleaner is running.	The rotary brush of the power head stops.
	<p>To prevent the vacuum motor or the battery from overheating, the vacuum cleaner might sometimes automatically enter safe mode, in which the vacuum cleaner runs with less electricity and reduced suction power.</p> 	<p>If the vacuum cleaner is continuously operated in a state where there is a lot of resistance to the rotary brush, the rotation of the rotary brush stops automatically to prevent the motor from overheating.</p> 
	<p>The filter indicator is blinking (about once per second).</p> <p>The battery indicator is blinking slowly (about once every 4 seconds).</p>	
	<p>Dust clogged in clean filter or sponge filter → Go to ①</p> <p>Operation while blocking the inlet → Go to ②</p> <p>The battery is hot. → Go to ③</p> <p>The vacuum cleaner motor is hot. → Go to ③</p>	<p>Foreign matter stuck → Go to ④</p> <p>Power head pressed against floor or carpet → Go to ⑤</p>
Instructions	Press the  button of the vacuum cleaner to stop operation.	
	<p>①</p> <p>Empty the dust case or maintain the dust case or filters. →(P.E-16 to E-22)</p>	<p>②</p> <p>Remove the object that is blocking the inlet.</p>
	<p>④</p> <p>Remove the foreign substance from the rotary brush. →(P.E-23, E-24)</p>	<p>⑤</p> <p>Do not press the power head against the floor or carpet.</p>

The safeguard is released after 5 to 60 minutes, and you can use the cleaner as usual.

Cleaning the power head

Troubleshooting

Troubleshooting (continued)

Other problems

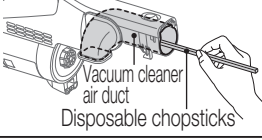
Problem	Things to check	Instructions	Page
Suction power becomes weak or stops while the vacuum cleaner is running.	The battery level is low. (The battery indicator lamp flashes (approximately once every second).)	Charge the battery.	P.E-10
	Is the exhaust abnormally hot?	Press the "Power Off" button to stop operation, wait for the vacuum cleaner to cool down, and then start operation again.	-
	Is the battery indicator blinking slowly (about once per four seconds)?		P.E-25
	When continuously operating on "High" in places of high temperature, such as under direct sunlight or in cars exposed to the sun, the safeguard might operate and the suction power might become weak to prevent the vacuum cleaner motor and battery from overheating. Also, the battery indicator blinks slowly.		
Suction power stops while the vacuum cleaner is running. (Filter indicator is blinking.) The operation sound increased.	Is the dust case full of dust and debris?	Empty the dust case.	P.E-16 P.E-17
	Is dust and debris stuck in the filters?	Perform maintenance for (wash with water) each filter.	P.E-18, E-19 P.E-21, E-22
	Is dust and debris clogging the vacuum cleaner air duct?	Remove the dust and debris using disposable chopsticks, etc. 	-
	Is dust and debris clogging the power head?	Remove the dust and debris.	P.E-23 P.E-24
	Did you use the vacuum cleaner to clean up fine sand or dust and debris?	Empty the dust case and perform maintenance for (wash with water) each filter.	P.E-16 to E-19 P.E-21, E-22
The filter indicator does not blink while the vacuum cleaner is being operated.	This is not a problem because this lamp is not supposed to blink while the vacuum cleaner is being operated in the Standard setting.		-
The vacuum cleaner does not operate, or stops while it is running.	Is the remaining battery level low? [Battery indicator blinks (about once per second)]	Charge the battery.	P.E-10
	Is the cleaner being charged?	Disconnect the AC adapter.	-
The Turbo setting cannot be used.	Is the remaining battery level low?	Charge the battery.	P.E-10
	Is dust and debris stuck in the filters?	Empty the dust case and perform maintenance for (wash with water) each filter.	P.E-16 to E-19 P.E-21, E-22
Operating time is short even after charging.	Is the room temperature lower than 5 °C or higher than 34 °C?	Use the vacuum cleaner where the ambient temperature is between 5°C to 34°C. The operation time may be shorter or the charging time may be longer.	P.E-8 P.E-11 P.E-12
	Are you using the vacuum cleaner in a cold place?	Leave the vacuum cleaner in an area where the ambient temperature is between 5 °C and 34 °C. Wait for the vacuum cleaner to warm up, and then try again.	P.E-8, E-11 P.E-12
	Did you leave the vacuum cleaner unattended for a long period of time without charging it?	The battery capacity might be temporarily recovering poorly. Repeat the procedure of using the cleaner until the battery is exhausted and charging fully about 2 to 3 times.	P.E-11
	Is the battery exhausted?	If the vacuum cleaner stops running after a short time even though it is fully charged and the filters are clean (wash with water), you might need to replace the battery. Please consult with a Hitachi authorized service agent.	P.E-16 to E-19 P.E-21, E-22
The exhaust or vacuum cleaner gets warm (while the vacuum cleaner is in operation).	This is normal. Motor will be cooled via air flow.		-
The vacuum cleaner or AC adapter gets warm (during charging).	It gets warm due to the flow of electrical current to the control circuit, which is normal.		-

Problem	Things to check	Instructions	Page
The exhaust smells strange.	Is dust and debris stuck in the filters?	Perform maintenance for (wash with water) each filter.	P.E-21
	Are the filters thoroughly dried after washing with water?	After washing the filters with water, air dry them thoroughly in the shade.	P.E-22
There are abnormal sounds coming from around the dust case.	Are the dust case, inner cylinder filter, and clean filter securely attached?	Securely attach them.	P.E-18 to E-20
	Is dust and debris clogging the vacuum cleaner air duct?	Remove the dust and debris using disposable chopsticks, etc.	-
Dust and debris of the dust case does not rotate.	Dust and debris might not rotate depending on the type of dust and debris and how it accumulates, which is normal.		-
Dust and debris spills out of the vacuum cleaner when the dust case is removed.	Has the dust and debris in the dust case exceeded the dust and debris Max line?	Dispose of the dust and debris before it reaches the dust and debris Max line.	P.E-16 P.E-17
	Has the dust and debris in the dust case exceeded the dust and debris Max line?	Dispose of the dust and debris before it reaches the dust and debris Max line.	P.E-16 P.E-17
Dust and debris spills out when attachments are removed.	If operation is stopped while the vacuum cleaner is running facing upwards, dust and debris might remain in the vacuum cleaner air duct. Stop operation while the vacuum cleaner is facing downwards.		-
The rotary brush of the power head stops or rotates poorly.	Is the remaining battery level low? [Battery indicator blinks (about once per second)]	Charge the battery.	P.E-10
	Is the power head securely attached?	Securely attach it.	P.E-2
	Is the power head not touching the floor?	The vacuum cleaner is designed to stop operating when lifted from the floor. Place the power head on the floor.	P.E-13 P.E-14
	Is dust and debris stuck to the rotary brush, safety switch, etc.?	Remove the dust and debris.	P.E-23 P.E-24
	Is there foreign matter stuck in it?	The safeguard is operating. Remove the foreign matter, and wait a while before restarting.	P.E-25
	Is it firmly pressed against the floor or carpet?	The safeguard is operating. Wait a while before restarting.	
The rotary brush of the power head does not rotate.	The safeguard is operating. Wait a while before restarting.		P.E-25
The LED light is dim.	Is the remaining battery level low?	Charge the battery.	P.E-10
There is a clattering sound coming from the power head.	The safety switch is designed to produce the sound. This does not indicate a problem with the vacuum cleaner.		-
The battery indicator lamp does not turn on when the vacuum cleaner is charged	Is the AC adapter firmly plugged into the outlet?	Firmly plug in the adapter.	P.E-10
	Is the connector of the AC adapter firmly inserted into the vacuum cleaner?	Firmly insert the connector.	
	Is the battery fully charged?	When fully charged, the battery indicator turns off.	
	Are the terminals on the AC adapter or vacuum cleaner dirty?	Unplug the AC adapter and remove the dust and debris on the terminals with a dry cloth.	P.E-20
	Has the vacuum cleaner not been in use for a long time? If it has not been charged for a long time, the battery might need to be replaced as its performance and battery life might already have deteriorated. Please consult with a Hitachi authorized service agent.		

Troubleshooting (continued)

Problem	Things to check	Instructions	Page
The battery indicator blinks while charging (about twice per second).	Are you using the AC adapter that was provided with the vacuum cleaner?	Do not use an AC adapter other than the one that was provided with the vacuum cleaner.	P.E-10
	Either the battery is consumed, or the battery or AC adapter is damaged. Please contact the store where you purchased the product or a Hitachi authorized service agent.		-
	Is the room temperature between 5°C to 34°C.	Recharge where the room temperature is between 5°C to 34°C.	P.E-11
The battery indicator blinks quickly during operation (about twice per second).	This indicates that either the battery is consumed, the battery is damaged, or the vacuum cleaner is damaged. Please contact the store where you purchased the product or a Hitachi authorized service agent.		-
The battery indicator blinks slowly (about once per four seconds).	This indicates that the safeguard is operating to prevent the vacuum cleaner motor and battery from overheating.	Wait for the vacuum cleaner to cool down, and then start operation again.	P.E-25
It takes a long time to charge.	Did the vacuum cleaner not heat up when the connector of the AC adapter was inserted into the terminal of the vacuum cleaner?	The safeguard is operating, which is normal. When fully charged, the battery indicator turns off.	P.E-9 to E-11
	Is the room temperature lower than 5°C or higher than 34°C?	Charge in areas where the room temperature is between 5°C to 34°C.	P.E-8 P.E-11
	Charging time of battery might be longer according to the usage environment and conditions such as the ambient temperature and how long the vacuum cleaner was in use.		P.E-11
	If the battery indicator remains lit even after the battery has been charged for over 7 hours, the device might be damaged. Please consult with a Hitachi authorized service agent.		-
If the problem persists		Do not attempt to repair it yourself. Please consult a Hitachi authorized service agent.	-

Replacing the battery

The battery is a consumable part. The battery capacity will gradually decrease with repeated use. If the usage time of the battery becomes short even when it has been correctly charged, the life of the battery has reached its end. Please replace the battery. If you want to replace the battery without disposing of the unit due to expiration of the battery life or other reason, consult a Hitachi authorized service agent.

We will replace parts at your request. The customer will bear labor costs in addition to the cost of parts.

Disposing of the vacuum cleaner



- Do not connect the battery to anything other than this vacuum cleaner. Do not disassemble, modify, or solder the battery. Do not charge the battery when it is not connected to the vacuum cleaner.
Replacement of the battery is only to be performed by a trained service technician. Failure to heed this warning might cause the battery to leak, generate heat, rupture, smoke, fire, electric shock, or injury.
- Do not attempt to use a vacuum cleaner (whose screws have been removed, etc.) from which you attempted to remove a battery.
- Do not detach the battery while the vacuum cleaner is in operation.
Failure to heed this warning might cause smoke, fire, electric shock, or injury.

To prevent damage to property and personal injury, please thoroughly read the Safety precautions →(P.E-4 to E-8) and dispose of the product correctly.

Recycling the battery (when disposing of the product)

This product uses a lithium-ion battery.
Lithium-ion batteries are a valuable, recyclable resource.

 Li-ion 20	<p>To dispose of the vacuum cleaner, detach the battery according to the following procedure, and then bring the vacuum cleaner to a Hitachi authorized service agent or one of our recycling partner stores. Alternatively, ask local authorities about the proper method of disposing of the vacuum cleaner, and follow your local recycling regulations. *Recycling rules might vary depending on the local authorities.</p>
---	---

Detaching the battery (when disposing of the product)

Prepare the tools listed on the right, and follow the procedure to detach the battery.

Tools to prepare: Phillips screwdriver, wire cutters, and vinyl tape

1 Use the vacuum cleaner until the battery is completely flat and the vacuum cleaner can no longer operate.

WARNING Risk of electric shock or injury
If the battery is not completely flat, the motor might start running while the battery is being removed.

2 Removing the dust case →(P.E-17), the extension pipe, and the power head →(P.E-2).

3 Detach the battery (when disposing of the product).

1 Using a Phillips-head screwdriver, remove one screw securing the battery.

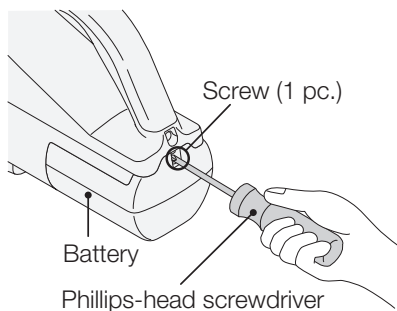

2 Pull out the battery, cut the orange lead wire connecting the battery to the vacuum cleaner approximately 2cm away from the battery using a wire cutter, and insulate it by wrapping it with vinyl tape.

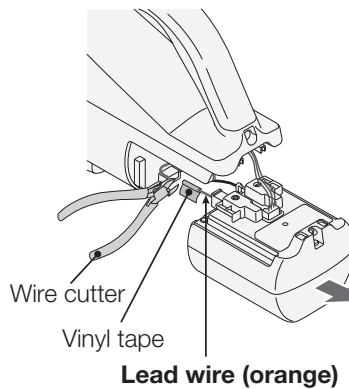



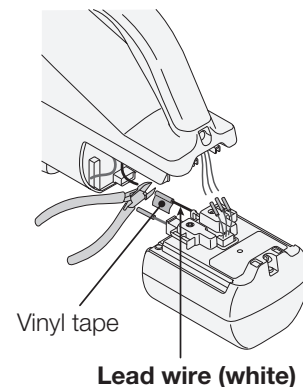



3 Cut the remaining lead wires approximately 2cm away from the battery one at a time using a wire cutter, and insulate them one by one by wrapping them with vinyl tape.

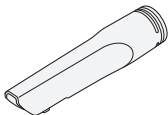
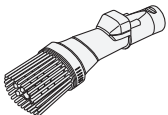
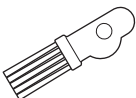

WARNING Risk of fire, electric shock, or injury

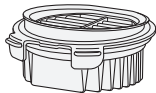
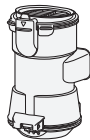
- Do not press the control buttons when detaching the battery. Otherwise, the motor starts.
- When cutting the lead wires, cut them one by one separately.
- Keep the battery away from children. Failure to do so might cause an electric shock or injury.

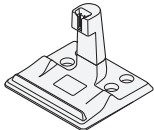
Replacement parts

Crevice nozzle	Broom brush	Maintenance brush	Sponge filter	Clean filter
 Service parts PV-BC500-043	 Service parts PV-BEH900-033	 Service parts PV-BHL1000J1-004	 Service parts PV-BJ700G-014	 Service parts PV-BJ700G-013
Dust case (with each filter)	Rotary brush	Vacuum cleaner stand	Inner cylinder filter	
 Service parts PV-XL300J-903	 Service parts PV-BFL1-020	 Service parts PV-XL300JT-909	 Service parts PV-BL20G-009	

● Since batteries are consumables, they will only be available for a charge.

Specifications

Product name		Cordless Stick Vacuum Cleaner			
Model		PV-XL300J			
Vacuum cleaner	Rated voltage	DC18.0V	AC adapter	Input	AC220-240V 50-60Hz 0.3A
	Nominal capacity	2.1Ah		Output	DC21.5V 0.9A
	Dust collection capacity	0.15L		Charge time	About 3.5 hours (Varies depending on factors such as the ambient temperature and how long the vacuum cleaner was in use)
	Battery	Lithium-ion battery (5 cells)		Cord length	1.6m
	Continuous operating time*	High: Approx. 8 minutes Standard: Approx. 30 minutes (with the power head) (At full charge, new battery, 20 °C) Standard: Approx. 45 minutes (without the power head) (At full charge, new battery, 20 °C) Turbo: Approx. 5 seconds			
	Dimensions	Stick cleaner (L x W x H)	205mm x 230mm x 994mm	Weight	Stick cleaner
Handy cleaner (L x W x H)		321mm x 90mm x 172mm	Handy cleaner		0.8kg
Attachments		Power head..... 1 pc. Extension pipe..... 1 pc. AC adapter (PVA-EX02-BS)..... 1 pc.	Vacuum cleaner stand (stand)..... 1 pc. Vacuum cleaner stand (base)..... 1 pc.		
Attachment accessories		Maintenance brush..... 1 pc. Handy brush..... 1 pc.	Crevice nozzle 1 pc. Broom brush 1 pc.		

* Operating time varies depending on the conditions such as ambient temperatures.



HITACHI

Inspire the Next